

LANDLORD AREA

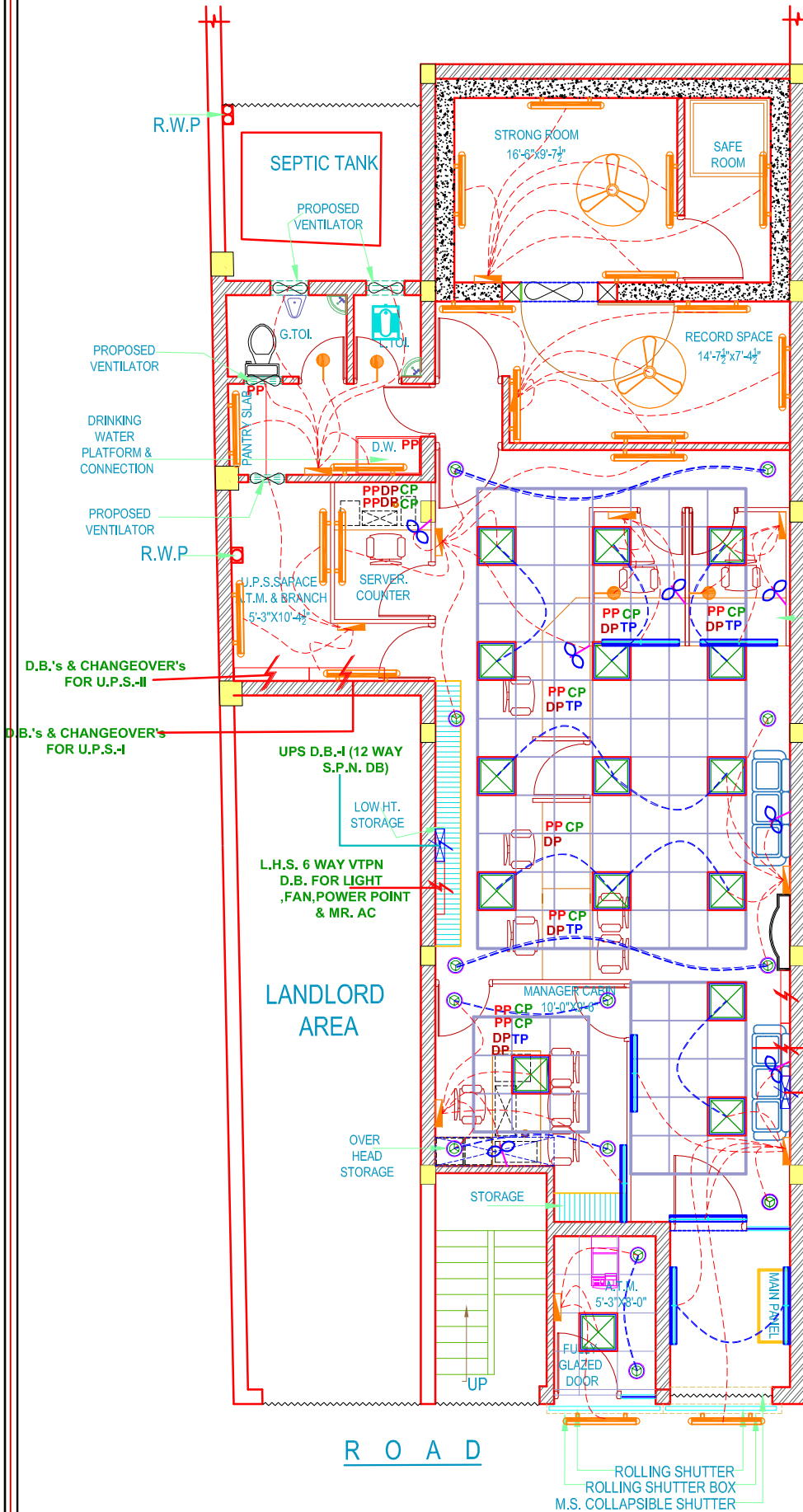

R.H.S. 4 WAY VTPN
D.B. FOR LIGHT FAN
& POWER POINT

4 WAY TPN DB
FOR A.C.

UPS DB-II (8 WAY
S.P.N. DB)

HEAD
CASHIER

LEGEND

S.NO	TYPE	DESCRIPTION
1		2'X2' LIGHT
2		DOWNLIGHTER
3		L.E.D. BATTEN
4		TUBELIGHT
5		WALL MOUNTED FAN
6		CEILING FAN
7		EXHAUST FAN
8		LED BULB
9		16 AMP. RAW POWER POINT
10		COMPUTER UPS BOARD
11		DATA POINT
12		TELEPHONE POINT
13		SWITCH BOARD
14		S.P.N. D.B.
15		V.T.P.N. D.B.
16		PRIMARY POINT WIRING
17		SECONDARY POINT WIRING

DRG. TITLE:-

ELECTRICAL LAYOUT FOR
INDIAN BANK BRANCH
AT, SHIVPURI ROAD, NANDAPURA
SHIPRI BAZAR JHANSI.

Drng. Title

ELECTRICAL PLAN

North



Date

NOV - 2017

Drawn By

RUPALI KUMARI

GUNJAN & ASSOCIATES

ARCHITECTS, ENGINEERS, INTERIOR
AND LANDSCAPE DESIGNERS.
141, SAINIK NAGAR, LANE NO-9 RAEBARELI
ROAD LUCKNOW-226002
Phone: +91 9839018489, 9838818489
E-mail: studio@gunjanandassociates.com
E-mail: arunjan@yahoo.com
URL: www.gunjanandassociates.com