

# OPTION:-02

TOTAL INTERNAL BRANCH AREA = 1519.00 sq.ft.(Approximate)  
 TOTAL CARPET AREA BRANCH AREA = 1363.00 sq.ft.(Approximate)  
 TOTAL ATM CARPET AREA BRANCH AREA = 55.00 sq.ft.(Approximate)  
 TOTAL CARPET AREA (BRANCH+ATM) AREA = 1418.00 sq.ft.(Approximate)

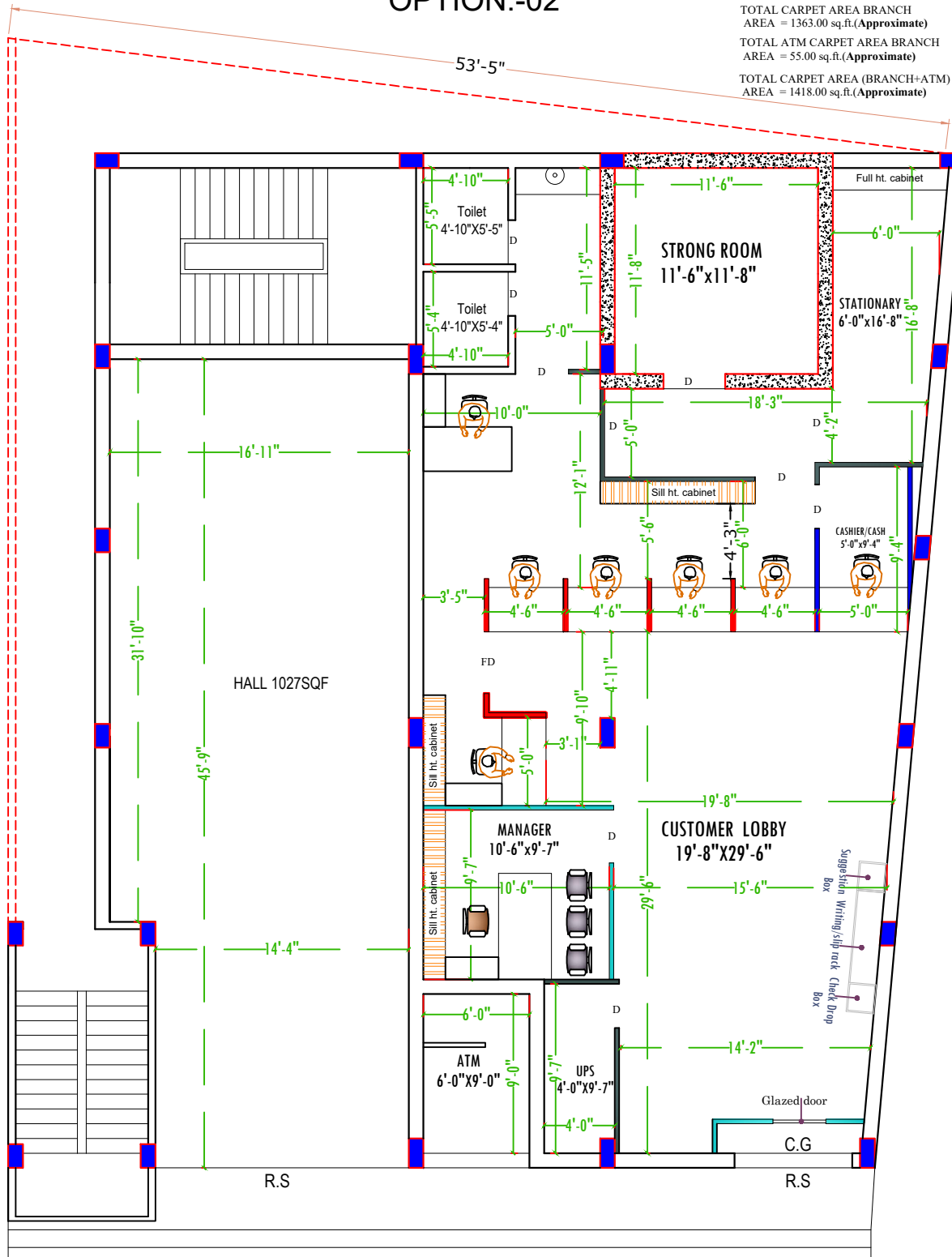

## GROUND FLOOR PLAN



R O A D

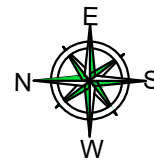

NOTE	PROJECT:-  PROPOSED INTERIOR LAYOUT OF INDIAN BANK  AT-MOHANIA BRANCH	REVISION:-		Sheet title :- <b>FURNITURE LAYOUT PLAN</b>		
		Date :- 28/08/2024	Issues Rev:-01	Scale :- N.T.S	Date :- 23/08/2024	Drawn by :- RAHUL SINGH
<ul style="list-style-type: none"> <li><span style="display: inline-block; width: 15px; height: 15px; background-color: red; border: 1px solid black; margin-right: 5px;"></span> HALF HT PARTITION</li> <li><span style="display: inline-block; width: 15px; height: 15px; background-color: cyan; border: 1px solid black; margin-right: 5px;"></span> SEMI GLAZED FULL HT PARTITION</li> <li><span style="display: inline-block; width: 15px; height: 15px; background-color: gray; border: 1px solid black; margin-right: 5px;"></span> SOLID FULL HT PARTITION</li> <li><span style="display: inline-block; width: 15px; height: 15px; background-color: blue; border: 1px solid black; margin-right: 5px;"></span> 7' HT PARTITION</li> </ul>		Architects :- <b>ARTCON DESIGN CONSULTANTS</b>		ARCHITECTS - ENGINEERS INTERIOR DESIGNERS COMPUTER AIDED DESIGN G-04 Laxmi Palace, Mitra Compound, Boring Road, Patna - 800001 +91 9937737771, amikumar73@gmail.com +91 9386717726 artcondesignconsultants.com		