

**PROJECT**

**PROPOSED INTERIOR FURNISHING FOR INDIAN BANK AT PONNAGAR BRANCH**

**NOTE**

- 1) ALL DIMENSIONS ARE IN FEET & INCHES
- 2) DRAWING TO BE READ IN CONJUNCTION WITH DETAILS
- 3) ALL DISCREPANCIES MUST BE BROUGHT TO THE NOTICE OF THE ARCHITECT
- 4) SAMPLE OF FURNITURE TO BE APPROVED BEFORE EXECUTION

**AREA DETAILING**

SAFE ROOM	-	155 SFT
BANKING HALL	-	1155 SFT
ATM	-	115 SFT
<b>TOTAL</b>	<b>-</b>	<b>1425 SFT</b>

**FALSE CELING**

BANKING HALL	-	812 SFT
ATM	-	115 SFT
<b>TOTAL</b>	<b>-</b>	<b>927 SFT</b>

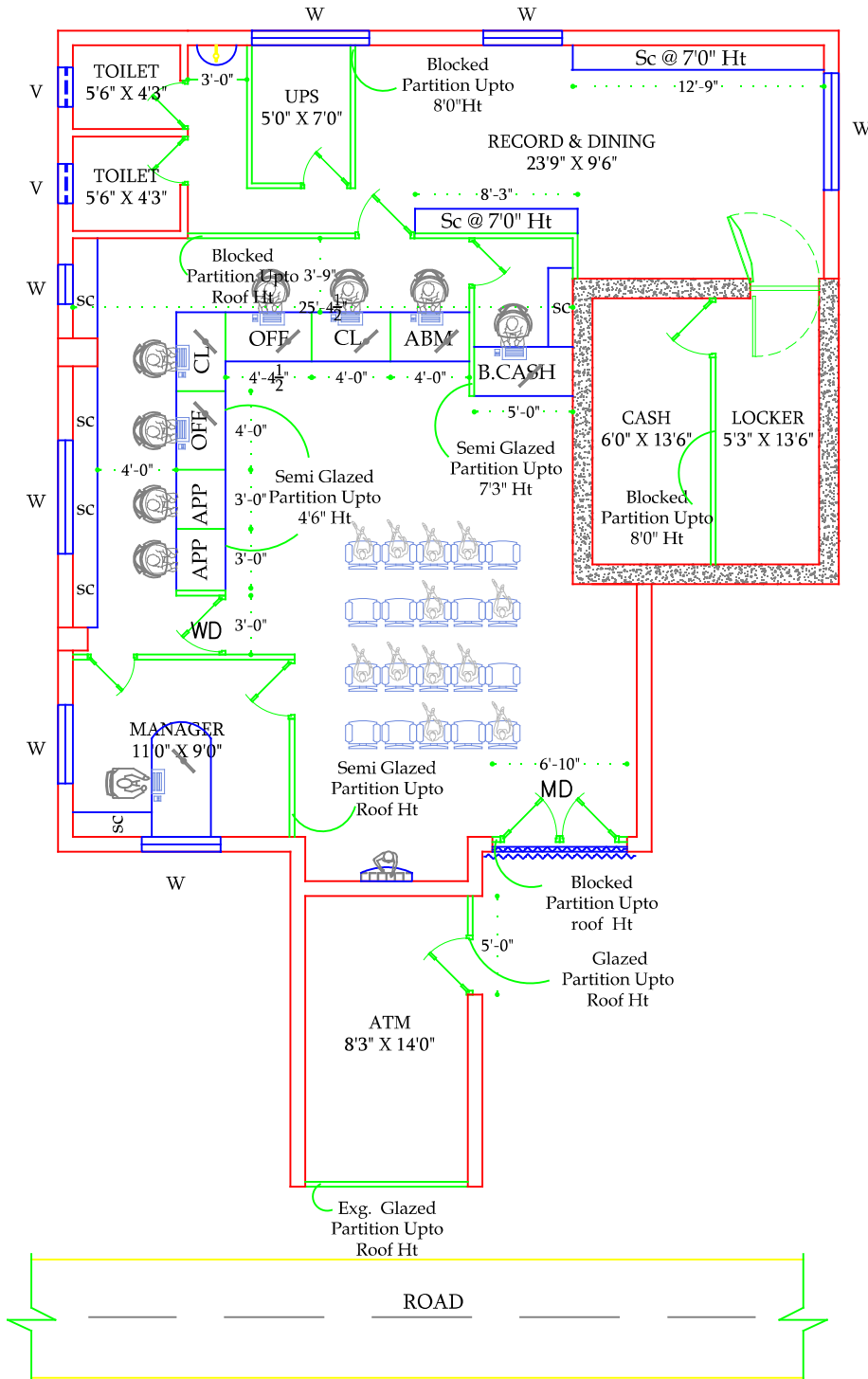

**TITLE**

**WORKING DRAWING**



DRAWN : J.A
SCALE : 1"=8'0"
JOB NO: I26 - 2024
DATE :07.11.2024
SHEET SIZE: A4

**ARCHITECT**

**Dr.T.MAYILVAHANAN, M.E., A.I.I.A., M.C.A., Ph.D.,**



**COS CONSULTANCY SERVICES**  
ARCHITECTURE, INTERIORS, STRUCTURAL  
ENGINEERS & DESIGNERS

6/13, Kamaraj Nagar 4th Street,  
Tallakulam, Madurai - 625002  
Phone : 0452 - 2521869  
Email id : cosquant93@gmail.com