

← 3'-0" → 23'-6" →

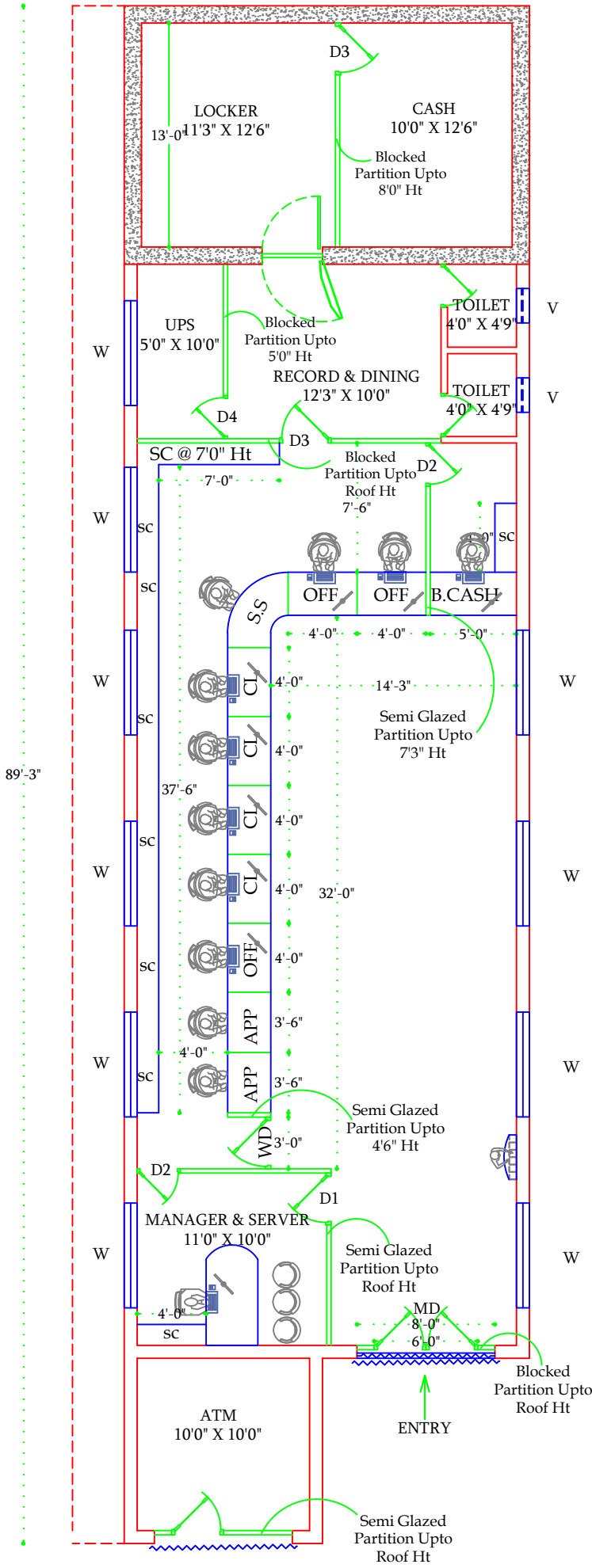

PROJECT

**PROPOSED INTERIOR
FURNISHING FOR
INDIAN BANK
AT GOPALASAMUDRAM
BRANCH**

NOTE

- 1) ALL DIMENSIONS ARE IN FEET & INCHES
- 2) DRAWING TO BE READ IN CONJUNCTION WITH DETAILS
- 3) ALL DESCREANCIES MUST BE BROUGHT TO THE NOTICE OF THE ARCHITECT
- 4) SAMPLE OF FURNITURE TO BE APPROVED BEFORE EXECUTION

AREA DETAILING

BANKING HALL -	1335 SFT
SAFE ROOM -	280 SFT
	<u>1615 SFT</u>

FALSE CELING AREA

BANKING HALL -	1152 SFT
ATM	100 SFT
	<u>1252 SFT</u>

SCHEDULE OF JOINERIES (PROPOSED)

MD	— SEMI GLAZED DOOR	— 5'-0" X 7'-0"
SD	— SAFE ROOM DOOR	— 3'-6" X 7'-0"
D	— SEMI GLAZED DOOR	— 3'-0" X 7'-0"
D1	— SEMI GLAZED DOOR	— 2'-6" X 7'-0"
D2	— SEMI GLAZED DOOR	— 2'-6" X 5'-0"
D3	— FLUSH DOOR	— 3'-0" X 7'-0"
D4	— FLUSH DOOR	— 2'-6" X 5'-0"
WD	— WICKET DOOR	— 3'-0" X 3'-0"
SC	— SIDE CREDENZA	— 2'-6" B

TITLE

WORKING DRAWING



DRAWN : D.J.VIJAY

SCALE : 1"=8'0"

JOB NO: I7-2024

DATE : 29.10.2024

SHEET SIZE: A4

ARCHITECT

Ar. T.MAYILVAHANAN, M.E., A.I.I.A., M.C.A., P.hd.,



COS CONSULTANCY SERVICES

ARCHITECTURE, INTERIORS, STRUCTURAL
ENGINEERS & DESIGNERS

6/13, Kamaraj Nagar 4th Street,

Tallakulam, Madurai - 625002

Phone : 0452 - 2521869

Email id: cosquant93@gmail.com