

HE
GARIB
G
AVANTI

DESIGN CONSULTANTS

#1281, Trichy Road, Coimbatore – 641 018, Tamil Nadu, India.

Voice: 91 422 2301246 Fax: 91 422 2301191

E-mail: agdc.archanand@gmail.com

TENDER FOR INTERIOR FURNISHING

**TENDER FOR INTERIOR FURNISHING, ELECTRICAL,
AND DATA CABLING WORKS**

OF

M/s. INDIAN BANK

FOR MCB BRANCH, AT NAMAKKAL, TAMIL NADU.

ARCHITECTS

**S. VIJAY ANAND., B.Arch., Mem COA., AIIA,
DESIGN CONSULTANTS**

#1281, Trichy Road, Coimbatore – 641 018, Tamil Nadu, India.

Voice: 91 422 2301246 Fax: 91 422 2301191

**ARCHITECTURE PLANNING STRUCTURES
INTERIORS & LANDSCAPE**

**TENDER FOR THE INTERIOR FURNISHING, ELECTRICAL WORKS ,
DATA CABLING AND AIR CONDITIONING WORKS, FOR
M/s. INDIAN BANK, MCB BRANCH, AT NAMAKKAL, TAMILNADU.**

SUMMARY SHEET

Sl. No	Type of Work		Amount
			<u>(Rs.)</u>
I	Interior Furnishing Works - Branch		
1	Interior Works		Rs.
2	Electrical Works		Rs.
3	Total		Rs.
II	Purchase of SFVM Items including Furniture, Furniture fixtures, Electrical fittings and		
4	Furniture and Furniture Fixtures		Rs.
5	Electrical Fittings and Fixtures		Rs.
6	Total		Rs.
7	Data Cabling Works		Rs.
III	TOTAL (3+6+7)		Rs.
	Say		Rs.
	<i>(In words: Rupees</i>		<i>Only)</i>

Notes: All items are excluding of GST and other applicable taxes, unless specified

Notice: TENDERERS MUST VISIT THE SITE AND INSPECT FOR THEMSELVES THE ACTUAL WORKS TO BE CARRIED OUT BEFORE SUBMITTING THE TENDER,

**SCHEDULE FOR THE INTERIOR
FURNISHING WORKS**

AT

**M/s. INDIAN BANK,
MCB BRANCH,
NAMAKKAL, TAMIL NADU.**

TENDER FOR THE INTERIOR WORKS
AT M/s. INDIAN BANK, MCB BRANCH, NAMAKKAL, TAMIL NADU.

S.No	Particulars	Qty.	Unit	Rate (Rs.)	Amount (Rs.)
1	<p>FALSE CEILING (Gypsum Board) Providing and fixing suspended false ceiling, which includes providing and fixing G.I. Perimeter channels of size 0.55mm tk having one flange of 20mm and another flange of 30mm and a web of 27mm along with perimeter of ceiling, screw fixed to brick wall / partition with the help of nylon sleeves and screw at 610 mm centres. Then suspending G.I. Intermediate channels of size 45mm, 0.9mm thick with two flanges of 15mm each from the soffit at 1.22 mts centre to centre with ceiling angle of width 25mm x 10mm x 0.5mm tk fixed to soffit G.I. clean and steel expansion fasteners. Ceiling section of 0.55mm thickness having knurled web of 51.5mm and two flanges 26mm each with clips of 10.5mm are then fixed to the intermediate channel with the help of connecting clips and in direction perpendicular to the intermediate channel at 457mm centre to centre. 12.5mm tapered edge Star Brand / India Gypsum Gypboard (conforming to IS-2095-1982) is then screw fixed to ceiling sections with 25mm dry wall screws at 230mm centres. Screw fixing is done mechanically either with screwdriver or drilling machine with suitable attachment. Finally the boards Properly finished with topcoat as per Architect direction. (This includes painting)</p>				
	a.) BM cabin	95.00	Sft		
	b.) Customer waiting & workstation area	655.00	Sft		
1.1	<p>FALSE CEILING (Armstrong) Providing & fixing in position false ceiling in Armstrong 600 x 600mm x 15/16 mm Dune supreme RH 99 Prima tile with tegular edge frame work as specified by Armstrong co. with suspends wherever required. Making necessary framework for A.C ducting, if any, and necessary cutouts for diffusers and light fittings, taping and finishing to proper line & level, including making grooves and trap doors for A.C unit in 18 mm thick M.R grade plywood with Stainless steel hinges & locks with moulding 1” x 1” for edges including finishing with white plastic emulsion paint etc.complete in all respects. (Note: - Only the plan area will be measured for payment. No payment will be made for cutouts, grooves, mouldings etc.)</p>				
	a.) BM cabin	116.00	Sft		
	b.) Customer waiting & workstation area	676.00	Sft		

S.No	Particulars	Qty.	Unit	Rate (Rs.)	Amount (Rs.)
2	<p>FULL HIGH WOODEN PARTITION (<i>Laminate finish</i>) Fabrication and erection of glazed partition, with use of aluminium sections 2 1/2" x 1 1/2" of size spaced 2'0" x 2'0" both horizontally and vertically in a grid fashion, for a thickness of 3", both sides of the section to be finished with 8mm tk plywood duly treated for termite resistance and finished with 1 mm tk laminate as per direction. All openings are to be strengthened on the edges with additional wooden sections in order to fix glass (float glass). Inclusive of fixed glazing of size 5'6"x 4'0" with 8mm tk glass fixed as per specification. 3" high laminate skirting to be provided.</p>				
	i Up to a height of 9'6" from finished floor level for VC room	440.00	Sft		
	ii Up to a height of 11'0" from finished floor level for back office. (One side mica finish & one side paint finish - architect direction)	480.00	Sft		
3	<p>FULL HIGH WOODEN PARTITION (<i>Paint finish</i>) Providing and fixing in position fully glazed Full Ht Bision Panel / Hilux / V Board Partition comprising of GI floor channels 48 mm x 50 mm & 0.45 mm thk at 4'0" intervals fixed with 8mm tk fiber cement board on both sides & joints filled with joint tape & jointing compound. All openings & doors to be reinforced with GI intermeditate channels of .7mm thk. Both sides finished with putty & emulsion paint of approved shade & colour. Item to include door of size 3'0" x 7'0" with etching and frosting as per design and 2" x 2" aluminium section for door sides and glass sides and T.W door frame to take 8mm thick glass with etching and frosting. Inclusive of fixed glazing of size varying as per site condition with 8mm tk glass fixed as per specification including painting. Skirting to be provided as per architect direction. (Up to a height of 11'0" from FFL)</p>				
	a. Up to a height of 11'0" from finished floor level - back office.	910.00	Sft		
4	<p>GLAZED DOOR Fabrication and fixing of glazed door for cabins using 4" x 2 1/2" country wood frame filled with 8mm glass duly worked (fused pattern) as per the architect design. The door is to be fixed with pivots at top and bottom running on a flat hinge with necessary accessories, fixed on the outer side to be flush with the partition. All hardware locks handle and brass hinges etc for the door to be provided as per the design approved by the architect. Frame to be painted with automotive paint to match that of the partition.</p>				
	Size - 3'0" x 7'0" x 1 Nos, BM & VC room	42.00	Sft		

S.No	Particulars	Qty.	Unit	Rate (Rs.)	Amount (Rs.)
5	NORMAL DOOR Full ht.solid 33mmthk flush door of size as specified fully finished in 1mm laminate of equivalent brand, pattern, provide d with door closer ,edge lipping lock and SS handle all complete including 4" x 3" wooden door frame. Size - 3'0" x 7'0" x 5 Nos	126.00	Sft		
6	ENTRANCE DOOR Fabrication and fixing of front entrance door made of 12mm thick glass (Fused Glass to be worked as per the design). With the help of 6" x 2½" Burma teak sections both on top and bottom. Brushed steel SS pipes worked as handrail per detail. The door is to be fitted with pivot on top and bottom with floor spring Everlite or ISI approved and all accessories etc complete. Size - 6'0" x 7'0" x 1	42.00	Sft		
7	EXTERNAL FIXED GLASS Supplying & fixing of fully glazed partition upto 8'0" ht. 12mm thk float glass with top & bottom section for the same as entrance door etc,, complete ae per architect direction.	165.00	Sft		
8	WALL PANELLING Fabrication & Paneling with 8mm tk branded Bision Panel / Hilux / V Board Partition and finished with 4mm tk OST duly polished / 1mm tk laminate to match the interior décor, as per architect direction.				
a	Wall panelling - BM Cabin	115.00	Sft		

TOTAL AMOUNT

(In words: Rupees

Rs:

Only).

Notes: All items are excluding of GST and other applicable taxes, unless specified

TENDER FOR THE FURNITURE FIXTURES WORKS AT
M/s. INDIAN BANK, MCB BRANCH, NAMAKKAL, TAMIL NADU.

S.No	Particulars	Qty.	Unit	Rate (Rs.)	Amount (Rs.)
1	<p>MANAGER TABLE - MODULAR (<i>with out side credenza</i>) Supplying & fixing of modular manager's table made of 25mm thick water proof plywood duly treated for termite resistant, finished with 1.5mm thick laminate on all outer sides the inner sides are to be finished with 2 coats of putty 1 coat primer and 2 coats of enamel. The table to be provided with drawers, cupboard and a CPU cabinet. The drawers with 12mm plywood are to be fitted with microscopic slide for smoother functioning. The cupboard is to be fixed with box type hinges and locks are to be provided for both with all necessary handles fixtures etc. The CPU cabinet with necessary perforations for ventilation and wiring. Additional drawer for pencils and accessories to be provided. The table top to be pasted with 1.5 mm thick laminates and edges to be finished with teak wood beadings as per specification given by architect. The total work is to be done as per the drawing and the colours etc. to be consulted with the architect.</p> <p>Size: 6'0"x 2'6" (with one set of drawers and cabinets).</p>	1.00	No		
2	<p>OFFICER TABLE - MODULAR (<i>with out side credenza</i>) Supplying & fixing of modular officer's table made of 18mm thick water proof plywood duly treated for termite resistant, finished with 1.5mm thick laminate on all outer sides the inner sides are to be finished with 2 coats of putty 1 coat primer and 2 coats of enamel. The table to be provided with drawers, cupboard and a CPU cabinet. The drawers with 12mm plywood are to be fitted with microscopic slide for smoother functioning. The cupboard is to be fixed with box type hinges and locks are to be provided for both with all necessary handles fixtures etc. The CPU cabinet with necessary perforations for ventilation and wiring. Additional drawer for pencils and accessories to be provided. The table top to be pasted with 1.5 mm thick laminates and edges to be finished with teak wood beadings as per specification given by architect. The total work is to be done as per the drawing and the colours etc. to be consulted with the architect.</p> <p>Size: 4'6"x 2'6" (with one set of drawers and cabinets).</p>	4.00	No		

3 **WORK STATIONS - MODULAR**

Supply & erection of curvilinear modular workstation with partition of 80mm tk tile based system with a frame design to support 3 tiles to give it a symmetrical 3 tile look as well as complete modularity for tile change at any later date. Panel / Slab or tile of 9mm tk Prelam/MDF covered with Fabric, Metallic or Glazed It comprises of 1.6mm tk CRCA frames, which are powder coated in textured finish with 50-60 DFT with impact resistances of 100kg-cm and scratch hardness of 2.5H. Flat trim construction in Aluminium grade 63400 (H39) as per IS:733-1983 with contoured edges for aesthetic look. End-caps in die-cast aluminium with a waterfall edge for a seamless transition from horizontal to vertical trim. Tiles as per options of MDF/Fabric, Metal/Fabric, Powder coated metal (Options of perforated /embossed). Glass - double glazing (Options of clear/ frosted / glass marker), White board, Pin-up, Accessory tile). Over all system width is 80mm for higher wire management. Raceways with internal height of 100mm of CRCA Steel - 18 Gauge/1.2mm of 100mm at skirting level with open bottom to take adequate wires anywhere under the foot print. Optional add on raceways above or below work top for switch board mounting. Tabletop in 25mm tk pre-laminated boards with edge binding or poatforming as per architect direction. Accessories of Tile or mounted accessories, Keyboard options, CPU trolley/CPU hanger, name plates, etc., The above workstation assembly unit is inclusive of three drawers pedestal storage unit mounted on metal castors for every workstation point. The above assembly unit, Prelam and mica of IS standard and specifications.

a work stations - corner 'U' type 0.00 Nos

4 **FULL HIGH GLAZED PARTITION - MODULAR**

Supplying and fixing in position fully glazed full height modular partition work in frame work at 2' x 2' grid (horizontally and vertically) comprising of 2" x 1½" T.W section and/ or as per frame work with 6mm plywood on both sides finished with 1mm thick laminates of approved shade and colour. Item to include door of size 3'0" x 7'0" with etching and frosting as per design and 2" x 2" T.W. member for door sides and glass sides and T.W door frame to take 8mm thick glass with etching and frosting. All exposed T.W surfaces to be finished in melamine polish of matching laminate colour as directed including all necessary stainless steel finish fittings/ hardware, door closers, Godrej locks and wood preservative paint etc. as per list of approved material

and as approved by the project consultant/ bank complete in all respects including door.

(Note : In case of false ceiling, the vertical T.W

members to be fixed with pucca ceiling but the area of partition payable will be below the false ceiling only)

a) BM cabin & vc & ups room partition (9'6" ht) - modular 590.00 Sft

4 HALF HT GLAZED MODULAR PARTITION

Supplying and fixing in position half ht glazed modular partition comprising of GI floor channels 48 mm x 50 mm & 0.45 mm thk at 4'0" intervals fixed with 8mm tk fiber cement board on both sides & joints filled with joint tape & jointing compount. All openings & doors to be reinforced with GI intermeditate channels of .7mm thk. Both sides finished with 1mm thk laminate of approved shade & colour. **Item to include** 8mm thick glass with etching and frosting.

All exposed surfaces to be finished with Teak Wood lipping in melamine polish of **matching laminate** colour as directed including all necessary stainless steel finish fittings/ hardware, door closers, Godrej locks and wood preservative paint etc. as per list of approved material and as approved by the project consultant/ bank complete in all respects. Skirting to be provided as per archietct direction.

i 4'6" from finished floor level for side modular partition 380.00 Sft

II 4'6" ht from finished floor level for modular workstations 0.00 Sft

III 9'6" ht modular oneside partition for waitting lounge 330.00 Sft

5 STORAGE CABINET - MODULAR (HALF/FULL HEIGHT)

Supplying & fixing of Storage cabinets upto a height of 2'6"/7'0", size 1'3"/1'6" wide and 1'3" deep, made of 18mm thick termite treated, water proof plywood. The backside of the cabinet is to be covered with 12mm thick plywood. The front door is to be lipped withteak wood on all four sides. The doors are to be fitted with 3" brass hinges and proper locks are to be fixed. The outer sides of the cupboard are are to be finished with 1.5mm thick laminate. The inner side of the cabinet is to be finished with 2 coats of putty and 2 coats of enamel.

a.) Full heigh (FCB) VC Room store only 7'0" ht 100.00 Sft

b.) Half heigh (HCB) Behind MTB & OTBs (2'6"ht) 130.00 Sft

c.) Half heigh (HCB) Behind cubical OTBs (5'0" ht) 0.00 Sft

6 **SIDE CREDENZA - MODULAR**

Supplying & fixing of Storage cabinets up to a height of 2'6", as per drawing wide and 1'3" deep, made of 18mm thick termite treated, water proof plywood. The backside of the cabinet is to be covered with 8 mm thick plywood. The front door is to be lipped with teak wood on all

four sides. The doors are to be fitted with 3" brass hinges and proper locks are to be fixed. The outer sides of the cupboard are to be finished with 1 mm thick laminate. The inner side of the cabinet is to be finished with 2 coats of putty and 2 coats of enamel.

a.) BM cabin, RC.& Manager table (5 Nos) 45.00 Sft

7 **PANTRY COUNTER - DINING - MODULAR**

Fabrication and Fixing of modular dining counter of 19 mm plywood finished with 1mm tk laminate on the outer exposed sides and duco automotive paint on the inner sides so as to match the color of the interiors. The work has to be completed as per architect's direction.

a.) Pantry (Dining) & Dafthry counter - 2'0" wide 10.00 Rft

8 **NOTICE BOARD**

Fabrication and fixing of Notice board made of wooden frame filled with soft board covered with fur. The colour of the fur is to be selected by the Architect. The outer frame of the notice board is to be finished with automotive paint so as to match the colour of the existing wall.

(Size 4'0" x 3'0") 12.00 Sft

9 **BOXING FOR ROLLING SHUTTER**

Box with open able shutter & ceiling in 19mm tk ply for rolling shutter servicing with support in wooden frame, etc& complete with paint finish on all the sides

135.00 Sft

TOTAL AMOUNT

Rs:

(In words: Rupees

Only).

Notes: All items are excluding of GST and other applicable taxes, unless specified

**SCHEDULE FOR THE
ELECTRICAL WORKS**

AT

**M/s. INDIAN BANK,
MCB BRANCH,
NAMAKKAL, TAMIL NADU.**

TENDER FOR THE ELECTRICAL WORKS
AT M/s. INDIAN BANK, MCB BRANCH, NAMAKKAL, TAMIL NADU.

S.No	Description	Qty	Unit	Rate (Rs.)	Amount (Rs.)
1	Supply & laying of following PVC insulated copper wire in suitable PVC conduit pipe/PVC channels as per site condition) necessary clampings etc ., for branch				
a	4C x 25 sq mm AL Ar UG Cable from EB Mains to main power panel.	120.00	mtrs		
b	4C x 6 Sqmm + 1R x 4.0 Sqmm copper cable from main power panel to UPS input Mains 4 point & AC DB	85.00	mtrs		
c	4C x 4 Sqmm + 1R x 2.5 Sqmm copper cable from main power DB to Lightning DB's .	50.00	mtrs		
d	2 x 4 Sqmm + 1R x 2.5 Sqmm copper wire for Raw Power DB's, UPS Output DB's & AC DB, AC DB to AC units	395.00	mtrs		
e	2 x 2.5 sq mm + 1 x 1 sq mm MCB to computer (UPS.)	260.00	mtrs		
f	2 x 2.5 sq mm + 1 x 1 sq mm RAW power & lightings (including sinage lighting)	240.00	mtrs		
g	1 x 6 sq mm from dedicated UPS Earth pit to UPS	160.00	mtrs		
2	Supply & Wiring using 3 run of 4 sq mm and 2 run of 2.5 sq mm 600 V grade. PVC insulated FR copper wire through 25 mm dia PVC conduit with all necessary accessories like bend collar, saddle, screws etc. complete - from main panel to UPS mains.	35.00	mtrs		
3	Supply & installation of 63 A 4 P change over switch with SS enclosure	1.00	No		
4	Supply & intallation of UPS Power 3Nos 6 A 3 Pin sockets, 1No 16A switch in suitable box modular type. Work stations -13, Server - 1 No. 6A (5 pin socket) Manager cabin - 2 No.,	9.00	Nos		
5	32 A 3 Pin Metal Plug & socket with 1No 25A SP MCB for A	10.00	No		
6	Supply & intallation of RAW power for BC , POF,OTB and front office tables 16 A 3 pin sockets. 1 no 6 A switch in suitable box modular type	12.00	Nos		

- 7 Supply & wiring for light points/ fan point wiring using 3 x 1.5 sq mm
PVC insulated copper wire in suitable PVC conduit pipe
with all accessories - concealed in wall including supply and
fixing of switch boxes, 6 A switches, ceiling rose etc. 60.00 points
- 8 Supply, Fixing and wiring of wall fan with 1 No 6A socket
with 6A Switch with all necessary wirings.(Modular type) 13.00 points
(Burglar alarm & CCTV camera points at BM Cabin)

NET TOTAL AMOUNT (A)

Rs:

(Rupees:

Only)

Notes: All items are excluding of GST and other applicable taxes, unless specified

TENDER FOR THE ELECTRICAL FITTING WORKS
AT M/s. INDIAN BANK, MCB BRANCH, NAMAKKAL, TAMIL NADU.

S.No	Description	Qty	Unit	Rate (Rs.)	Amount (Rs.)
I	<u>Fixtures & Fittings :</u>				
	Supply, delivery at site, receiving, storing, handling, carriage at site, assembling, erection including the drop down rods, chains, hooks & accessories connecting, testing and commissioning of the following Ceiling / wall mounted light fixtures including the lamps etc complete. (All fixtures to be of Wipro/ Philips/Havells make only and lamps of GE / Osram make only). (the rates are net and inclusive of cutouts and fixing).				
	1) Supply, fixing & connecting of following MCB DBs with necessary interconnections. Double Door type - concealed in wall as per site condition				
	a) MAIN POWER MCB DB: with ELCB This DB comprising of the following : Incoming: 125 A 4 P MCCB(25 Kilo amps) 1 No.				
	(i) 63 A TP MCB = 1 for A/C				
	(ii) 40 A TP MCB = 3 for ,UPS,Lightning,Raw power				
	(iii) 63 A TP MCB = 1 for Spare 8way TPN vertical D.Door DB For MCCB Provision.	1.00	set		
	b) Lighting MCB DB : incoming: 40 A 4 P MCB - 1 No : Outgoing 10 A SP MCB - 9 Nos: Enclosure: 4 way TPN DB	1.00	set		
	c) UPS INPUT MCB DB: Incoming; 40 A 4 P MCB 1 No Outgoing: 20 A 2 P MCB 2 Nos Enclosure: 4 Way TPN DB	2.00	set		
	d) UPS OUTPUT CIRCUIT MCB DB: incoming 40 A 2 P MCB 1 Nos Outgoing: 10 A SP MCB 7 Nos Enclosure: 4 way 12 W SPN DB	2.00	set		

S.No	Description	Qty	Unit	Rate (Rs.)	Amount (Rs.)
e)	RAW POWER MCB DB: incoming 40 A 2 P MCB 1 Nos Outgoing: 10 A SP MCB 8 Nos Enclosure: 4 way TPN DB	1.00	set		
f)	AC POWER MCB DB: Incoming: 40 A 4 P MCB 1 No Outgoing: 20 A 2 P MCB 7 Nos Enclosure: 6 Way vertical DB	1.00	set		
a)	1 x 33 w LED square downlight Recess Mounted (Philips RC 375 B 30S) (2' x 2' fitting) (Incl Frame)	25	No		
b)	1 x 22 w Philips Square Ultraslim (AL body) 9"x 9"	14	Nos		
c)	1 x 15 w LED Ultraslim Round light (Al body)	24	Nos		
d)	1 x 5 w LED Ultraslim spot light (Al body)	0	Nos		
e)	1 x 7 w LED Round Spot light COB+ (Al body)	8	Nos		
f)	CG Wall Mount Fan (Crompton / Usha)	13	Nos		
g)	48" CG Highspeed Ceiling Fan (Crompton / Usha / Havells)	3	No		
h)	1 x 21 w LED Tube fitting Smart Bright 4feet (Al body)	9	No		
i)	Exhaust fan (9" exhaust almonored) Including provision for Opening & plstring wherever requ (Toilet & UPS Battery Room)	3	Nos		
II General :					
a)	Rectifying, Testing, Erection and Commissioning of existing light points with fittings	5	Nos		
III EARTHING					
1	Providing dedicated earthing with 600 x 600 x 315 mm copper plate along with 50 mm dia. 10ft long GI pipe with other accessories in the earth filled with necessary salt, charcoal, etc, for up it should be covered with GI manhole cover with necessary civil works. dedicated earth pit with earth resistance less than 1 ohm. A dedicated earth pit preferably the distance between one earth pit to another earth pit should not be less that 8ft inspection pit.	1	set		

S.No	Description	Qty	Unit	Rate (Rs.)	Amount (Rs.)
------	-------------	-----	------	---------------	-----------------

2	INSTALLATION OF UPS EARTH: Providing earth station comprising of 300 X 300 X 3mm copper plate with earthing resistance less than 2 ohms including watering PVC/GI pipe with funnel excavation back filling salt filling salt and coal filling in layers 10" x 10" masonry chambers with sand plaster etc complete as per architect direction.	2	No		
---	--	---	----	--	--

TOTAL AMOUNT

Rs.

(In words: Rupees

only)

Notes: All items are excluding of GST and other applicable taxes, unless specified

**SCHEDULE FOR THE
DATA CABLING WORKS**

AT

**M/s. INDIAN BANK,
MCB BRANCH,
NAMAKKAL, TAMIL NADU.**

**TENDER FOR THE DATA CABLING WORKS
AT M/s. INDIAN BANK, MCB BRANCH, NAMAKKAL, TAMIL NADU.**

S.No	Description	Qty	Unit	Rate (Rs.)	Amount (Rs.)
I Telephone And Data Cabling Works					
1	Supply & laying of I.O Telephone point including cable in suitable PVC conduit pipe	10	Nos		
2	Supply & laying of 2 pair Telephone cable in suitable PVC conduit pipe	260	mtrs		
3	Supply & installation of RJ 11 Telephone socket(modular type)	10	Nos		
4	Supply & laying of 10 pair Telephone cable for Leased/ISDN Line including casing capping etc,. Complete.	235	mtrs		
5	Supply & installation of 20 pair krone block in suitable MS Enclosure with locking arrangements	1	No		
6	Supplying & Fixing of HCL CAT 6 10/100/1000 Mbps UTP Cable including the cost of laying the cable & PVC conduit pipe etc.complete	280	mtrs		
7	Supply & installation of RJ 45 information Outlets	9	Nos		
8	Supply & providing of RJ 45 HCL CAT 6 patch cords - 3 Feet	9	Nos		
9	Supply & providing of RJ 45 HCL CAT 6 patch cords - 7 Feet	9	Nos		
10	Supply & Fixing of 10.5" 6U Rack with power manager & Cable Manager with fasteners including the cost of rack fixing etc.complete	1	No		
11	Supply & Fixing of HCL 24 Port 10/100/1000 Mbps Fast Ethernet Switch	1	No		
12	Supplying & Fixing of HCL CAT 24 Port Patch Panel including punching & Fixing etc.complete	1	Nos		
TOTAL AMOUNT				Rs:	
<i>(Rupees:</i>				<i>Only)</i>	

Notes: All items are excluding of GST and other applicable taxes, unless specified

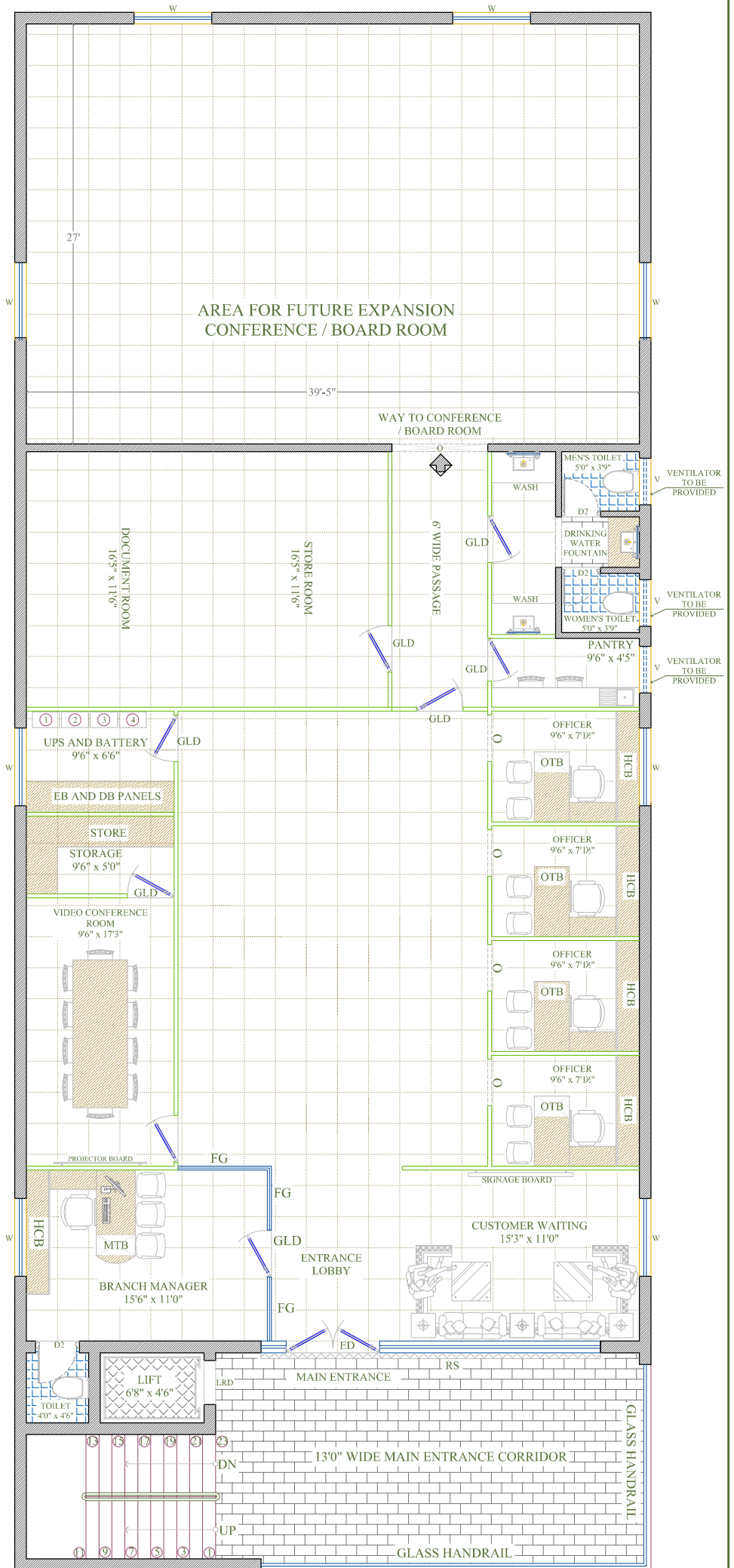

PROPOSED INTERIOR LAYOUT PLAN FOR M/s.INDIAN BANK, AT NAMAKKAL MCB BRANCH

NOTES:



AREA DETAILS :

CARPET AREA OF BANKING HALL : 2195.00 SQFT
 CARPET AREA OF TOILET : 57.00 SQFT
 AREA FOR FUTURE EXPANSION : 1064.00 SQFT

TITLE:

SCHEMATIC DRAWING - INTERIOR FLOOR PLAN - OPTION - 7

SCALE:

ALL MEASUREMENTS ARE IN FEET & INCHES THE DRAWING STRICTLY TO BE READ AND NOT MEASURED

DRAWN BY:

WASIM

CHECKED BY:

ANAND

DATE: 04.07.2024

PLATE NO:INB/MCB BRANCH/SD/FF/INT/07

ARCHITECT :

S.VIJAY ANAND B.Arch, Mem COA, AIIA.

DESIGN CONSULTANTS

ARCHITECTURE & INTERIORS
 #1281, TRICHY ROAD
 COIMBATORE - 641 018
 Ph: 2301 246, Fax: 2301 191

AVANT GARDE

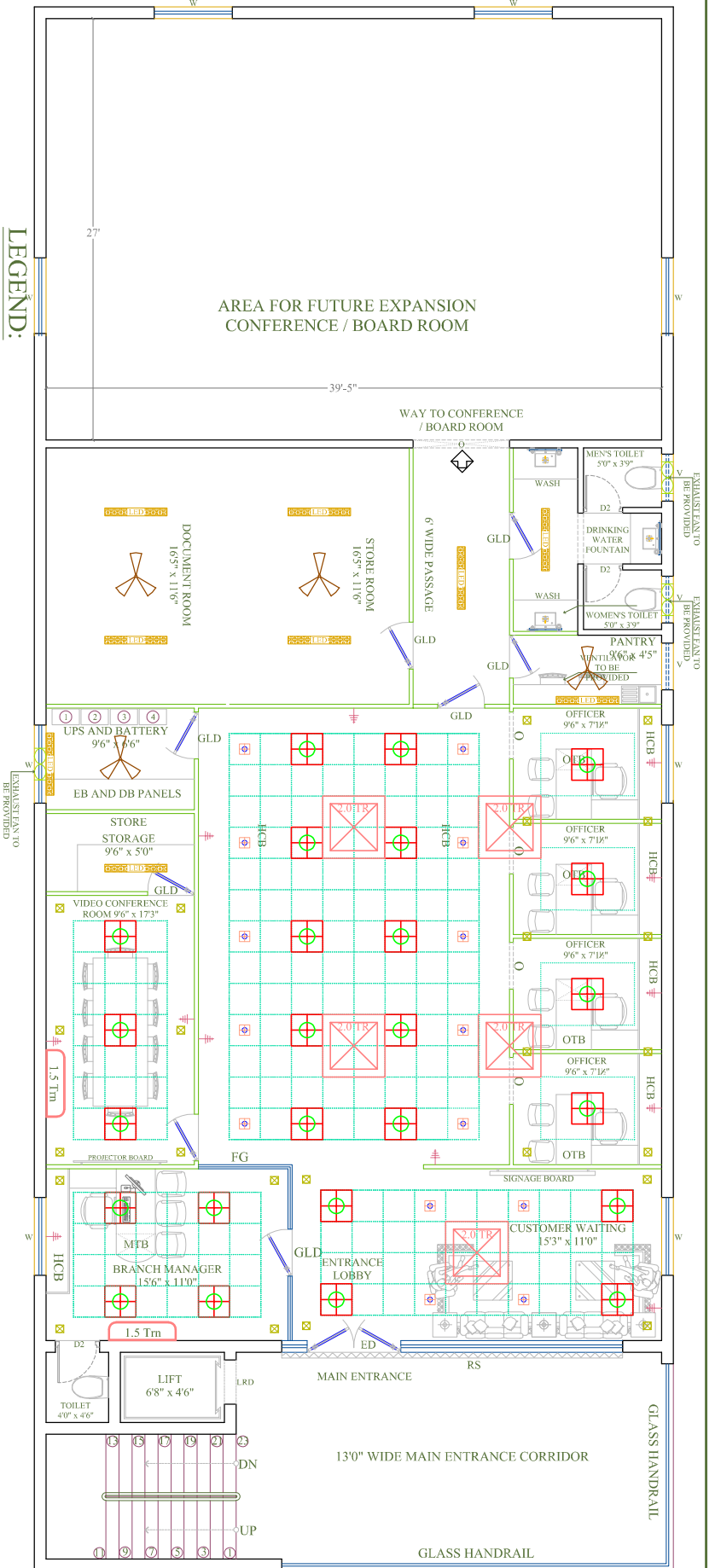

LEGEND:

	1 x 36 w LED (2' x 2')	25 Nos.		1x 7 w LED Round Spotlight	04 Nos.		Wall Fan	13 Nos.
	Square downlight			Ordinary Parting fitting (wipro)	09 Nos.		1.0 Trm AC unit	00 No
	1 x 22 w LED Ultralim	14 Nos.		Ceiling Fan	03 No		1.5 Trm AC unit	02 Nos
	1 x 18 w LED	00 Nos.		Exhaust Fan	03 Nos.		2.0 Trm AC	05 Nos
	Round down light							
	1 x 18 w LED Ultralim	24 Nos.						
	Square down light							

NOTES :

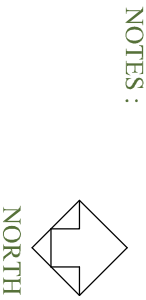

TITLE: ELECTRICAL AND AC LAYOUT PLAN
GROUND FLOOR PLAN - OPTON-VII

SCALE: N.T.S

ALL MEASUREMENTS ARE IN FEET & INCHES THE DRAWING STRICTLY TO BE READ AND NOT MEASURED

AREA :

PROPOSED INTERIOR LAYOUT PLAN FOR M/s.INDIAN BANK, AT NAMAKKAL MCB BRANCH

DRAWN BY: SAKTHI

CHECKED BY: ANAND

DATE : 12.07.2024

PLATE NO:INB/MCB BRANCH/ED/FF/INT/07

ARCHITECT

A.r.S.VIJAY ANAND B.Arch., Mem COA, AIIA.

DESIGN CONSULTANTS

ARCHITECTURE & INTERIORS
#1281, TRICHY ROAD
COIMBATORE - 641 018
Ph: 2301 246, Fax: 2301 191

AVANT GARDE