



PREMISES DEPARTMENT
ZONAL OFFICE HAMIRPUR

**QUOTATION FOR
INTERIOR FURNISHING, ELECTRICAL & DATA CABLING
WORKS IN NEW PREMISES OF INDIAN BANK
PANWARI ATM, DISTRICT - MAHOBA**

Date : 22.02.2024

Issued to:

.....
.....
.....

Last date of submission of Quotation	28/02/2024 upto 15:00 HRS at Indian Bank, Zonal Office, Premises Department, 10/379, Rameni Tarauns, Hamirpur - 210301
Date of opening Quotation	29/02/2024 at 16:00 HRS Indian Bank, Zonal Office, Premises Department, 10/379, Rameni Tarauns, Hamirpur - 210301
Cost Of Quotation	Free Of Cost.

CONSULTANT:

M/s Mohit and Associates
Architects, Interiors & Estimators,

L-2/554-, Vineet Khand,
Gomti Nagar, Lucknow-226010

E-Mail: mohitg.gupta2783@gmail.com
Mobile No: 742821765, 9582218092



**INDIAN BANK
ZONAL OFFICE – HAMIRPUR**

NOTICE INVITING QUOTATION

Indian Bank, Zonal Office HAMIRPUR invites sealed Quotations from **Empanelled Contractors** with Indian Bank (single bid system) for proposed Interior Furnishing, Electrical & Data Cabling Works in the New Premises of Panwari ATM, District - Mahoba. The Quotation can be downloaded from the Bank's website (www.indianbank.in) under Tender Column.

1	Name of work	Interior Furnishing, Electrical & Data Cabling Works in New Premises of Panwari ATM, District - Mahoba
2	Estimated cost of work	Rs. 2.12 Lakh
3	Period of completion	15 days to be reckoned from 5 TH day from the date of issue of the Work Order or handing over of site whichever is later
4	Validity of Quotation	90 Days from the date of opening
5	Defects Liability Period	12 Months from the date of virtual completion of work
6	Earnest Money Deposit	Rs.2,000/- (Rupees Two Thousand Only) by way of DD in favour of Indian Bank payable at HAMIRPUR <i>*Firms registered with MSME / NSIC with valid certificates issued by GOI are exempted from submitting EMD along with Quotation.</i>
7	Initial Security Deposit (ISD)	After acceptance of Work Order, Contractor shall submit ISD of 2% of the Bid / Contract Amount in the form of DD.
8	Retention Money (RM)	5% of the Bill Amount excluding Taxes
9	Total Security Deposit (TSD) = ISD + RM	7% of the Bid Amount (ISD – 2% & RM – 5%) ISD Amount will be refunded to Contractor within 14 days from the issue of Work Completion Certificate by the Architect and the Retention Money will be refunded after the completion of defect liability period.
10	Interim / Adhoc Payment	No Interim / Adhoc Payment will be paid
11	Liquidated Damages	1% per week of the Contract Value subject to maximum total of 10% of final Contract value
12	Quotation Documents	Quotation documents can be obtained from Indian Bank, Zonal Office, Premises Department, 10/379, Rameni Tarauns, Hamirpur – 210301 from 22/02/2024 to 28/02/2024 on all working days during office hours and / or can be downloaded from the Bank's website (www.indianbank.in) under Tender column.
13	Last date of submission of Quotations	28/02/2024 upto 15:00 HRS at Indian Bank, Zonal Office, Premises Department, 10/379, Rameni Tarauns, Hamirpur - 210301
14	Date of opening	29/02/2024 at 16:00 HRS Indian Bank, Zonal Office, Premises Department, 10/379, Rameni Tarauns, Hamirpur - 210301

Note:

1. The bank is not bound to accept the lowest Quotation & reserves the right to accept or reject any or all Quotations/bid without assigning any reasons whatsoever.
2. The rates quoted by the bidders shall be based only on the specifications and conditions of the this document.
3. Bank is not liable to make any payment to Bidders for preparation to submit the Quotation/bid.

ZONAL MANAGER



GENERAL RULES AND INSTRUCTION FOR THE GUIDANCE OF BIDDERS

1 Definition of terms / interpretation:

- Employer/Owner/Bank /Indian Bank/ Accepting Authority shall mean Indian Bank with their Corporate Office at No. 254-260, Avvai Shanmugam Salai, Royapettah, Chennai – 600 014 inter-alia having their Zonal Office at 10/379, Rameni Tarauns, HAMIRPUR – 210301 and any of its employees representative authorized on their behalf.
 - Throughout these bidding documents, the terms “bid” and “Quotation” and their derivatives are Synonymous.
 - Day means calendar day. Singular also means plural
 - “Contractor” means the person whose Quotation has been accepted by the Employer and the legal successors in title to such person, but not (except with the consent of the Employer) any assignee of such person.
 - Bidder: The term ‘Bidder’ shall mean the individual or firm or company whether incorporated or not, undertaking the work and shall include legal representative(s) of such individuals or persons composing such firm or company or successors of such firm or company as the case may be and permitted assigns of such individual or firm or company.
- 2 Quotations, which should always be placed in sealed cover, with the name of the work written on the envelope “Interior Furnishing Work in New Premises of Panwari ATM, District – MAHOBA “ will be received by Chief Manager (P&E), Indian Bank, Zonal Office , Premises Department, HAMIRPUR.
- 3 Earnest money amounting to **Rs.2,000/- (Rupees Two Thousand Only)** in the form of Demand Draft drawn in favour of “**Indian Bank**”, payable at HAMIRPUR must accompany each Quotation. EMD amount will not carry interest. Quotation without earnest money will be summarily rejected.
Please note that firms registered with MSME / NSIC under single point registration with valid certificates issued by GOI are exempted from submitting EMD. Necessary Certificates must accompany bid. No other type of certificate is acceptable. The exemption and relaxation in EMD is subject to the validity & acceptance of their registration certificate on the date of opening of Quotation.
- 4 The Indian Bank does not bind itself to accept the lowest or any Quotation and reserves to itself the right of accepting the whole or any part of the Quotation and the Bidder shall be bound to perform the same at the rate quoted.
- a. The rate quoted by the Bidder shall be net (excluding GST), up to the stage of incorporation and handing over site. All taxes including (excluding GST) or any other tax on material or on finished works like Turn-over Tax, including taxes that may be newly introduced subsequent to the Quotation etc. in respect of this contract shall be payable by the Bidder and the Indian Bank will not entertain any claim whatsoever in this respect.
- The rate quoted should be excluding GST.***
- The Bidder who wishes to quote should have GST registration and should mention the registration number.**
- 5 The Bidder shall give a list of his relatives working with the Indian Bank along with their designations and addresses.
- 6 No employee of the Indian Bank is allowed to work as a contractor for a period of two years of his retirement from Indian Bank service, without the previous permission of the Indian Bank. The contract is liable to be cancelled if either the contractor or any of his employees is found at any time to be such a

person who had not obtained the permission of the Indian Bank as aforesaid before submission of the Quotation or engagement in the Bidders service.

- 7 The Quotation for works shall remain open for acceptance for a period of 90 days from the date of opening of Quotation. If any Bidder who withdraws his Quotation before the said period, then the Indian Bank shall be at liberty to forfeit Earnest Money paid along with the Quotation.
- 8 The Quotation for the work shall not be witnessed by a Bidder or Bidders who himself/themselves has/have submitted Quotation or who may and had/have submitted Quotation for the same work. Failure to observe this condition would render Quotations of the Bidders as well as witnessing the Quotation liable to summary rejection.
- 9 It will be obligatory on the part of the Bidder to Quotation and sign the Quotation documents for all the component parts.
- 10 Transfer of Quotation documents purchased by one intending Bidder to another is not permitted.**
- 11 The Bidder must pay the amount of Earnest Money as mentioned in the Notice of Quotation Invitation by Bank Demand Draft payable to Indian Bank. No interest on Earnest Money deposited by the Bidder shall be allowed. The Bidder should attach the Bank Draft along with the Quotation failing which the Quotation will not be considered. No other mode of payment shall be accepted.
- 12 The Earnest Money Deposit of unsuccessful Bidders shall be refunded within three weeks of award of contract to the successful Bidder or within one week of actual commencement of work whichever is earlier and in any case not later than four months.
- 13 The Earnest Money Deposit of the successful Bidder shall be refunded on the acceptance by the Employer of the Contractor's Demand Draft towards Security Deposit.
- 14 The EMD of the Bidder, whose Quotation is accepted, shall be forfeited in full in case he does not start the work by stipulated date mentioned in the award letter.
- 15 The retention amount at 5% on the value of the bill paid will be held by the Indian Bank apart from ISD.** ISD Amount (2%) will be refunded to Contractor within 14 days from the issue of Work Completion Certificate by the Architect and the Retention Money (5%) will be released at the end of Defect Liability Period (12 Months), subject to satisfactory rectification of defects noticed, if any. ISD and Retention Amount held in our Bank's Book will not carry any interest.
- 16 The acceptance of a Quotation will rest with the Indian Bank and the Indian Bank reserves to itself the authority to reject any or all of the Quotations received without the assignment of a reason. Quotations in which any of the prescribed conditions are not fulfilled (or) are incomplete in any respect are liable to be rejected. The Indian Bank reserves the right to accept the Quotation in full or in part and the Bidder shall have no claim for revision of rates or other conditions if his Quotation is accepted in parts.
- 17 Canvassing in connection with Quotations is strictly prohibited and the Quotations submitted by the Bidders who resort to canvassing will be liable to rejection.
- 18 All rates shall be quoted on the proper form of the Quotation alone. **All the entries to be made legibly in ink only.** Rates written in pencil or any other mode shall not be considered for evaluation and will be rejected.
- 19 The Bidders shall take care to price his Quotation rationally. Extreme under pricing or overpricing in item rates, total amount will be considered adversely in the assessment of Quotations. The Bidder shall on demand submit the analysis of rates of some items of work if so required by the employer.**
- 20 An item rate Quotation containing percentage below/above will be summarily rejected.**
- 21 On acceptance of the Quotation the name of the accredited representative(s) of the Bidder who would be responsible for taking instructions from the Indian Bank shall be communicated to the Indian Bank.
- 22 Special care should be taken to write the rates in figures as well as in words and the amounts in figures only, in such a way that interpolation is not possible. The total amount should be written both in words and in figures.

- 23 The Contractor shall within 7 days of receiving the WORK ORDER submit **INITIAL SECURITY DEPOSIT of 2% of the contract value in the form of a Demand Draft**. On acceptance of the Demand Draft, the Earnest Money Deposit shall be refunded to the Contractor.
- 24 The Contractor shall comply with and give all notices required under any law, rules, regulations, or bye-law of Parliament, State Legislature or Local Authority relating to works. If needed, the Contractor has to obtain required permission/ approval from the building secretary/ association. The Contractor shall before commencing the execution of work issue a certificate to the Employer that he has obtained all the permissions Registrations and give all the notices as are required to be obtained or given under law particularly blasting permission, Police permission etc.
- 25 The Contractor shall be required to maintain the site and the building areas in a neat and clean condition at all times to the satisfaction of the Employer. The Contractor shall especially take care to keep areas free from getting water logged, from concrete/mortar dippings, bricks, steel, shuttering materials or any other material / rubbish.
- 26 Debris and items removed from the building have to be neatly stacked at site and then periodically removed (maximum of one week), carried away by the Contractor and disposed off as per the rules and regulations of the Local Authorities concerned. No debris shall be thrown loose from upper floors. No floor, roof or other part of the building shall be over-loaded with debris or materials as to render it unsafe.
- 27 Employer reserves the right to insist on selection of material, workmanship, detailing and finishes, which they consider, is appropriate, and suitable for the intended use. The contractor is not eligible to claim extra on this account.
- 28 Employer will require the contractor to produce, samples of all the materials, accessories/ finishes prior to procurement/ manufacture. The samples of the materials for the work shall be got approved from the Employer. Failure to comply with these instructions can result in rejection of the work/materials.
- 29 For painting & Lamination, sample area shall be prepared and the shade got approved. It is also advised to give computer presentation of various colour schemes to the employer before going for sample painting/Lamination,
- 30 The Bidder should note that he should execute his part of work without causing any damage to any component of the building and also without disturbing the occupants. Any damage so caused shall be made good at the cost & risk of the Bidder.
- 31 The successful Bidders shall include, in the quoted price, all allied civil works such as chasing in wall, drilling holes etc to support the frames, partitions, make the surface good after grouting, scaffolding required if any to load/ unload the materials etc.
- 32 The successful contractor shall also be responsible for the safety and security of all their materials and also for ensuring fire prevention steps at all times in the working premises including their part of the work. The successful contractor has to place full time representative at site, the representative should have thorough subject knowledge.
- 33 The work shall be carried out without disturbing the existing occupants of other offices. Necessary barricading of the area, if required from the rest of the area shall have to be arranged by the successful contractor at no extra cost. The work is to be organized and executed so as to have least disturbance to the occupants of other offices.
- 34 No interim payment / Adhoc Payment will be entertained in any case.
- 35 ***The contractor should ensure payment of minimum wages + VDA to all labourers / workmen staff employed by him in line with central/ state labour wage act which ever higher.***
The Contractor shall at all times indemnify and keep indemnified the Employer against all losses, claims, damages or compensation including under the provisions of the payment of the Wages Act 1936, Minimum Wages Act 1948, Employer's Liability Act 1938, Workman's Compensation Act 1923, the Maternity Benefit Act 1961, the Bombay Shops and Establishments Act 1947, Industrial Disputes Act 1947, and Contract Labour (Regulation and Abolition) Act 1970 and Employees State Insurance Act 1948, Motor Vehicles Act 1988 or any modifications thereof or under any other law relating thereto and

rules made there under from time to time or as a consequence of any accident or injury to any workman or other person in or about the work whether in the employment of the Employer or Contractor or not, and also against all costs, charges and expenses of any suit, action or proceedings whatsoever out of such accident or injury or combination of any such claims.

- 36 From commencement to completion of works, the Contractor shall take full responsibility for the care of the work and for taking precautions to prevent loss or damage to the work to the maximum extent possible and shall be liable for any damage or loss that may arise to the works or any part thereof from any cause whatsoever including causes of fire, lightning, explosion, earthquake, storm, hurricane, floods, inundation, subsidence, landslides, rock slides, riots (excluding civil war, rebellion, revolution and insurrection) or any latent defect or damage and shall at his own cost repair and make good the same so that at all times the work shall be in good order and condition and in conformity in every respect with the requirements of the Contract.

For the purpose of this condition this expression “from commencement to completion of works” shall mean the period starting with the date of issue of Work Order or date of handing over of site whichever is later and ending with issue of Virtual Completion Certificate.

Without limiting the obligations and responsibilities under this condition, the Contractor shall insure and keep insured the works from commencement to completion, as aforesaid, for the full contract value including Price Variation Adjustment if any against the risk of loss or damage from any cause whatsoever including the causes enumerated in the foregoing paragraphs. In the event of there being a variation in the nature and extent of the works, the Contractor shall from time to time increase or decrease the value of the insurance correspondingly. All the premium for the insurance shall be borne and paid by the Contractor.

Before commencing the work, the Contractor shall without limiting his obligations and responsibilities under this condition, insure against any loss of life or injury to any personnel in the employment of Contractor / Sub-Contractor/nominated Sub- Contractor. For this purpose, insurance shall be taken by the Contractor /Sub- Contractor. Such insurance shall be taken to include both employees/workmen covered by the Workman’s Compensation Act 1923, as well those employees/workmen not covered by the said Act. Separate insurance policies may be taken for employees/ workmen covered by Workman’s Compensation Act 1923, and employees / workmen not covered by the said Act. The entire premium shall be paid by the Contractor. Policy/Policies taken under this para for the personnel in employment with the Contractor / Sub-Contractor may be in their Employer’s names of the Contractor / Sub-Contractor / nominated Sub-Contractors. In the event of any loss or injury to personnel in employment with the Contractor / Sub-Contractor / nominated Sub-Contractors, the Employer and Contractor shall recover directly from the Insurance Company and ensure that payment of the same is made to the affected parties including the Employer. The policy in original shall be deposited with the Employer.

The Contractor shall at all times indemnify and keep indemnified the Employer against all losses and claims for injuries or damage to any person or any property whatsoever which may arise out of or in consequence of the construction and maintenance of the work and against all claims, demands, proceedings, damages, costs, charges and expenses whatsoever in respect of or in relation thereto. Before commencing the execution of the works, the Contractor shall without in any way limiting his obligations and liabilities under this condition, insure at his cost and expense against any damage or loss or injury which may be caused to any person or property including the employees and directors of the Employer and their property by or in the course of the execution of the works. Such insurance to be known as the Third Party Insurance shall be in a sum of **Rs. 1.0 lakh**. The Insurance policy to be so obtained by the Contractor shall be deposited by the Contractor with the Employer within **Seven days** of its issue by the Insurer.

- 37 The Contractor shall take all precautionary measures to ensure the safety of the workmen employed by it. The contractor shall be fully responsible for the any injury or damage caused to the workmen deployed by him at site for carrying out the work and Bank has nothing to do with such happenings and in no way shall be held responsible for the same.
- 38 The contractor shall maintain all registers as required by the Regional Labour Commissioner and should furnish the same to the Bank or its representative as and when required.

- 39 If the work is not started within **7 days** from the date of issue of work order then Employer may terminate the work order without assigning any reason. If during the execution of the work, the progress of work is not considered to be satisfactory and is not consistent to be in contingent with the period of the completion of the work then the Bank may terminate the work order by giving a 5 days notice to the contractor.. In such case the contractor shall be liable to pay the employer any extra cost involved for the completion of the said work and will not obstruct any way in completing the work through other agency. After completion of entire work the contractor shall be paid for the actual work executed by him at the quoted rates after deducting any claims, damages.
- 40 The time allowed for completing the works is **25 days** to be reckoned from **5TH day** from the date of Work Order / date of handing over site whichever is later. Bidders shall submit a programme (time schedule) for executing the entire project and shall furnish the details of their scheme indicating the proposed deployment of their machinery and resources.
- 41 If the Contractor fails to complete any or all the works by the date/s named in **Clause 40** (Date of Completion) or within any extended time (permitted by Bank) then the Contractor shall pay or allow the Employer the sum to be worked out at **1.0%** of contract value per week to be recovered as Liquidated Damages (and not by way of penalty) for the delay, beyond the said date or extended time, as the case may be, during which the works shall remain unfinished and such damages may be deducted from any moneys due or which may become due to the Contractor. The maximum amount of Liquidated damages shall be **10%** of contract value. The contractor shall be bound to extend validity of Insurance Cover till such period of completion as may be considered necessary at their cost.
- 41 **Extension of time:** If in the opinion of the Employer/ Architects the works be delayed (a) by reason of any exceptionally inclement weather or (b) by reason of instructions from the employer in consequence of proceedings taken or threatened by or disputes, with adjoining or neighbouring owners or (c) by the works, or delay of other contractors nominated by the employer and not referred to in the specification or (d) by the reason of authorized extra and additions or (e) by reason or any combination or works men or strikes or lock-out affecting any of the building trade or (f) from other causes which the employer may consider are beyond the control of the contractor, the employer at the completion of the time allowed for the contract shall make fair and reasonable extension of time for completion in respect therefore. In the event of the employer failing to give possession of the site upon the day specified above, the time of completion shall be extended suitably.
In case of such strikes or lockouts as are referred to above, the contractor shall, immediately give the employer, written notice thereof. Nevertheless he shall use his best endeavours to prevent delay, and shall do all that may be reasonably required, to the satisfaction of the employer for any extension of time for completion hereunder (which shall be final and binding on the contractor) shall be promulgated at the conclusion of such strike or lock-out and the employer shall then, in the event of an extension being, granted, determine, and declare the final completion date. The provision in clause 13 with respect to payments of liquidated damages shall be construed as if the extended date fixed by the employer was substituted for and the damages shall be deducted accordingly.
- 42 The successful Bidder shall be required to execute an Agreement in the proforma attached with this Quotation document within **7 days** from the date of receipt of the notice of acceptance of Quotation. In the event of failure on the part of the successful Bidder to sign the agreement within the above stipulated period, the earnest money will be forfeited and the acceptance of the Quotation shall be considered as cancelled.
- 43 The final bill will be released on satisfactory completion of the entire work and on completion of all the terms and conditions / obligations spelt out and on proper submission of the bill together with the measurements. Final Bill settlement is within 30 days from the date of proper submission of bill & measurements.
- 44 The Bidders shall separately specify at the end of the Quotation the % and value of SGST and CGST as applicable. As on date 9 % CGST and 9% SGST IS APPLICABLE FOR WORKS CONTRACT. Regarding tax part, the tax rate at the time of billing shall rule over and above all documentations. Valid documents shall be produced if asked for at the time before payment. TDS for income tax is as applicable and shall

be included in the quoted rates. The comparison for the least bidder shall be made with the basic price of items of work excluding "Goods and Service Tax" part.

- 45 At any stage i.e. during the execution of work, any kind of change required, whether it is in design or specification, the contractor must inform the concerned Department of the Bank or Architect and after getting the approval, the same has to be incorporated by the contractor.
- 46 Single Power point & Water for work will be provided by bank at free of cost.
- 47 The contractor shall not directly or indirectly sublet the work to other party without written permission of the bank.
- 48 The Bank reserves the right to distribute the work for which quotations have been called, among more than one parties, if found necessary. No claim in this respect shall be considered and the contractor agrees to cooperate with other agencies appointed by the Bank.
- 49 Bank shall not be responsible for any loss or damage to the contractor/labour due to any natural calamity during the course of construction. Contractor is liable to make good all the damages if any, till the work is completed and handed over to the Bank authorities.
- 48 No advance payment shall be made to the contractor on supply of any material supplied at site for execution; Payment shall be made only after completion of the work , submission of proper bills and measurement and checking at the site by Architect and Bank' Engineer.
- 49 Contractor agencies are advised (before quoting the rates) to inspect the site of the proposed work. They must go through specifications and documents. Any clarification, if required, may be taken from the bank before submitting the quote.
- 50 The quantities mentioned in schedule are provisional and likely to increase /decrease to any extent or may be omitted thus altering the aggregate value of the contract. No claim for loss of profit/business shall be entertained on this account.
- 51 The contractor /vendor failed to carry out the works as per schedule/Quality, the same shall be carryout with different agencies and the actual amount will be deducted from the contractor bills.
- 52 Payment to the contractor shall be made as per actual work done of site.
- 53 The contractor agency shall keep particular vigil on his workers to maintain very good workmanship of all items, failing which no payment shall be made and no claim of material/labour used shall be made to him in any case, and the same work shall be executed by him again without charging any extra cost.
- 54 The Bank reserves the right to accept/reject any quotes without assigning any reasons.
- 55 Any work got executed in poor workmanship as pointed out by the Bank' Official will have to be dismantled and redone by the Contractor on his own cost.
- 56 Any addition, alteration or correction in the quote shall be signed and stamped properly by the contractor

DECLARATION:

I / We hereby declare that I / We read and understood the above terms and conditions and that we shall abide by them if the work is awarded to us.

Signature & Seal of the Bidder

ARTICLES OF AGREEMENT

THIS AGREEMENT is made on this day ofmonth of between Indian Bank and having its Zonal Office at 10/379, Rameni Tarauns,, HAMIRPUR – 210301(hereinafter referred to as the “Employer”) which expression shall include its successor, legal heirs and assignees of the one part.

AND M/s. Having its office at (Herein after referred to as the “Contractor”) which expression shall include its successor, legal heirs and assignees of the second part.

WHEREAS the Employer has caused drawings and Quotation documents for ‘Interior Furnishing, Electrical & Data Cabling Works in New Premises of Panwari ATM, District – MAHOBA”

AND whereas the Employer has called for Quotation vide ref. no. dated.....

AND whereas the contractor has submitted the Quotation ref. no. dated to the Employer on

AND whereas the Employer has issued the work order ref dated..... to the contractor to do the work.

AND whereas the Contractor has agreed to execute the work as per drawings, specifications, conditions of contract and Work Order.

AND whereas the Employer has accepted the Contractor’s Quotation as aforesaid and whereas the Quotation submitted by the contractor has been accepted for such sum as may be ascertained to be payable in terms of the Bill of Quantities and which sum is estimated to be Rs. (Rupees) herein after referred to as the said “Contract Agreement”.

NOW THIS AGREEMENT WITNESSETH AS FOLLOWS:-

- 1) In consideration of the said Contract Sum to be paid at the times and in the manner set forth in the said Conditions the Contractor shall carry out and complete the Works in terms and conditions herein contained and according to the general conditions of the contract, notice inviting Quotation, special conditions of contract, general scope of work, technical specifications, schedule of rates and instructions to be given by and the supervision of and to the entire satisfaction of the Employer.
- 2) **Contract Price, Taxes and Payment Terms :**
Total contract price is Rs. which is inclusive of cost of materials, equipment, installation charges and tools and tackles required for execution of the job. Above price is inclusive of all taxes & duties including excise duty, GST, income tax, octroi etc. in respect of this contract. No claim in this respect will be entertained. Income tax on payments will be deducted and deposited by Employer in accordance with the sales tax law of the state and the provisions of tax deductions at source under income tax act 1961.
- 3) **Completion Period:**
Time is the essence of the Contract. The work is to be completed in all respects within **25 days** reckoned from 5th day from the date of issue of the Work Order or handing over of site whichever is

later. If the Contractor fails to complete the job within the agreed time period the Contractor will have to bear liquidated damages as per the relevant clause mentioned in the Quotation Documents.

2) **Earnest Money:**

The Contractor has deposited an amount of **Rs.2,000/- (Rupees Two Thousand Only)** as earnest money.

3) **Inspection of Site:**

The Contractor has inspected the site before submitting his Quotation and has satisfied himself as to the nature of the work to be executed on the site. Any difficulties which the Contractor may come across in the course of the work shall in no way relieve the contractor to claim or receive extra payment unless the Employer is of the opinion that such difficulties could not have been foreseen and the Employer consents in writing.

4) **Supply of Material and Labour:**

The Contractor shall arrange all labour, materials, equipments, tools, tackles and everything necessary for the completion of the work. The Contractor will assume all responsibility for the safety, protection and accounting of all material and equipment and the work during construction. All materials used by the Contractor shall be of the best quality conforming to the required specification mentioned in the Quotation document and will be subject to the approval of the Employer. All such materials not approved by the Employer shall be removed at once by the Contractor at his own expense. The Contractor shall also at his own expense arrange for carrying out any test of materials which the Employer may from time to time require or if so desired by the employer.

5) **Defective Work / Materials:**

If any part of the work done by the Contractor is found defective in workmanship or if bad or inferior materials have been used the Contractor shall at his own risk and cost demolish all such defective work and rebuild the same and / or replace the bad or inferior materials used within a time frame mentioned to the satisfaction of the Employer. The decision of the Employer in this regard shall be final and binding on the Contractor. In case of default of the contractor to remove the defective work and rebuild the same or replace bad or inferior materials as directed by the Employer, the Employer shall be entitled to employ anyone else to carry out the same at risk and cost of the Contractor and recover all expenses incurred in this regard from the contractor.

6) **Inspection of Work:**

During progress of the work the Employer shall be entitled at all times to have access to and inspect the work.

7) **Supervision:**

The Contractor shall provide one or more competent and technical qualified engineers duly and fully authorized to act on his behalf in all matters relating to the works to be carried out under or any other matter concerning this agreement and who shall at all times be present at the works while any work is in progress as per directions, explanations & instructions of Employer.

8) **Compliance with Statutory Regulations & Work Rules:**

The Contractor shall be responsible for complying with the applicable laws / bye laws / Regulations in force from time to time and shall have to bear all statutory liabilities to the workers / personnel engaged for the job. Nothing will be paid extra in this regard. If any amount is paid by the Employer with this regard the same amount shall be deducted from the Contractor's dues. The Contractor shall have to arrange insurance cover for the workers / personnel engaged by him for the job.

9) **Determination of Contract:**

In the event of Contractor failing to keep / adhere to agreed schedule of work, or in the event of the Contractor failing to comply with the provisions of this contract by default and / or negligence and / or suspension of work or in the event of Contractor failing to complete the work within the stipulated



period, the Employer may terminate this Agreement forthwith and employ, at the Contractor's risk and cost, another contractor or sufficient number of workmen to complete the work.

10) **Force Majeure:**

This clause will be operative only if the work is delayed by

- a) Acts of God
- b) Earthquake or floods or similar natural calamities.
- c) Serious loss or damage by fire or lightning.

In case any Force Majeure condition herein mentioned occurs and continues for a period exceeding 15 days the parties hereto undertake to sit together and devise ways for expeditious and proper performance of the obligations of the parties under this order.

11) **Arbitration:**

" In the event of any dispute or difference relating to interpretation and application of provisions of the contract and all disputes/claims whatsoever which shall either during the continuance of the contract or afterwards either between the parties to the contract or the respective representatives touching the construction/application of any provision/clause mentioned in the contract or any account or liability between the parties to the contract or as to any act or deed or omission of any party to the contract, in any way relating to these presents, shall be first at the discretion of the Bank attempted to be resolved in good faith by mutual discussion within 30 days of the dispute or question being raised failing which the same shall be settled by arbitration in accordance with provisions of Indian arbitration and Conciliation act 1996.

The Parties concerned shall designate an arbitrator on mutual consent/consensus. The venue of the arbitration shall be exclusively at HAMIRPUR and any award passed by arbitrator shall be final, conclusive and binding upon the parties and shall be deemed to have been made between parties themselves. The parties to the dispute shall share equally the cost of arbitration as intimated by the arbitrator".

IN WITNESS whereof the said contracting parties have set their hands and seals on the day and year first hereinabove witness.

Witness Address

Employer

Witness Address

Contractor

List of Materials of Approved Brand And/ Or Manufacture

S.NO.	MATERIALS	APPROVED BRANDS
1	False Ceiling & Cornices	India Gypsum, Armstrong
2	Aluminium Fram	Jindal, Hindalco
2	Wood Framework: All wood must be well seasoned, free from knots, other defects.	Meranti (seasoned) with two coats of wood preservative
3	Wood skirting /mouldings, Lipping /beading	Steam beech/ Mahogany/ Teak wood
4	BWP Marin Ply wood (IS: 710)	Green ply/ Archid/ Century
5	Laminate	Century/ Archid/ Greenlam/ Sunmica
6	Veneer	Century/ Archid/ Greenlam
7	Wood Preservative	STP- Pentaphene pale / Termination Tor (Pidilite)
8	Adhesive	Fevicol SH (Pidilite) / Araldite/SR- 998/ Century – SH
9	Door Closer	Dorset/ ozone/
10	Floor Spring	Dorma/ ozone
11	Door Lock	Ozone / Hattich/ Godrej
12	Drawer Lock	Ozone / Hattich / Godrej
13	Hardware	GKW
14	Hinges	Ozone / CIEF/ Ebco
15	Screws	GKW/ Nettle fold
16	Carpet	Interface/ Shaw
17	Vertical blinds	MAC decor/ Vista levolor
18	Sun Control Film	3M or equivalent
19	Soft Board / Display Board	Jolly board
20	Paints	Berger/ Asian/ Nerolac
21	Texture paint	Spectrum/ Oikos
22	Ceramic Tiles	Orientalbell , Nitco, , Kajiria
23	Vitrified tiles	Orientalbell , Nitco, , Kajiria
24	Glass & Mirror	Modi Guard/ Saint gobain, Ashai
25	Handle	Stainless steel finish Neki / Hassely/ Hattich
26	MDF Boards	Greenpanel max/ Archid/ Merino
27	Wooden flooring	Green panel max, Archid, Pergo
28	PVC flooring	Armstrong/ Krishna vinyl
29	Sanitary fittings	Toto/ Roca/ Kohler/ Grohe / Jaquar
30		AFC/ Monarch/ PSL/ SPACEWOOD/ STEELCASE

S.NO.	MATERIALS	APPROVED BRANDS
1	PVC fittings	Polycab/ AKG / Precision
2	Wires – PVC insulated copper	Finolex/ Rallison/Polycab/Skytone
3	Cables (armored)	Gloster / Rallison / Havells
4	A.C Starter, Plug Socket	Crabtree / Northwest/ Legrand
5	Light & Power switch socket	Crabtree / Northwest /Philips
6	Telephone Socket	RJ-11 Crabtree/ Philips/MK
7	DB MCB	Legrand/ Hager/ Standard/ Schneider
8	MCB	Legrand/ Havells/ Hager/ Schneider
9	Telephone cable	0.51 Netco / Delton / National
10	Light fitting	PHILIPS/Wipro/Havells
11	Fuse Switch	L&T / Havell's
12	Telephone Connector	Corn
13	Ceiling/ Wall fan	Crompton / Orient / Khaitan
14	Exhaust fan	Crompton / Orient / Khaitan
15	P.V.C tape	Steel Greep
16	Call bell	Max
17	Cable Lug	Dowell's
18	Cable gland	Brass heavy type good quality
19	Distribution board	L&T/ Havells,legrand
20	MS conduit	Heavy duty with ISI mark 16 SWG
21	Starter & single phasing preventer	SEIMENS
22	SPN, TPN, Sheet metal	Havell's / Legrand
23	Pipe Metal	M.S Conduit 16 S.W.G
24	Metal Pipe Fittings	Cast iron with thread & inspection cover
25	Pipe PVC (Rigid Conduit)	AKG / Polypack/Super/Precision
26	PVC fitting for Rigid	-Do-

27	PVC Roll Pipe	Super Dalda or equivalent heavy guage
28	PVC Casing & Casing Fittings	Good quality heavy guage (colour white)
29	Lugs	Dowells
30	Terminals	Essen/Elmex
31	Burglar alarm	Godrej/ Globe detective
32	E-cat 6 Patch panel	Schneider Electric/ Avaya
33	P.A. System	Bosch/ Ahuja
34	CCTV camera	Sony/ Bosch
35	CCTV camera wiring	Crompton/ KEI
36	UPS wiring	Crompton/KEI
37	Aluminum ducting sheet	Jindal/ SAIL
38	AC	Blue Star/ Hitachi/ Daikin Only Copper Coil (Minimum 3 Star rated)

Note –

1. In case of unavailability of any material of specific make an equivalent make can be used only after a written approval of architect/bank. The preference of make/brand of the material listed above will be decided by the architect/Bank. The make/brand of any item will be as mentioned in the drawings issued by the architect.
2. The contractor shall provide samples of all materials in the list of makes as required by the architect. A written approval of these samples shall be sought prior to commencement of any work. Architect/Bank reserves the right to enquire the genuineness of any material used at site directly from the manufacturer
3. Preference of makes, supply of items should be consulted with client/consultant before effecting of supply.
4. Other materials: ISI mark & approved by the Bank.

NAME AND ADDRESS OF THE CONTRACTOR:

SIGN & SEAL OF THE CONTRACTOR:

Date:

Place:

SCHEDULE OF QUANTITIES
INTERIOR FURNISHING WORK IN NEW PREMISES OF INDIAN BANK
PANWARI ATM, DISTRICT - MAHOBA

S No	DESCRIPTION OF WORKS	UNIT	QTY	RATE	AMOUNT
	Main Entrance Door with Fixed Glazing				
1	Providing and fixing powder coated aluminum entrance doors with 12mm float glass (3M frosted sticker) as/design with top & bottom section of 45 by 90mm, 2mm thick section of hindalco/indal anodized in approved color with 25 micron anodizing along with SS C shaped handles of kitch or equivalent make along with floor spring of hemco/everite make. The item also includes door lock completed to the satisfaction of the architect.	Sq Ft	85		
2	Shutter boxing/TRAP DOOR FOR ROLLING SHUTTER				
	P & F shutter boxing made of 19 mm phenol bonded ply IS 303 grade including hatch fir pulling down & up the rolling shutter. The box to be laminated with aluminum composite panel of 3.0 mm completed to the satisfaction of architect. Front surface will be taken for measurement only.	Sq Ft	90		
3	ACP WALL PANELLING (ATM):- Providing & fixing in position ACP (Aluminum Composite Panel) with framing of Aluminum Tube sections of min 1.5"x 1" and 20 gauge 2'-0" C/C both ways. ACP to be in 2' wide panels or distributed equally. Panels to be fixed to the frame with 3M or equivalent adhesive. Joints to be finished with Silicon based sealant. Minimum ACP thickness-3 mm. Aluminum foil thickness to be min 0.25 mm on both sides. Alubond, Eurobond, Fujibond, Alcobond or equivalent ISO certified or approved brands to be used. White (IVORY) & Blue to be as per bank's approval. Additional Sections to be provided to fix the Indoor AC units. Both AC units to be installed near the machine area at the highest position. The rate shall be included for providing proper access panel for ATM power point and shall have proper locking arrangement for plug point by providing additional framing. (The measurement shall be made up to false ceiling & Oly ATM LOBBY).	Sq Ft	180		
4	BACK ROOM (ATM) - Providing and fixing partition made up on Aluminum box section with 2"x2" and 20 gauge with 2'0" C/c Both ways ,and to be fixed on inside 3 mm thick Aluminum Composite panel and rear side (only where backroom/storage is available) with 8 mm thick plywood finished with 2 -coat color enamel paint. The rate inclusive of providing and fixing of suitable shelve for fixatation CCTVs instrument & UPS extra (1Nos.) & Access Door with teak wood louvers, and necessary accessories including handle & locking arrangement and necessary hardware complete as per details. All as per the design and instructions Bank. The item shall include suitable cutting & provision for installation of ATM facility.	Sq Ft	110		
5	SUSPENDED FALSE CEILING				
A	FALSE CEILING (GYPSUM BAORD)				
	Providing and fixing Gypsum false ceiling as per drawing including of providing and fixing G.I. Frame work shall comprise of G.I. perimeter channel (MF-6A) of size 0.50mm thick having one flange of 19.6mm and another flange shall be of size 29.6mm and a web	Sq ft	80		

	of 26.6mm along with perimeter of ceiling, screw fixed to the beam to the required curvature with nylon sleeves and screws at not exceeding 610mm centers. Then suspending G.I. intermediate channel (MF-7) of size 45mm, 0.9mm thick with two flanges of 15mm each bent to the required curvature by cutting both its flanges. Suitable bracing to be provided where ever the flanges are cut with 0.9mm G.I. Flat and nuts and bolts at specific positions and thereafter at 1220mm centers with ceiling angle of width 25mm x 10mm x 0.50mm thick fixed to soffit with G.I. cleats and steel expansion fasteners as per specification of India gypsum at a distance of 2'0" c/c both ways complete with 12.5mm board and all necessary perimeter channels etc.				
	The joints to be properly mended with paper tapes and gypsum compound all complete. The boards are to be jointed and finished which includes filling and finishing the tapered and square edges of the boards with jointing compound and fiber tape suitable for Gypsum board. A layer up to of 3.00mm thickness of Veneer Plaster is applied followed by two coats of topcoat (primer) at the face of board to give smooth seamless finish. 2 or more coats of plastic emulsion paint (roller finish) of approved shade and make shall be applied. The rate should include the full completion of the ceiling. At the time of handing over the site all necessary repairing work to be considered if required. The work to be completed as per specification, approval of the bank. No Drop or design (if any) will be considered as extra measurement it will be considered flat ceiling. (Only plan area to be measured for payment). No extra payment will be made for the cutting of light points, stain glass, cove lighting etc. The measurement will be taken in one level, rate should include the drops also, and no extra amount will be paid for the drops.				
B	Providing & fixing Armstrong ceiling as per architect instruction	Sq Ft	35		
	FALSE CEILING (ARMSTRONG CEILINGS – FINE FISSURED				
	MICROLOOK EDGE WITH SILHOUETTE GRID (BLACK REVEAL)				
	Providing and fixing false ceiling system manufactured by M/s. Armstrong World Industries using hot dipped galvanized steel section, rotary stitched main tee of size 15mm x 42 mm web height, having 0.36 mm gauge at every 600 mm centre to centre maximum and rotary stitched cross tee of size 15 mm x 42 mm, having 0.33 mm gauge at every 600 mm. c/c. and wall angle of size 19 x 19 mm., having 0.35 mm gauge fixed to the periphery of the wall. The above grid is suspended at every 600mm c/c. in both directions using 2.0 mm. thick pre-straightened GI wire laying FINE FISSURED MICROLOOK WITH SILHOUETTE GRID (BLACK REVEAL) ceiling tiles manufactured by M/s. Armstrong World Industries, of size 600mmx600mmx15mm having NRC 0.55, Light reflectance of >84% (WT), thermal conductivity k = 0.052-0.057 W/mOK, Humidity Resistance of 99% , having Fire Performance CLASS O / CLASS 1 (BS 476), surface having 3 coats of white paint with Fine Fissured, back of the tile duly sanded and finished with a coat of protective paint over the formed grid complete. (Branch & ATM) .				
	The work shall also include for cutting chase for conduits and moulded boxes, if required, in the wall/ floor (Without damaging				

	the building/wall) along with clamping the conduit at every 450mm interval & finally finishing the surface & matching the same with the existing surface. The rate should include the cost of all materials, labor, T&P, taxes & levies, scaffolding, shifting of furniture, carting away the debris and cleaning the floor etc. The job shall be complete & to the entire satisfaction of the Bank/architect.				
6	ENAMEL PAINT	Sq ft	0		
	Providing & applying 1st quality oil paint of approved make, quality & shade. The rate shall include scrapping, leveling & preparing the surface with primer quote.				
7	OBD PAINT INTERNAL AREA	Sq ft	0		
	Providing & applying OBD paint on walls, columns & ceilings. The rate shall include scrapping, leveling & preparing the surface. Primer coat + (minimum) 3 coats to get evenly spread quality finish (roller finish) of approved make, quality & finish shall be provided.				
8	Glow Signboard above the entry				
	Supply, Installation, Testing & commissioning of in-lit signboard out of 22 standard wire gauge(SWG) per coated tin sheet box having backlit type flex PVC mesh of 20 ounce sheet (3M/LG/Star Make only) on the front duly pasted CNC-cut 80 micron thick sign graphic vinyl (3M/LG/Star Make only) as per bank's/Architect's instruction including lamination on front side of frame fabricated out of 25x25mm, 20 gauge thick MS spare pipe section with proper welding & duly painted. The board should have in-lit lighting arrangements with suitable nos. (Depending upon the board's size) of 36 watt fluorescent tube light placed at 1 feet distance from each other or as ensuring enough illumination along with all accessories such as electronic ballast (Philips, bajaj, Osram, Crompton or similar) connector & having wiring with 2x1.5 Sq mm +1x1.5 SQMM PVC insulated copper conductor cable). Top sheet should be folded with 45 degree rain drop arrangement. The board design graphics/inscription/logo should be approved by Bank before fabrication/installation.	Sq ft	40		
	TOTAL FOR INTERIOR FURNISHING WORK (A)				



SCHEDULE OF QUANTITIES

ELECTRICAL & DATA CABLING WORKS IN NEW PREMISES OF INDIAN BANK

PANWARI ATM, DISTRICT - MAHOBA

S No	DESCRIPTION OF WORKS	UNIT	QTY	RATE	AMOUNT
B	SCHEDULE - 'B' (ELECTRICAL WORK)				
1	ELECTRICAL WIRING & EARTHING				
1.1	Supply, laying, connection & testing of light, fan point, wiring by 2x1.5 mm sq (2x3/.029) +1x1 mm sq PVC insulated, multi-strand single core copper conductor FRLS wire maintaining the color code as per direction in PVC conduit of 20mm with ISI mark 1.5mm thickness to conceal in wall partition mending good the damage, complete with PVC circular box, bend to be done as per drawing including 3 point ceiling rows wherever required GI saddle to be used for fixing, metal flexible/PVC flexible pipe may use if required in partition wall. All PVC pipes should be with ISI mark. No joints will be allowed inside pipe, light, fan & plug point complete with modular type switch plate & MS box rate Including the main circuit line 2x2.5mmsq+1x1.5mmsq earth PVC insulated Cu. Wire from DB to switch board ,maintaining the color code. Circuit line for lighting switch board & 6Amps plug board are to be drawn from lighting DB to Lighting board & plug point board (independent), 6/16 Amps plug point line are to be draw from power DB as per DB schedule /SLD				
a)	1 light by 1 switch (ATM 1 No),UPS Pt 1 in ATM	Nos.	6		
g)	Same as above 5A Point in the switchboard itself. (ATM 1 No)	No	1.00		
1.2	Supply and installation of modular type 2 nos 6A & multi pin sockets with 2 nos 6 Amp one way switch housed in MS box to be fixed in partitions or concealed in wall. The box shall be painted with 2 coats of enamel paint over a coat of red oxide primer including wiring for Raw power socket outlet using 2 R runs of 2.50 Sq mm and single run of 1.5 sq mm PVC insulated multi stranded single core copper conductor FRLS wire in 20mm PVC conduit to be laid in floor, partitions, etc. complete with all accessories (looping 2 sets of 2x6A socket outlet in one circuit- from DB) (Raw power). (ATM 1No)	No	1.00		
1.5	ACs electrification :-				
(a)	Supply and fixing 20A 3-pin modular socket with 20A one way switch with indicator (near AC indoor unit) housed in manufacturers MS powder coated box to be concealed in wall including Wiring using 2R 2.5 sq mm & single run of 2.5 sq mm PVC insulated multi stranded single core copper conductor FRLS wire in 25mm PVC conduit to be laid in floor, partitions, etc complete with all accessories. (for split AC units) (from Stabilizer to IDU) Supply Stabilizer to be installed in the panel room.	Nos	2.00		
(b)	Supply and fixing 20A - 3 pin metal clad socket with plug controlled by a 20A SP MCB (for Ac wall mounted stabilizers) housed in manufacturers MS powder coated box to be concealed in wall including Wiring using 2R 2.5 sq mm & single run of 2.5 sq mm PVC insulated multi stranded single core copper conductor FRLS wire in 25mm PVC conduit to be laid in floor, partitions, etc complete with all accessories. (for split AC units) from AC DB to Stabilizer	Nos	2.00		

3	Outdoor type glow sign board wiring :-				
3.1	Supply laying of main line with 2x2.5 +1x1.5 mm sq through MS conduit from main panel to glow sign board.	Mts	10		
3.2	Supply installation of 16 amps DP MCB at main entrance Glow sign board & With Electronic timer as required.	Set	1		
7	DISTRIBUTION BOARDS .Make standard/Legrand/ABB for ATM				
7.1	Main DB :S/I of 4 way TPN DB approved brand legrand /Standard/ABB with 63 Amp 4p Isolator				
	63A FOUR POLE Isolator as main (incomer) 32 A 3 POLE MCB 2 NOS (for UPS-1 & Power & Lighting -1Nos)				
	10 Amps SP MCB 1 NO FOR LIGHT AND 10A SP MCB 2NOS FOR POWER. 2 No. 20 AMP MCB SP FOR SPLIT AC and 1 No 10 Amp spare Or as per SLD				
	Including Neutral Bar. 01 Set	Set	1		
7.2	UPS DB : 8 WAY SPN DB FOR UPS ,				
	32AMP DP 2 Nos (1 No for Incoming)				
	10A SP MCB 1 NO FOR UPS LIGHT, 16A SP MCB 2NOS FOR ATM , 1No16A MCB FOR CCTV power point and 2 Nos Spare or as per SLD	Set	1		
7.3	Supply, installation, testing and commissioning of 32Amp rated 3 phase to single phase auto phase shifter for ATM UPS (SLHD of Swift make)	Nos	1		
7.4	Supply & Laying of 4 runs of 4.0 Sq mm and 2 run of 2.5 sq mm, PVC insulated, single core, multi-stranded copper conductor cable in suitable rigid PVC conduit from DB TO AUTO PHASE SHIFTER	Mts	5		
7.5	Supply & Laying of 2 runs of 4.0 Sq mm and 1 run of 2.5 sq mm, PVC insulated, single core, multi-stranded copper conductor cable in suitable rigid / flexible metal conduit from UPS output / Input control to UPS DB	mtr	6		
8	as stated item No.,1,1 but UPS lighting, 6/16 Amps plug point line are to be draw from power DB as per DB schedule /SLD				
a)	1 light by 1 switch (ATM 1N)	Nos.	0		
b)	Wiring (2x2.5mmsq+1x1.5mmsq from power DBs) for independent 2X6A multi pin socket along with 6A modular type switches housed in painted MS box. For ATM CCTV UPS	No	2.00		
9	Supply and installation modular type 16A, 5-16 pin socket with 16A one way switch housed in MS box to be fixed in partitions or concealed in wall. The box shall be painted with 2 coats of enamel paint over a coat of red oxide primer , the rate shall include wiring fusing 2R 4.0 sq mm & single run of 2.5 sq mm PVC insulated multi stranded single core copper conductor FRLS wire in 25mm PVC conduit to be laid in floor, partitions, etc complete with all accessories.(UPS wiring for ATM) one circuit for one 16 amps pin socket .The rate inclusive of machine cutting the tiles from ATM power input to the ATM and laying of 25mm UPVC sleeves in order to run the wire with concealed manner. No power point shall be visible from ATM room inside.(From ATM UPS)	Nos.	2		
10	Earthing	-			
10	Supply, Installation, Testing and Commissioning of Maintenance Free Earthing system made up of copper bonded rod of 10 feet length, 23 mm dia. (Minimum copper bonding shall be 0.25mm) along with Rod-to Conductor connectors, Earth enhancement	No.	2.00		



	material, Pit Cover and other accessories as required and as per specification and other applicable codes (include chamber for earthing, Earthing certificate to be submitted along with the bill).				
10	1 run of 7 /20 PVC insulated wire along with PVC conduits for earthing.	mts	20.00		
11.0	Supplying & fixing 20 pair krone tag block with enclosure. FOR ATM SWITCH SOCKET ENCLOSURE	Nos.	2		
8	ELECTRICAL FITTINGS (S/I/T/C				
8.1	Supply and Installation Recess mounted 2'-0"X2'-0" watt, 38 W LED FULL GLOW Philips MAKE. Light should be fixed through SS threaded bolt tightened the upper end on ceiling using anchor bolt and lower end on Light fitting with nut and bolt (RC380B G2 LED35S-6500/4000 PSU OD WH) PHILIPS/WIPRO MAKE	Nos.	2		
8.3	SQUARE SHAPE DOWNLIGHTER - INTEGRA 15W, 3000K, LHEBGTP5Z1W015, PHILIPS Razor/WIPRO MAKE	Nos.	4		
8.4	MS Body Wall mounting fan 450 mm dia 230 volt A.C. PHILIPS/WIPRO MAKE WITH SWITCH & SOCKET	Nos.	1		
8.5	BULB HOLDER - LED.	Nos	1		
C	SCHEDULE - 'C' (LAN & TELEPHONE WORK)				
2.0	DATA SYSTEM - CONDUITING & CABLING				
2.1					
2.2	Wiring for computer networking from I/O hub to computer workstation with UTP Cat-6 computer cable including providing ferrules at both ends and termination at both ends including providing & fixing frame for with shutter, RJ 45 outlet, faceplate and mounting box complete of modular type, This work includes providing PVC conduits (1/2", 3/4" size or as required) in chases from the I/O hub to the point. The cost includes testing, commissioning etc complete. Note: Do not run more than 3 wires in single pipe & should be concealed. (ATM each 2Nos)	Nos.	3		
2.3	Supply of Cat - 6 D-Link patch cord 7' 0" (ATM 1No)	Nos.	3		
2.4	Supply of Cat - 6 D-Link patch cord 3' 0"(ATM 2No)	Nos.	3		
	TOTAL FOR ELECTRICAL & DATA CABLING (B)				
	GRAND TOTAL FOR FURNISHING (A+B)				

Place:

Signature & Seal of the Bidder

Date:

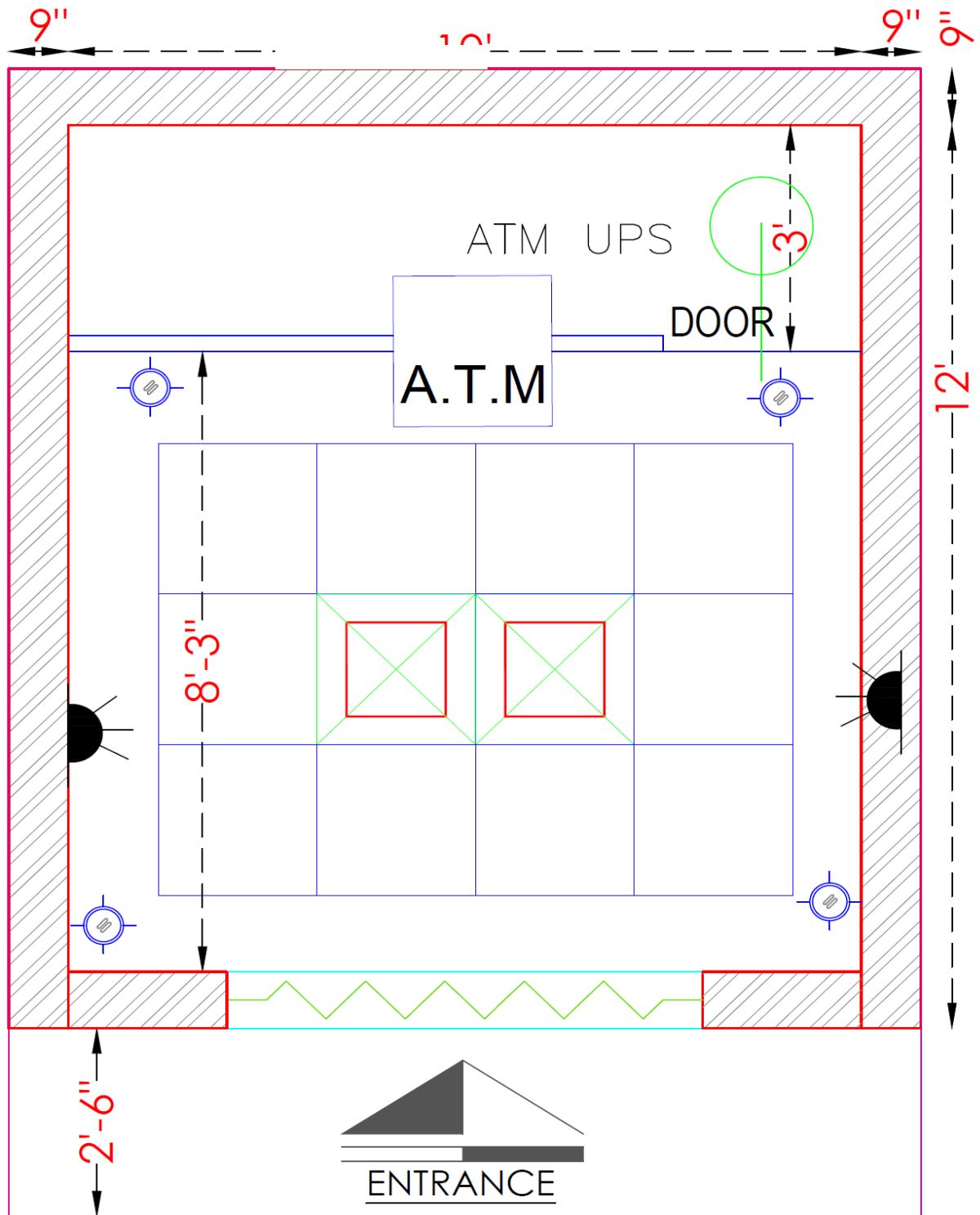

PROJECT

PROPOSED FURNISHING LAYOUT OF INDIAN BANK ,ATM AT PANWARI

DRAWING

LAYOUT

NORTH

SCALE

N.T.S.

DATE

FEB 2024

ARCHITECT

MOHIT & ASSOCIATES

ARCHITECTS, INTERIORS, ESTIMATORS,

L-2/54 VIKRANT KSHAN, GOMTI NAGAR,

LUCKNOW, M.O. - 9582218092, 7428217659