

Note :- THIS DRAWING IS BEST READ ON A3 SIZE SHEET

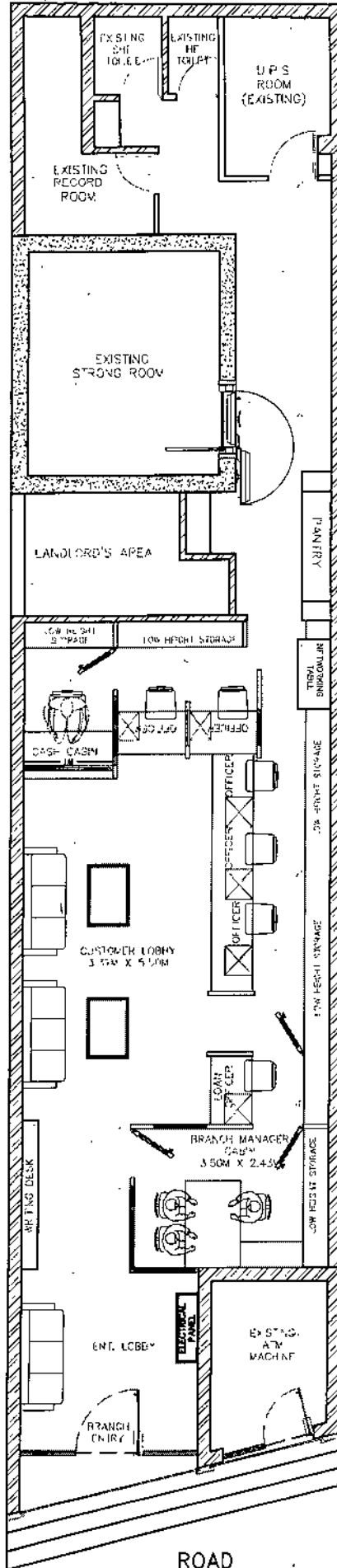

PROJECT :-

PROPOSED
PLAN OF
INDIAN BANK ,
BRANCH @
BHOURA

DRAWING TITLE:

PROPOSED LAYOUT PLAN

DRAWING TYPE - APPROVAL

AREA:

REVISIONS	DATE	DESCRIPTION	BY
▲			
▲			
▲			
▲			
▲			



REV NO: UNIT:
R.03 MM

SCALE:
N.T.S

ARCHITECT:

CREATIVE VISIONS
HOUSE NO 554
SECTOR 25
PANCHKULA-HARYANA
PH- 0172-2550637,
Mob. 09216585700
EMAIL- info@creativevisions.in

DATE:
04/02/2023

DRAWING NO:
CI_FUT_01

DRAWN BY:
Ar. ANKIT AMAR

CHECKED BY:
AR.MADHUR ATRE

NOTES:

ARCHITECT NOTE

A FURNISHING WORKS		ESTIMATE			
S No	DESCRIPTION	QTY	UNIT	RATE	AMT
1	Providing & fixing in position false ceiling in Armstrong 600 x 600 mm x 15/16 mm Dune Supreme RH 99 Prima tile as specified by Armstrong Co. with suspenders wherever required. Making necessary framework for A.C. ducting, if any, and necessary cutouts for diffusers and light fittings, taping and finishing to proper line & level, including making grooves and trap doors for A.C unit in 18mm thick M.R. Grade Plywood with Stainless Steel hinges & locks with moulding 1" x 1" for edges, if any including finishing with White Plastic Emulsion Paint etc. complete in all respects. (Note: - Only the plan area will be measured for payment. No extra payment will be made for cutouts, grooves, mouldings, steps or any type of design etc.)	600	Sqft.		
2	Providing & Fixing false ceiling at 9'-0" ht. of India Gypsum Ltd. (GMFSC-4.1) using 12.5mm thick Gypboard, paper tape, jointing compound, G.I. Sections marked "Gypsteel" to be placed at 4'-0" C/C in one direction and at 1'-6" C/C in other direction. The false ceiling shall be finished properly after cutting / making holes for fixing light fixtures including three coats of oil bound distemper paint etc. complete as per	450	Sqft.		
3 i	Providing & fixing Aluminum partitions / window (powder coated of size 2 1/2" x 1 1/2" x 16 guage bottom section 4 1/2" x 1 3/4" x 2mm th. with 5mm th. glass. And aluminum door/s: 3'-9"X7'-0" powder coated having; External frame called chowkhat: 3 1/4" x 1 1/2" x 2mm thick, Internal door frame and lock rail: 3 1/4" x 1 3/4" & Bottom rail: 4 1/2" x 1 3/4" with 5mm thick etched glass as per design. including all fittings such as al. handles, locks, stopper, tower bolts, etc.	60	Sqft.		
ii	TOUGHENED GLASS DOORS & PARTITION: Providing & fixing 12 MM thick toughened glass for door and fixed glazing, with complete patch fittings such as floor spring, handles, lock and L-brackets etc. The job shall also include etching design.	0	Sqft		0
4	Providing and fixing wooden partition made of internal frame of 1 1/2" x 2" partal wood placed at 2'-0" c/c vertically and horizontally with 6mm thick commercial ply on both sides finished with 1.00 mm thick laminate on both sides. These partitions shall have 5.00 mm thick glass (etching as per design) above 2'-6" ht. or 4'-0" ht with beading 1/2"x1 1/2" . The rate of partition shall include providing & fixing door in partitions made as per the specifications of partition, but with complete hardware required such as latches, stopper. The low ht. partition shall have rubber-wood gola of size 3" x 3/4" which shall be polished as per shade reqd.	0	0	0	0
4(i)	Low ht. partitions with 12 mm thick glass.	190	Sqft.		
(ii)	Full ht partition with 5mm th. Glass.	0	Sqft.		0
(iii)	a) Cash-Cabin's pts (7'-3" high)	70	Sqft.		
(iv)	b) Cash cabins' as well as single windows' front ptn. with 12mm th. Glass.	25	Sqft.		
(v)	Partition in strong room.	75	Sqft.		
(vi)	Rear partition, door for banking hall.	60	Sqft.		0

(vii)	Cost Mortice locks (with handles)	2	No		
(viii)	Cost of Multipurpose locks for storages, drawers etc.	15	No		
(ix)	Cost door closers.	5	No		
(x)	Cost floor springs.	0	No		0
(xi)	Cost of Knight Latches	1	No		
5(i)	P/F wall paneling (in customers' area only) on soft wood frame 1 ½" x 2" placed @ 2'-0" c/c horizontally & vertically @ 1'-0" C/C, finished with 6mm thick commercial ply (of Lexus / Burma / Unity make all conforming to ISI standards) finished with 1.00 mm thick laminate of (Merino, Century, Greenlam, .). The paneling shall be closed with 2" x 1" rubber wood / teak-wood beading.	350	Sqft.		
6	Banking Counters with 1½" thick post-form factory made Tops: Providing & fixing SWO Banking Counters as per design of size 4'-0" x 2' 10" x 2'-6" ht. & 3'-3" ht. (2 heights). The workstation shall the keyboard, drawer, and complete shelf fro CPU at bottom. The work strn. Shall be made of 19mm thick (of Lexus / Burma / Unity make all conforming to ISI standards) commercial board, with rubber -wood Gola of size ¼" x ¾", finished with 1mm thick laminate of (Merino, Century, Greenlam, .) approved shade / colour complete hardware, inside shall be painted with synthetic enamel paint complete in all respects as required by Architect-in-Charge.	4.5	Rft.		
7	Providing & fixing Granite 1" thick black or ruby red to be fixed on banking counters and cash cabins' customers' top area with edges moulded, grinded & polished as per design. .	0	Rft.		0
TOTAL					0
B	FURNITURE & FIXTURE				
1(i)	Tables with 1½" thick post-form factory made Tops: Providing & fixing office tables straight/round with/without drawer and storage below of size 2'-4½" (wide), 2'-6" (high) with the provision of key board, with sliding channels of Ebco, complete shelf for CPU at bottom and foot rest. The table shall be made of 19mm thick (of Lexus / Burma / Unity make all conforming to ISI standards) commercial board, 1mm thick laminate (Merino, Century, Greenlam, .) with rubber -wood gola of size 1 ½" x ¾" polish, painting inside only, side golas etc., with hardware such as hinges, catchers and handles.	14	Rqft.		
(ii)	Side Racks with 1½" thick post-form factory made Tops: Providing and fixing side rack, 2'-3" ht. as per design. These racks shall have two drawers with storage below and be made of 19mm thick (of Lexus / Burma / Unity make all conforming to ISI standards) commercial board, 1mm thick laminate (Merino, Century, Greenlam, .) with rubber -wood gola of size 1 ½" x ¾" polish, painting inside only, side golas, handles, catchers, hinges etc.	15	Rft.		
2	Storage with 1½" thick post-form factory made Tops: Providing & fixing storage along wall 1'-4" deep made of 19mm thick (of Lexus / Burma / Unity make all conforming to ISI standards) commercial board, 1mm thick laminate (Merino, Century, Greenlam, .) inside painting, complete finished with goals, hardware etc., drawers, front openable shutters all lockable, handles, hinges as per requirements / design / drg.	120	Sft.		
3	Tables with 1½" thick post-form factory made Tops: Providing & fixing Manager table of size 6'-0" x 2'-9"/2'-3" x 2'-6" ht. (to be made as per detailed drg. with turn @ 45 degree) with rubber-wood Gola of size 1 ½" x ¾". as per drgs. With complete drawers, storage cabinet, key board, with sliding channels of Ebco, foot rest, space for CPU & Monitor, all as per drg. / design, the table shall be made with 19mm thick (of Lexus / Burma / Unity make all conforming to ISI standards) commercial board, 1mm thick laminate (Merino, Century, Greenlam, .) inside of table/rack shall be painted with synthetic paint, the other hardware, such as handles, locks, hinges etc. shall be complete in all respects.	6	Rft.		

4	Providing & Fixing Cash – counters 2'-9" wide, with two levels i.e. 2'-6" & 4'-0" ht. shall be made with 19mm thick (of Lexus / Burma / Unity make all conforming to ISI standards) commercial board, 1mm thick laminate (Merino, Century, Greenlam, .). The lower portion on cashier side there will be provision of 3 nos. drawers with sliding channels of Ebco. for cash, stationery, key board, etc. Inside of cash counters shall be painted with synthetic enamel paint as per color scheme, rubber - wood beadings / gola etc.	5	Rft.		
5	Providing & fixing writing stand of size 3'-0"x1'-0"x1'-7.5" high (face area) as per design drg. Made of 19mm thick (of Lexus / Burma / Unity make all conforming to ISI standards) commercial board, 1mm thick laminate (Merino, Century, Greenlam, .). with rubber wood lipping etc.	3	Rft.		
6(i)	Providing & fixing notice board of size 2'-6"x 4'-0" finished with Ivory colour 1mm th. laminate, 1"x1" th. rubber wood beading on all sides.	2	No		0
(ii)	Providing & fixing soft boards of size 3'-6"x 2'-0" (covered with openable glass shutters) on 10mm th. comm. ply 12mm th. soft board finished with cotton fabric , 1"x2" rubber wood beading.	1	No		0
(iii)	Providing & Fixing cheque drop box and complaint box of size 18" x 27" as per detail.	2	No		0
(iv)	Providing & supplying dressing table with mirror of size 1'-0"x5'-0" including sitting desk for lockers room.	0	No.		0
7	Providing & fixing server room: Counter 2'-3" wide & 2'-6" high with key board, storage cabinet below, drawers etc. complete hardware, shall be made with 19mm thick (of Lexus / Burma / Unity make all conforming to ISI standards) commercial board, 1mm thick laminate (Merino, Century, Greenlam). painting etc. complete in all respects as per drgs.	4	Rft.		0
7(i)	Providing and fixing 18mm thick MDF Jali computerized cut design in front of tables, counters, False ceiling and wall panels. Back side of this jali will have milky white acrylic sheet with yellow colored LED 4' long tube lights at every 2'-0" C/C in both directions.	0	Sqft.		0
	TOTAL				0
C	MISCELLANEOUS WORKS				
1	Pin-up board finished with cotton cloth & rubber wood beading.	24	Sqft.		
2	Providing and laying texture paint of "Heritage" Co. Granules type (in customers' area only) as per colour scheme.	350	Sqft.		
3	P/F vertical blinds of vista / Mac of approved shade / colour.	0	Sqft.		0
4	Providing and laying Vitrified tiles of size 605mm x 1200mm / 900 x 900 of Nitco/Johnson/Kazaria make to be laid on existing floor, over 20mm thick (or as much required for acheiving the constant level) cement sand mortar 1:4 including grouting the joints with white cement slurry mixed with matching pigment, complete in all respects including filling the depressions in floor, if any, as per approved pattern.	0	Sqft		0
5	Painting work on walls (internal / external walls) with special repairs & cemented ceiling, toilets, strong room, stationery pantry, with oil bound distemper paint and enamel paint on shutters and grills. (whole premises) Berger, Nerolac, Asian.	JOB	LS		
	TOTAL				0
D	ELECTRICAL WIRING				

9	ELECTRICAL POINTS : Providing laying, fixing & testing of electrical points including wiring fire retardant PVC insulated copper wire flame guard multi-strand copper conductor from MCB's to switches and switches to fixture, plate type switches, socket & M.S. Modular boxes with rust proof treatment size to accommodate the required nos. of switches & sockets plus circuit wiring from switches to lights/fans/fixtures etc. wherever required complete with earthing 1.00 mm ² multi strand wire in 25mm dia. Unbreakable PVC conduit ISI marked with specials under floor / wall & above false ceiling or making truff under / along work - stations including chase cutting, disposal of melba away from the site and repair of the same with cement mortar, copper conductor wires only will be used of approved make.				0
a)	Electrical wiring with metal clads to be fixed/embedded in wall for Air-Conditioning: P / F 32-Amp wiring with MCB from D/B to site of outdoor and indoor A/C Unit with 4mm sq. fire retardant PVC insulated copper wire flame guard multi-strand copper conductor, with 1 mm earth wire including metal clads.	5	No		
b)	Electrical wiring for UPS input-output with metal clads: P / F 32 Amp wiring with MCB 32 Amp. from D/B to the location of UPS/UPS room for input and output power supply (with 2 sets of 3-pin switch-socket of 15 Amp for each UPS) with 2 runs of 6mm sq. and one run of 1.5 sq. mm as earth wire fire retardant PVC insulated copper wire flame guard multi-strand copper conductor, with 4 Nos Metal-Clads.	10	No		
c)	15 Amp wiring with 2.5mm sq. fire retardant PVC insulated copper wire flame guard multi-strand copper conductor & metal clad enclosure sockets.	8	No		
d)	5 Amp plug point wiring with 1.5mm sq. fire retardant PVC insulated copper wire flame guard multi-strand copper conductor Plate switches, sockets, plugs Etc.	10	No		0
e)	Call-bell point wiring including Ding-dong bell with 1.5mm sq. fire retardant PVC insulated copper wire flame guard multi-strand copper conductor including plate switches, sockets, etc.	1	No		
f)	Electrical pts for Wall Fan (5amp. switch socket for wall fans), lights & exhaust fan point wiring with 1.5mm sq. from D/B to switches & fittings fire retardant PVC insulated copper wire flame guard multi-strand copper conductor including plate switches, sockets, etc. (For payment no. of switches shall be counted).	5	No		
10	<u>Wiring & fixing telephone point to be left from table to outside for the connection from BSNL or so:</u> Incl. Providing and fixing of PVC conduit in wall floor incl. Telephone cable, M.S. box and two pin telephone sockets on or R.J. - 11 plates out let incl. Testing and commissioning etc. as required.	4	No		
11	Signage wiring (material & labour) - P&F of 2x4mm and 1x1mm copper fire retardant PVC insulated copper wire flame guard multi-strand copper conductor PVC conduiting of ISI make complete with all accessories like Saddles, bends modular switches etc.	1	No		
TOTAL					0
E	ELECTRICAL FITTINGS & FIXTURES				
1	Providing & Fixing 2' x 2' recessed mounted LED Luminaire LCTLR-36-CDL of Crompton or panel light.	10	No		
2	Providing & Fixing 15 W LED ROUND DOWNLIGHTER LCND-15-CDL of Crompton.	15	No		0
3	Providing & fixing LED tube lights 1x36W of Phillips.	6	No		
4(i)	Providing & Fixing wall fans: Crompton Greaves / Orient / Bajaj / Havells.	10	No		0
(ii)	Exhaust Fans 12" Dia: 1400 rpm (Double ball bearing) Heavy duty Crompton Greaves / Orient / Bajaj / Havells.	1	No		0
(iii)	Providing & Fixing ceiling fans: Crompton Greaves / Orient / Bajaj / Havells. 4' dia.	0	No		0
(iv)	Cost of modular regulators of Havells / Anchor ROMA makes.	0	No		0

5	Providing and fixing 10 way D/B for Telephone distributions.	0	No		0
6	Providing & fixing main electrical dist. Board duly earthed, with all internal electrical and generator connections with 10 sq.mm multi strand copper wire, all hardware nickel coated, which shall include the following items:				0
(i)	Amp Meter and voltmeter set	1	SET		
(ii)	Kit-kats 100 Amp.	3	No		0
(iii)	Aluminum bus bar 100 Amp proper tinned.	1	No		
(iv)	100 Amp. Main switch MCCB type.	1	No		0
(v)	Change -over 63 Amp. 3-Phase of Havells make.	1	No		0
(vi)	Providing and fixing different rated MCB,s for lights, fans, power supply and AC's. of Havells make.	18	No		0
(vii)	Providing and fixing TPN's of 100 Amp of Havells make.	1	No		
(viii)	Making double-door powder coated M.S. Distribution board 3'x3' to accommodate the above noted electrical items.	9	Sqft.		0
	UPS SUPPLY	0			0
(ix)	Providing and fixing (MCB type) DP of 63 Amp of Havells make for UPS supply.	6	No		
(x)	Providing and fixing different rated MCB,s for UPS supply of Havells make.	12	No		0
(xi)	P/F single phase 8-way D/B (Quote the cost of Box only) for UPS supply for MCB's.	2	No		0
7(i)	Providing & fixing main electrical cable 4- core al. cable armored from elect. pole to meter 35mm dia.	20	Mtr		
(ii)	P/F generator wire/cable 16mm 4-core Alum. Cable armoured.	30	Mtr		0
(iii)	P/F 16mm 4-core Alum. Cable from bus-bar to ATM.	10	Mtr		
8	MASTER SWITCHES: 10 way double door Single phase MCB Box fitted with: i) 63 Amp TPN isolators: 2 Nos. ii) 32 Amp DP: 1 No. to be installed at the main gate of the Bank to switch off main supply for lights, power/AC's and UPS supply (output) except router, Camera and UPS's Charging lines. Complete wiring with 4x6 sqmm multistrand PVC copper wire for the above said MASTER SWITCHES.	0	SET		0
9(i)	P/L copper pipe with 2.5 mm fire retardant PVC insulated copper wire flame guard multi-strand copper conductor complete insulation upto outdoor unit required for 1.5 ton split type A.C.s from the place of external units upto the location of inside units.	100	Rft.		
(ii)	Providing and laying 25mm dia. PVC pipe heavy duty Diplast make for drainage of water of inside units.	40	Rft.		0
	TOTAL				0
F	DATA-CABLING, & UPS CABLING				
1	UPS POINTS: P/L & testing electrical three point wiring /circuit wiring having individual circuits for computers with 2.5mm ² fire retardant PVC insulated copper wire flame guard multi-strand copper conductor in unbreakable PVC conduits 25mm dia wall thickness 2mm thick with specials under floor / wall & above false ceiling including chase cutting, disposal of malba away from the site and repair of the same with cement mortar, incl. Switches & socket M.S. switch boxes with rust proof treatment size to accommodate the required nos. of Modular switches, sockets etc. & plate type sockets with indicator three in one plate including earthing with 1.00 mm ² fire retardant PVC insulated copper wire flame guard multi-strand copper conductor complete in all respect.				0
i)	Set of 6 amp. 4 sockets & 1 switch (Set of 4 Sockets shall be provided under the table and switch of these four sockets shall be provided on the above / side of table for easy access). Note: -The server shall have 2 sets of "output supply" from individual UPS.	15	Sets		

(ii)	UPS supply to tube lights: Point wiring / circuit wiring with 1.5mm sq. fire retardant PVC insulated copper wire flame guard multi-strand copper conductor from D/B to switches & fittings multi strand PVC copper wire including plate switches, sockets, etc. (for payment no. of switches shall be counted)	4	No		
(iii)	Providing and fixing 16 Amp 3-pin power tops with 4.00 mm ² copper wire for UPS in-put	2	No		
2	GEL TYPE CHEMICAL EARTHING (Distance between each pit shall be min 1.5meter) (Generator + UPS + Raw Power = 3 nos) Supplying and installation of copper Gel Earthing station having length 3000 mm including bore-well, chamber with cover and all required civil allied works each earth pit to filled with 2 bags in 30 Kg pack of "Black-Fill Compound" (BFC) EARTHING CONDUCTORS: Wiring with 1x10 sqmm PVC insulated copper conductor wire of 650/1100 volts grade (Finolex make flame guard quality) as earth wire with concealed/exposed PVC pipe including making all the connections.	1	No		
3(i)	Providing, laying, testing and commissioning CAT-VI/ Lucent / D-link computer networking cable in PVC conduit in floor or wall from server room to each table with I.O.'s (Socket)	15	No		
(ii)	Supplying of patch chords for computers 1m & 2m length.	15	No		
4(i)	Providing & fixing, testing and commissioning existing 24-port switch and patch panel / M.S. rack	1	No		
TOTAL					0
ATM					
1	Providing & fixing in position false ceiling in Armstrong 600 x 600 mm x 15/16 mm Dune Supreme RH 99 Prima tile as specified by Armstrong Co. with suspenders wherever required. Making necessary framework for A.C. ducting, if any, and necessary cutouts for diffusers and light fittings, taping and finishing to proper line & level, including making grooves and trap doors for A.C unit in 18mm thick M.R. Grade Plywood with Stainless Steel hinges & locks with moulding 1" x 1" for edges, if any including finishing with White Plastic Emulsion Paint etc. complete in all respects. (Note: - Only the plan area will be measured for payment. No extra payment will be made for cutouts, grooves, mouldings, steps or any type of design etc.)	60	Sqft		
2	Providing & fixing Aluminum partitions / window (powder coated of size 3 1/4" x 1 1/2" x 2mm bottom section 4" x 1 3/4" x 2mm th. with 5mm th. glass. And aluminum door: 3'-0"X7'-0" powder coated having; External frame called chowkhat: 3 1/4" x 1 1/2" x 2mm thick, Internal door frame and lock rail: 3 1/4" x 1 3/4" & Bottom rail: 4" x 1 3/4" with 5mm thick etched glass as per design. including all fittings such as al. handles, locks, stopper, tower bolts, etc.	50	Sqft		
3	Black granite slab - P&F black granite slab 18-20 mm thick fixed to entrance door steps with grinding, moulding and polishing.	0	Sqft		0
4a	Providing & fixing in position Aluminium Composite Paneling, rolling shutter box (ACP) with framing of Aluminium Tube sections of min 1.5" * 1" and 18 gauge 2'-0" C/C both ways. ACP to be in 2' width panels or distributed equally. Panels to be fixed to the frame with 3M or equivalent adhesive. Joints to be finished with Silicon based sealant (Black colour). ACP thickness of 3mm minimum. Aluminium foil thickness to be min 0.20 mm on both sides. Alstrong, ALEX, Alstone, Alcobond, prime bond or equivalent ISO certified or approved brands to be used. Shades to be as per bank's approval. It has to be used for cladding, boxing over main door and both side Jam of main door and fixed glazing. Complete panelling should be of ACP.	400	Sqft		
b	P/F partition with bothside ACP	50	Sqft		0
5	Grouting of ATM Machines with Anchor fastener as per Bank's rules, (Including the cost of RCC 12" slab	0	NO		0

6	Providing & Fixing Flooring with vitrified tiles joint - free of minimum 9 mm thickness , size 24" X 24" , 4 " Skirting , all fixed in 1:5 cement mortar, complete with cutting and filling joints with white cement. Make of tiles Johnson/bell/euro/asian /nitco/naveen/somanl or equivalent. Ivory / shade or as specified by the bank.	0	Sqft		0
7	P/F cheque drop box-cum-writing top having 12mm th glass top.	1	NO		
8	P/F acrylic notice board of size 2'x3' with chrome spacers.	1	NO		
9	Providing and supplying plastic dust bin and chair.	1	Set		
10	P/F Aircon louvers powder coated of size 12" long.	2	Sqft		
	TOTAL				0
	ELECTRICAL WORKS FOR ATM:				
11	Signage & A/C wiring : P&F of 3x4mm & copper flexible wire & PVC conduit of ISI make, bends etc.	3	NO		
12	Connectivity from server/dish Antenna: P&F of 40mm PVC conduit of ISI make including data cable of D-link (Cat-VI) & RJ-45, complete for connectivity. (to be concealed with openable and lockable box)	2	NO		
13	Providing & Fixing 2' x 2' recessed mounted LED Luminaire LCTLR-36-CDL of Crompton.	1	NO		
14	Providing & Fixing 15 W LED ROUND DOWNLIGHTER LCND-5-CDL of Crompton.	5	NO		
15	Providing & fixing ordinary tube lights 1x40W of Phillips.	1	NO		
16	GEL TYPE CHEMICAL EARTHING (Distance between each pit shall be min 1.5meter) Supplying and installation of copper Gel Earthing station having length 3000 mm including bore-well, chamber with cover and all required civil allied works each earth pit to filled with 2 bags in 30 Kg pack of "Black-Fill Compound" (BFC) EARTHING CONDUCTORS: Wiring with 1x10 sqmm PVC Insulated copper conductor wire of 650/1100 volts grade (Finolex make flame guard quality) as earth wire with concealed/exposed PVC pipe including making all the connections.	1	NO		
17	Lights point wiring from UPS (2 lights points and one access lock wiring) and rest shall be be connected with raw power supply with 1.5mm sq. from D/B to switches & fittings multi strand PVC copper wire including plate switches, sockets, etc. (For payment no. of switches shall be as per schedule)	8	NO		
18	Electrical wiring for UPS input-output: P / F 32 Amp wiring with with 2 DP's of 32 Amp. from D/B to the location of UPS/UPS room for input and output power supply with 2 runs of 4mm sq. and one run of 1.5 sq. mm as earth wire multi-strand PVC copper wires, with DP switches / power pt. i.e. switch-socket.	1	NO		
19	P/L & testing electrical three point wiring having individual circuits for computers with 2.5mm ² Multi-strand copper PVC wire in unbreakable PVC conduits 25mm dia wall thickness 2mm thick with specials under floor / wall & above false ceiling Including chase cutting, disposal of melba away from the site and repair of the same with cement mortar, incl. Switches & socket M.S. switch boxes with rust proof treatment size to accommodate the required nos. of Modular switches, sockets etc. & plate type sockets with indicator three in one plate including earthing with 1.00 mm ² multi strand wire complete in all respect. Set of 6 amp./16 1 socket & 1 switch (to be concealed with openable and lockable box)	2	SETS		
20	15 Amp wiring with 2.5mm sq. multi strand PVC copper wire & metal clad enclosure sockets & plus.	1	No		
21	5 Amp plug point wiring with 1.5mm sq. multi stand PVC copper wire inc. Plate switches, sockets, plugs, Etc.	1	NO		
22	P/L copper pipe with complete insulation required for 1.5 ton split type A.C.s from the place of external units upto the location of inside units.	30	Rft		

23	Providing and laying 25mm dia. PVC pipe heavy duty Diplast make for drainage of water of inside units.	20	Rft		
24	Supplying, erection and commissioning of timer switch 240-volt single phase for AC	1	No		
25	P/F M.S. D/B 2'x2' with MCB's and TPN of Havells make with MCB,s 10 Amp. to 16 Amp./20 Amp./32 Amp for supply lights, AC's glow sign Board	1	No		
26	Supplying, erection and commissioning of timer switch 240 volt single phase with 32 Amp single phase MCB 40 Amp. DP contactor: for Glow-sign board	1	No		
	TOTAL				0
	FURNISHING WORKS OF ATM				0
	ELECTRICAL WORKS OF ATM				0
	TOTAL OF ATM				0
	SUMMARY OF COSTS				
A	FURNISHING WORKS				0
B	FURNITURE & FIXTURE				0
C	MISCELLANEOUS WORKS				0
D	ELECT WIRING				0
E	ELECTRICAL FITTINGS & FIXTURES				0
F	DATA-CABLING WORKS				0
	TOTAL OF BRANCH				0
1	TOTAL OF BRANCH				0
2	TOTAL OF ATM				0

 इंडियन बैंक Indian Bank इलाहाबाद ALLAHABAD	अंक : लुधियाना एससीएफ-88, अर्बन एस्टेट, फेज-1, डुगरी लुधियाना 141013	ZO: Ludhiana SCF-88, Urban Estate, Phase-I, Dugri Ludhiana-141 013
	ईमेल E-mail: zoludhiana@indianbank.co.in 0161-5232104.07 FAX:0161-5232100 वेबसाइट Website: www.indianbank.in	

Zonal Office Ludhiana

NOTICE INVITING TENDER

**Sub: COMPETITIVE QUOTATION FOR FURNISHING & ELECTRICAL WORK
Of Bhoura Branch & ATM , Distt.Ludhiana Under ZO Ludhiana**

Competitive Sealed Quotations are invited in the prescribed format from the Contractors who are already empanelled with Bank having Electrical Works License and executed Interior Furnishing & Electrical Works of Nationalized Banks in last three years.

Format of Quotation Document is enclosed for submission of Furnishing & Electrical works of Bhoura Branch & ATM, Distt. Ludhiana. Full details and tender documents are available on Bank's website: www.indianbank.co.in or can be obtained from Zonal Office, Ludhiana Duly filled in tenders should be submitted as per following schedule:

1	Issue of Tender Document	From 07.02.2023 to 17.02.2023
2	Submission of Tender	On or before 17.02.2023 up to 04:00 PM
3	Opening of Tender	On 20.02.2023 at 03:00 PM
4	Date of Commencement	7 Days from the date of issue of letter awarding the job.
5	Time of Completion	20 days
6	Defect Liability Period	12 Months
7	Earnest Money	Rs.5000/- for furnishing & Rs. 5000 for Electrical Work in the form of DD/IOI in favour of Indian Bank payable at Ludhiana.
8	Liquidated Damages for delay	Rs.2000/- per day subject to Max. of 10% of total accepted contract amount. (If the work is not completed to the satisfaction of the Employer within the stipulated period, the contractor shall be bound to pay to the Employer a sum equivalent to Rs.2000/- per day subject to ceiling of 10% of the accepted contract amount by way of liquidated damages and not as penalty during which the work remains un-commenced or unfinished after expiry of the completion date.)
9	Payment Terms	Neither any advance nor any Interim payment will be made. Payment will be made on satisfactory completion of the job on the basis of actual measurements. Income tax will be deducted as per the rules. Retention money 10% will be deducted from the bill and to be released after 12 months from the date of virtual completion provided no defects is observed during this period.
10	Documents to be attached with the Bill	Managers Completion Certificate, Manufacture Certification, Bills & 4-5 Photographs showing completion status of work.
11.	Retention Money	10% (Including Earnest Money)

The Bank will not be bound to accept the lowest tender and reserves the right to accept or reject any or all the tender without assigning any reason whatsoever. Late/delayed tender shall not be accepted after due date and time of submission of tender.

For any assistance please contact our panel architect M/s Creative Visions contact no. 0172-2550637 & 09216585700 & email id info@creativevisions.in

(Deputy General Manager)

CLIENT

INDIAN BANK

ZONAL OFFICE, Ludhiana - PREMISES DEPARTMENT
Sco-88 urban estate phase-1
Dugri Ludhiana 141013

WORK / PROJECT

PROPOSED ELECTRICAL WORKS AT
INDIAN BANK, BHOORA, DISTT. LUDHIANA

COMPETITIVE QUOTATION
FOR ELECTRICAL WORKS AT ABOVE PROJECT

Tender Issued to:

M/S _____

Address _____

Contact No: _____

Tender Issued on: _____

Last Date of Submission: _____

Signature of the Contractor

Seal



Zonal Office Ludihana

NOTICE INVITING COMPETITIVE QUOTATION

**Work: COMPETITIVE QUOTATION FOR FURNISHING & ELECTRICALS WORK
Of Bhoura (DISTT. Ludhiana) Branch, UNDER ZO Ludhiana**

General terms & Conditions:-

- 1) Sealed quotation should be addressed to The DGM, Indian Bank, Zonal Office, Ludhiana and super scribed name of Work FURNISHING & ELECTRICAL WORK Of Bhoura Branch, (Distt. Ludhiana) and should reach before 4:00 p.m. on 17.02.2023 at Zonal Office Ludihana.
Mailing Address:
The Deputy General Manager,
Sco-88 Urban Estate phase-1
Dugri
Ludihana- 141013
- 2) No quotation will be accepted after 4:00 pm on 17.02.2023 and quotations will be opened on 20.02.2023 at 3:00 pm unless otherwise informed.
- 3) The quotations will remain valid for a period of 3 months from the date of opening.
- 4) Bank reserves the right to accept or reject any or all the quotations accept part of any tender, entrust the entire work to any contractor or divide the work to more than one contractor (item wise) without assigning any reason to do so or giving any explanation. The rates quoted by the contractors will help well for bifurcation and no compensation will be paid on this account.
- 5) At the time of submission every quotation must be accompanied by IOI/ Demand Draft for an amount of Rs.5000/- in favor of INDIAN BANK payable at Moradabad towards EMD. Any quotation which is not accompanied by EMD will be summarily rejected.
- 6) Contract should quote rates in figures as well as in words.
- 7) All erasures and alterations made must be attested with the initials of tenderers. No overwriting is permitted.
- 8) The EMD of the unsuccessful bidders will be returned within 45 days from the date of opening the tender.
- 9) Joint tenders shall not be considered. Conditional tenders quoted by the contractor are liable to be rejected.
- 10) No escalation in the rates will be allowed under any circumstances.
- 11) On receipt of the intimation from the bank of the acceptance of his quotation, the contractor should submit his acceptance within 3 days. If the successful contractor/ tenderer fail to undertake the work within 7 days after work allotment, the EMD will be forfeited and acceptance of his tender may be withdrawn.
- 12) The rate quoted in the tenders shall be inclusive of all materials as required and shall be inclusive of all charges of scaffoldings, lifting, tools and plants, freights/ transportation, labor conditions and fluctuations in rates of excise duty, octroi, GST, VAT, Excise Duty, service tax and any other taxes or expenditure of carrying out the works.
- 13) The Agency is advised to inspect and examine the sites and satisfy himself as to the condition prevailing at sites and its surrounding extent of work, scope and

conditions under which the work is to be executed. The contractor shall also satisfy himself about the accessibility to the premises.

- 14) The agency shall submit the offer which satisfies each and every condition laid down in this notice, failing which the tender will be liable to be rejected. Conditional bids shall not be considered and will be out rightly rejected in the very first instance.
- 15) Work will be completed within the period of 20 days from the date of issue of tender or work order whichever is earlier. If the work be not completed to the satisfaction of employer within the stipulated period, the contractor will be bound to pay to the Employer a sum equivalent to Rs.2000/- per day subject to ceiling of Max 10% of the accepted contract amount by way of liquidated damages and not as penalty during which the work remains un-commenced or unfinished after expiry of the completion date. The contract may be rescind by giving one week notice incase work is not executed as per specification and as per time schedule given in tender document.
- 16) The liquidated damages as mentioned in the Notice inviting tender may not be enforced if the contractor applies for extension of time mentioning the genuine reasons for extension. If an extension of time of completion of the work is sought on the grounds of having unavoidable hindrances in its execution or any other ground, the contractor shall apply in writing to the Assistant General Manager, Zonal Office, Moradabad with full details of the circumstances which is causing such an extension. Extension of time in days will be granted by the bank if it is proved that the contractor is not at fault for extending the work beyond stipulated date of completion. All the decisions in this regard taken by the Bank shall be binding to the contractor.
- 17) The successful contractor is bound to carry item of work necessary for completion of job even though the same are not included in the schedule of quantity. Rates of extra item will be derived from quotation. In case the rates do not exist in quotation and extra item is not similar to the quoted item, then the rates will be worked out on actual cost of material and labour, any other expenditure for completing that work plus 15% towards contractors profit and overheads.
- 18) The work shall be carried out in such a way that, there is least disturbance to the staff of Bank. Contractors are required to organize the work in such a way that workings of staff and officers/executives of Office are not affected. Contractor is required to take adequate care during progress of work to protect belongings. In case any damage, contractors at their own cost shall make the same good.
- 19) The contractor must co-operate with other contractors appointed by the bank so that entire work shall proceed smoothly and to the complete satisfaction of the Bank.
- 20) Contractor will arrange necessary tools and plants for completing own work at their cost. In case of any accident the total responsibility will be on the contractor. Contractors are required to submit time schedule of work. After completion of work, cleaning of floors, walls etc are to be done on daily basis to the satisfaction of Branch Head / engineer-in-charge. After completion of jobs, the site shall be cleared of all rubbish malba /debris etc in all respect and handover the site in proper manner on completion of the work.
- 21) No advance will be paid. Payment will be released on satisfactory completion of job and submission of bills. Retention Money @10% will be deducted from the bill and to be released after twelve months from the date of virtual completion provided no defects is observed during the period.
- 22) In case of non-completion or delay in completion of work or removal of defects in time, the bank shall be free to appoint another agency to get the job done at contractors risk and cost.

- 23) The contractor will attend to all the defects noticed during defect liability period. If the contractor fails to attend the defects these defects will be got rectified by the bank and the expenditure incurred on this account will be recovered from security deposit / retention money.
- 24) The work shall be got approved by the Architect / engineer and the contractor shall rectify any bad workmanship pointed out at any stage and remove from the site all the rejected materials immediately at his own cost.
- 25) The contractor shall acquaint himself with the site conditions making his own arrangements for storing of materials at site, lift, cartage etc. at his own risk and safety.
- 26) The contractor shall make adequate arrangement for watch and ward of material and shall ensure the safety, breakage and any theft of material fixed or unfixed by him or the other sub contractors. The bank shall not be liable for any sort of loss incurred.
- 27) The contractor shall be responsible for application of labour laws, compensation for injury and accident to person, whether employed by him or his sub-contractor.
- 28) The contractor shall ensure that the workmen employed by him for the execution of work are suitably covered against Workmen Compensation Act and that all liabilities arising out of Workmen's compensation Act, ESIS and other legislative enactment applicable to such works and workmen shall be to the contractor's account and responsibility.
- 29) Civil, Interior Furnishing and Electrical Works will be carried out as per Bank's standard drawing / specifications and to the entire satisfaction of the bank.
- 30) The contractor shall inform the bank, well in time, to check measurements of any work, which is likely to be hidden before covering.
- 31) Income tax at the prevailing rates will be deducted at source from contractor's bill and will be deposited with I.T.O. as per rules.
- 32) Any extra work or item can only be started by contractor after obtaining written approval from the Zonal Office. Item executed without prior approval from the Zonal Office will not be considered for payment.
- 33) The quantities mentioned in the schedule of quantities are approximate. Payment will be made on the actual work done by the contractor. However the contractor should not deviate the quantity without Banks permission.
- 34) The Bank has the right to alter the nature of work and to add or omit any items of work or to have the option of the same carried out departmentally or otherwise and such alterations or variations shall be carried out without prejudices to the contract.
- 35) The Bank has the right to terminate the contract if the contractor abandons the work or fails to commence the work in time, or fails to abide by the terms & conditions of the contract.

I have read and understood all the instructions/conditions given above and I have taken into account the above instructions/conditions while quoting the rates.

Date:

(SIGNATURE OF THE CONTRACTOR)

Place:

SEAL

Seal & Signature of Contractor