

Zonal Office:Lakhimpur Kheri

NOTICE INVITING QUOTATION

Sub: COMPETITIVE QUOTATION FOR INTERIOR FURNISHING, ELECTRICAL AND DATA CABLING WORK AT NEW PREMISES OF RUDRAPUR BRANCH UNDER LAKHIMPUR KHERI ZONE

Competitive sealed quotations are invited in the prescribed format from the contractors who are already empanelled with bank executed interior furnishing of nationalized Banks in last three years.

Formats of quotations document is enclosed for submission of interior furnishing, electrical and data cabling work at new Premises of Rudrapur branch Distt-Lakhimpur Kheri. Full details and quotation document are available in Bank's website www.indianbank.co.in or can be obtained from Zonal Office Lakhimpur Kheri. Duly filled quotations along with duly signed enclosed general terms and conditions should be submitted as per following schedule:

1	Issue of Quotation Document	From 24.01.2023 to 08.02.2023
2	Submission of Quotation	On or before 08.02.2023 up to 3:00PM
3	Opening of Quotation	On 09.09.2022 at 11:00 AM
4	Date of Commencement	7 Days from the date of issue of letter awarding the job
5	Time of Completion	20 days
6	Defect Liability Period	12 Months
7	Earnest Money	Rs.5000/- in form of DD/IOI in favour of Indian Bank payable at Lakhimpur Kheri
8	Liquidated Damages for delay	Rs.2000/- per day subject to Max. of 10 % of accepted contract amount. (If the work is not completed to the satisfaction of the Employer within the stipulated period the contractor shall be bound to pay to the employer a sum equivalent to Rs. 2000/- per day subject to ceiling of 10% of the accepted contract amount by way of liquidated damages and not as penalty during which the work remains un-commenced or unfinished after expiry of the completion date).
9	Payment Terms	Neither any advance nor any running payment will be made. Payment will be made on satisfactory completion of the job on the basis of actual measurements. Income tax will be deducted as per the rules. Retention money 10% will be deducted from the bill and will be released after 12 months from the date of actual completion of the work provided no defect is observed during this period.
10	Document to be attached with the Bill	Completion Certificates issued by Project architect along with the certificate that materials used are as per specification mentioned in the quotation document and Completion Certificates issued by Branch Manager & 4-5 photographs showing completion status of work. Bill must be verified by project architect.
11	Retention Money	10% (Including Earnest money)

The Bank will not be bound to accept the lowest quotation and reserves the right to accept or reject any or all the quotations without assigning any reason whatsoever. Late/delayed quotation shall not be accepted after due date and time of submission of quotation.

Zonal Manager



Zonal Office: Lakhimpur Kheri

NOTICE INVITING COMPETITIVE QUOTATION

Work: COMPETITIVE QUOTATION FOR INTERIOR FURNISHING, ELECTRICAL AND DATA CABLING WORK AT NEW PREMISES OF RUDRAPUR BRANCH UNDER LAKHIMPUR KHERI ZONE

General terms & Conditions:- (To be signed by the contractor and enclosed with the quotation)

- 1) Sealed quotation should be addressed to The Zonal Manager, Indian Bank, Zonal Office Lakhimpur Kheri and super scribed name of Work **Furnishing, Electrical & Data Cabling Work at new Premises of Rudrapur Branch, Distt- Lakhimpur Kheri** and should reach before 3:00 p.m. on or before 08.09.2022 at Zonal Office Lakhimpur Kheri.

MailingAddress:

The ZonalManager,
Indian Bank
Zonal Office,Lakhimpur Kheri
Radhey Complex, Kachahary Road,
Lakhimpur Kheri-262701 (U.P)

- 2) No quotation will be accepted after 3:00 pm on 08.09.2022 and quotations will be opened on 09.09.2022 at 11:00 AM unless otherwise informed.
- 3) The quotations will remain valid for a period of 3 months from the date of opening.
- 4) Bank reserves the right to accept or reject any or all the quotations accept part of any quotation, entrust the entire work to any contractor or divide the work to more than one contractor (item wise) without assigning any reason to do so or giving any explanation. The rates quoted by the contractors will help well for bifurcation and no compensation will be paid on this account.
- 5) At the time of submission every quotation must be accompanied by IOI/ Demand Draft for an amount of Rs.5000/- in favour of INDIAN BANK payable at Lakhimpur Kheri towards EMD. Any quotation which is not accompanied by EMD will be summarily rejected.
- 6) Contract should quote rates in figures as well as in words.
- 7) All erasures and alterations made must be attested with the initials of contractor. No overwriting is permitted.
- 8) The EMD of the unsuccessful contractor will be returned within 45 days from the date of opening of the quotation.
- 9) Joint quotations shall not be considered. Conditional quotations quoted by the contractor are liable to be rejected.
- 10) No escalation in the rates will be allowed under any circumstances.
- 11) On receipt of the intimation from the bank of the acceptance of his quotation, the contractor should submit his acceptance within 3 days. If the successful contractor fails to undertake the work within 7 days after work allotment, the EMD will be forfeited and acceptance of his quotation may be withdrawn.
- 12) The rate quoted in the quotations shall be inclusive of all materials as required and shall be inclusive of all charges of scaffoldings, lifting, tools and plants, freights/ transportation, labour conditions and fluctuations in rates of excise duty, octroi, GST, VAT, Excise Duty, service tax and any other taxes or expenditure of carrying out the works.
- 13) The Agency is advised to inspect and examine the sites and satisfy himself as to the condition prevailing at sites and its surrounding extent of work, scope and conditions under which the work is to be executed. The contractor shall also satisfy himself about the accessibility to the premises.

- 14) The agency shall submit the offer which satisfies each and every condition laid down in this notice, failing which the quotation will be liable to be rejected. Conditional quotations shall not be considered and will be outrightly rejected in the very first instance.
- 15) Work will be completed within the period of 15 days from the date of issue of quotation or work order whichever is earlier. If the work is not completed to the satisfaction of employer within the stipulated period, the contractor will be bound to pay to the Employer a sum equivalent to Rs.2000/- per day subject to ceiling of Max 10% of the accepted contract amount by way of liquidated damages and not as penalty during which the work remains uncommenced or unfinished after expiry of the completion date. The contract may be rescinded by giving one week notice in case work is not executed as per specification and as per time schedule given in quotation document.
- 16) The liquidated damages as mentioned in the Notice inviting quotation may not be enforced if the contractor applies for extension of time mentioning the genuine reasons for extension. If an extension of time of completion of the work is sought on the grounds of having unavoidable hindrances in his execution or any other ground, the contractor shall apply in writing to the Zonal Manager, Zonal Office Lakhimpur Kheri with full details of the circumstances which is causing such an extension. Extension of time in days will be granted by the bank if it is proved that the contractor is not at fault for extending the work beyond stipulated date of completion. At the decision in this regard taken by the Bank shall be binding to the contractor.
- 17) The successful contractor is bound to carry item of work necessary for completion of job even though the same are not included in the schedule of quantity. Rates of extra item will be derived from quotation. In case the rates do not exist in quotation and extra item is not similar to the quoted item, then the rates will be worked out on actual cost of material and labour, any other expenditure for completing that work plus 15% towards contractor's profit and overheads.
- 18) The work shall be carried out in such a way that, there is least disturbance to the staff of Bank. Contractors are required to organize the work in such a way that workings of staff and officers/executives of Office are not affected. Contractor is required to take adequate care during progress of work to protect belongings. In case any damage, contractors at their own cost shall make the same good.
- 19) The contractor must co-operate with other contractors appointed by the bank so that entire work shall proceed smoothly and to the complete satisfaction of the Bank.
- 20) Contractor will arrange necessary tools and plants for completing the work at their own cost. In case of any accident the total responsibility will be on the contractor. Contractors are required to submit time schedule of work. After completion of work, cleaning of floors, walls etc are to be done on daily basis to the satisfaction of Branch Head / engineer-in-charge. After completion of jobs, the site shall be cleared of all rubbish / debris etc in all respect and handover the site in proper manner on completion of the work.
- 21) No advance will be paid. Payment will be released on satisfactory completion of job and submission of bills. Retention Money @10% will be deducted from the bill and to be released after twelve months from the date of actual completion of the work provided no defects are observed during the period.
- 22) In case of non-completion or delay in completion of work or removal of defects in time, the bank shall be free to appoint another agency to get the job done at contractor's risk and cost.
- 23) The contractor will attend to all the defects noticed during defect liability period. If the contractor fails to attend the defects these defects will be got rectified by the bank and the expenditure incurred on this account will be recovered from security deposit / retention money.
- 24) The work shall be got approved by the Architect / engineer and the contractor shall rectify any bad workmanship pointed out at any stage and remove from the site all the rejected materials immediately at his own cost.
- 25) The contractor shall acquaint himself with the site conditions making his own arrangements for storing of materials at site, lift, cartage etc. at his own risk and safety.
- 26) The Contractor shall make adequate arrangement for watch and ward of material and shall ensure the safety, breakage and any theft of material fixed or unfixed by him or the other sub-contractors. The bank shall not be liable for any sort of loss incurred.
- 27) The contractor shall be responsible for application of labour laws, compensation for injury and accident to person, whether employed by him or his sub-contractor.

- 28) The contractor shall ensure that the workmen employed by him for the execution of work are suitably covered against Workmen Compensation Act and that all liabilities arising out of Workmen's compensation Act, ESIS and other legislative enactment applicable to such works and workmen shall be to the contractor's account and responsibility.
- 29) Civil, Interior Furnishing and Electrical Works will be carried out as per Bank's standard drawing / specifications and to the entire satisfaction of the bank.
- 30) The contractor shall inform the bank, well in time, to check measurements of any work, which is likely to be hidden before covering.
- 31) Income tax at prevailing rates will be deducted at source from contractor's bill and will be deposited with I.T.O. as per rules.
- 32) Any extra work or item can only be started by contractor after obtaining written approval from the Zonal Office. Item executed without prior approval from the Zonal Office will not be considered for payment.
- 33) The quantities mentioned in the schedule of quantities are approximate. Payment will be made on the actual work done by the contractors. However the contractor should not deviate the quantity without Bank's permission.
- 34) The Bank has the right to alter the nature of work and to add or omit any items of work or to have the option of the same carried out departmentally or otherwise and such alterations or variations shall be carried out without prejudices to the contract.
- 35) The Bank has the right to terminate the contract if the contractor abandons the work or fails to commence the work in time, or fails to abide by the terms & conditions of the contract.

I have read and understood all the instructions/conditions given above and I have taken into account the above instructions/conditions while quoting the rates.

Date:

(Signature of the Contractor)

Place:

Seal

BLANK B.O.Q OF ELECTRICAL WORK FOR INDIAN BANK AT RUDRAPUR BRANCH					
B	SCHEDULE - 'B' (ELECTRICAL WORK)				
SL No	PARTICULARS	UNIT	QTY	RATE	AMT
1	ELECTRICAL WIRING & EARTHING				
1.1	Supply, laying, connection & testing of light, fan point, wiring by 2x1.5mmsq(2x3/.029) + 1x1mmsq PVC insulated, multistrand single core copper conductor FRLS wire maintaining the colour code as per direction in PVC conduit of 20mm with ISI mark 1.5mm thickness to conceal in wall partition mending good the damage, complete with PVC circular box, bend to be done as per drawing including 3 point ceiling rows wherever required GI saddle to be used for fixing, metal flexible/PVC flexible pipe may use if required in partition wall. All PVC pipes should be with ISI mark. No joints will be allowed inside pipe, light, fan & plug point complete with modular type switch plate & MS box . rate Including the main circuit line 2x2.5mmsq+1x1.5mmsq earth PVC insulated Cu. Wire from DB to switch board , maintaining the colour code. Circuit line for lighting switch board & 6Amps plug board are to be drawn from lighting DB to Lighting board & plug point board (independent), 6/16 Amps plug point line are to be draw from power DB.as per DB schedule /SLD				
	a) 1 light by 1 switch	Nos.	14		
	b) 2 light by 1 switch	Nos.	17		
	c) 3 light by 1 switch	Nos.	0		
	e) Ceiling fan point with step type electronic regulator	No	2		
	f) Same as above, but for exhaust fan excluding regulator.	No	3		
	g) Same as above 5A Point in the switchboard itself. (for branch 4 No & ATM 1 No)	No	6		
	h) same as above Wiring for call-bell point including buzzer	No	1		
	i) Wiring (2x2.5mmsq+1x1.5mmsq from power DBs) for independent 6A multi pin socket at walls along with 6A modular type switches board housed in painted MS box (upto 3 independent plug points can be taken in one circuit) For wall Fan	No	9		
1.2	Supply and installation of modular type 2 nos 6A & multi pin sockets with 2 nos 6 Amp one way switch housed in MS box to be fixed in partitions or concealed in wall. The box shall be painted with 2 coats of enamel paint over a coat of red oxide primer including wiring for Raw power socket outlet using 2 R runs of 2.50 Sqmm and single run of 1.5 sqmm PVC insulated multi stranded single core copper conductor FRLS wire in 20mm PVC conduit to be laid in floor, partitions, etc. complete with all accessories (looping 2 sets of 2x6A socket outlet in one circuit- from DB) (Raw power). for counter (Each counter 1 Nos +BM :2 Nos, ATM 1No:, Pantry 1No.:	No	8		

1.3	Supply and installation modular type 16A, 5-pin socket with 16A one way switch housed in MS box to be fixed in partitions or concealed in wall. The box shall be painted with 2 coats of enamel paint over a coat of red oxide primer , the rate shall include wiring fusing 2R 4.0 sqmm & single run of 2.5 sqmm PVC insulated multi stranded single core copper conductor FRLS wire in 25mm PVC conduit to be laid in floor, partitions, etc complete with all accessories (for line printer : or optional).(upto 2 independent plug points can be taken in one circuit) C.C :1No. BM.;1 No.: Alternative counter 2No + Banking Hall 1 No+ Pantry 1No ,ATM :1No)	Nos.	8		
1.4	Supply and installation of power supply disconnection arrangement for strong room consisting of 1 no 10A DP MCB housed in manufacturer's powder coated MS box to be fixed inside the strong room and connected with 1 no 3-pin metal clad plug with 2 metre long 3 core 2.5 sqmm PVC insulated flexible copper conductor cable.	Set	1.00		
1.5	Acs electrification :-				
(a)	Supply and fixing 25 Amps 3-pin modular socket with 25 Amp one way switch with indicator (near AC indoor unit) housed in manufacturers MS powder coated box to be concealed in wall including Wiring using 2R4.0 sqmm & single run of 2.5 sqmm PVC insulated multi stranded single core copper conductor FRLS wire in 25mm PVC conduit to be laid in floor, partitions, etc complete with all accessories. (for split AC units) -(from Stabilizer to IDU)Supply. (2 Nos for ATM), Stabilizer to be installed in the panel room.	Nos	4		
(b)	Supply and fixing 25 Amp - 3 pin metal clad socket with plug controlled by a 25 Amp SP MCB (for Ac wall mounted stabilizers) housed in manufacturers MS powder coated box to be concealed in wall including Wiring using 2R 4.0 sqmm & single run of 2.5 sqmm PVC insulated multi stranded single core copper conductor FRLS wire in 25mm PVC conduit to be laid in floor, partitions, etc complete with all accessories. (for split AC units) from AC DB to Stabilizer (2 Nos for ATM)	Nos	4		
(c)	Supply and fixing 20A 3-pin modular socket with 20A one way switch with indicator (near AC indoor unit) housed in manufacturers MS powder coated box to be concealed in wall including Wiring using 2R 2.5 sqmm & single run of 2.5 sqmm PVC insulated multi stranded single core copper conductor FRLS wire in 25mm PVC conduit to be laid in floor, partitions, etc complete with all accessories. (for split AC units) -(from Stabilizer to IDU)Supply.Stabilizer to be installed in the panel room.	Nos	0		
(d)	Supply and fixing 20A - 3 pin metal clad socket with plug controlled by a 20A SP MCB (for Ac wall mounted stabilizers) housed in manufacturers MS powder coated box to be concealed in wall including Wiring using 2R 2.5 sqmm & single run of 2.5 sqmm PVC insulated multi stranded single core copper conductor FRLS wire in 25mm PVC conduit to be laid in floor, partitions, etc complete with all accessories. (for split AC units) from AC DB to Stabilizer	Nos	0		
2	LAYING OF CABLE :				
2.1	Supply laying fixing main power with 50mm sq 3.5 core PVC insulated,PVC sheated Alu.Conductor, 1100 v. grade armoured cable complete with 02 nos 8 SWG bear GI.wire as running earth .(Meter panel to Main Panel & Dgset to Main Panel)	Mts.	15		
2.2	End termination of 50mmsq 3.5 Core armoured cable,complete with brass cable gland , Alu. Lug, PVC tape.	Nos	4		
2.3	- Do - 3.5 x 16 sqmm with 02 nos 8 SWG bear GI.wire as running earth. for Light D.B	Mts	10		

2.4	- Do - 3.5 x 25 sqmmth with 02 nos 8 SWG bear GI.wire as running earth. for POWER & A.C.D.B . UPS & ATM	Mts	10		
2.5	- Do - termination of 25 & 16 Sqmm 3.5 Core	Nos	8		
3	Out door type glow sign board wiring :-				
3.1	Supply laying of main line with 2x2.5 +1x1.5 mmsq through MS conduite from main panal to glow sign board.	Mts	25		
3.2	Supply installation of 16 amps DP MCB at main entrance Glow sign board & With Electronic timer as required.	Set	1		
4	EARTHING STATION :				
(i)	Earthing installation as per I.E. rule conforming	Set	2		
	Supply, Installation, Testing and Commissioning of Maintenance Free Earthing system made up of copperbonded rod of 10 feet length,23 mm dia. (Minimum copper bonding shall be 0.25mm) along with Rod-toConductor connectors, Earth enhancement material, Pit Cover and other accessories as required and as per specification and other applicable codes (include chamber for earthing, Earthing certificate to be submitted along with the bill).				
(ii)	Supply laying 2x8SWG copper bear wire from earth spike to main panal.(Electrolite wire)	Mts	20		
5	MAIN ELECTRICAL DISTRIBUTION				
	Main Panel (wall Mounted Type)				
	Supply, fabricating,assembling,internal- connection, testing & conncting with incomming, out going power cables & lines as required to complete the job of cubical type electrical panal made from 14SWG CRC. M.S. sheet with proper earthing terminal(Nut- bolt &washer) 02 No.outside of panal, same nut- bolt to tighten with internal earth busbar of panal situated inside loose wire box(on top portion of panel) On top side of panel cable entry arragement to be done for incomming & out going of lines. Painting powder coating electrical grey/ seimensgrey to be done.one 6"x4" enamel type 440Volt Danger board to fix up on main panal bus-bar cover, components are as follows :-All switches are front handle operated & all MCB knob should be visual, all component to provide in separate compartment only DBs in one compartment.				
	Incomer - 100A 4P MCCB 25Ka with adjustable thermal & Magnetic trip unit -1 Nos				
	OUTGOINGS -				
	02 Amps 4 pole MCB. = 04 Nos.(AC & Power DB,ATM ,UPS,spare)				
	40 Amp 4 Pole MCB :2 nos (Lighting DB,Spare)				
	25 Amps DP MCB = 02 Nos.(sign board , Fire Alarm)				
	Amps Meter 0-100 Amps with 3 Nos. CT & selector switch 96x96mm				
	01 Set (Changeover should be ON-LOAD type.) & 3no 100 amp kit kat seperately provided				
	100Amps 4pole Cu. Bus Bar. 01 Set.				
	100Amps 4 pole Change over switch. 01 No.				
	100 Amps FP MCCB 25KA as Gen - Set main incoming 01 NO.				
	Volt meter 0-500volt A.C. 50 Hz.96x96mm with selector switch. AE make.n				
	01 Set				
	20mmdia LED indicator lamp		03 Nos.		
	02 Amps Sliding Fuse.		06 Set.		
	150x100mm enamel Danger board 440 volt.				
	(to set on bus bar cover).		01 No.		

	Cable entry from top & bottom - removable gland plates (bottom at 2 points) c/w powder coated Grey paint (two coats) with name labels for all incoming & outgoing feeders. The panel shall be complete in all respects including all accessories such as earthing bus, Air ventilators, lifting hooks etc.	Set	1		
	POWER DB & AC DB. Make standard/Legrand/ABB ,Double door 6 way TPN MCB DB with TP MCB as incoming				
	63 TP&N MCB as main				
	16Amps SP MCB - 8 Nos (Ac :3 Nos + 2X6amp : 4Nos and 1Nos spare) +32AMPS SP X10 NOS. (Ac 3 Nos+15 Amp: 6 Nos, 1No Spare)				
5.1	including Neutral Bar. 01 Set	Set	1		
	LIGHTING DB Make standard/Legrand/ABB 6 way TPN MCB DB with TP MCB as incoming				
	63A TP&N MCB as main				
	32 AMPS DB MCB 1No: For Strong room)				
	16 Amps SP MCB - 03 Nos.+ (BM +Toilet) each 1No + 1No spare				
	12 Amps SP MCB - 12 Nos. (Hall - 4Nos + Store room 1 No +Exteranl Lighting 1No.:+ Ups 1No + wall Fan 3 Nos.2 No spare)				
5.2	Including Neutral Bar. 01 Set	Set	1		
6	UPS SYSTEM (Branch)				
6.1	UPS Main DB Supply, erection, testing and commissioning of three phase 4 WAY, TPN MCB DB double door type with "C" Curve MCBs, IP 42 powder coated for UPS with 63A 4P MCBs - 1No as INCOMER 32A TP MCBs - 3 Nos. as OUTGOING (UPS :2Nos and 1 set ,: Spare Including all interconnections & accessories etc Make standard/Legrand/ABB	Nos	1		
6.2	Supply & Fixing of 32A DP MCB in 2way SPN Db IP 20 metallic directly on wall Raw power Incoming & OutGoing supply for UPS (Branch :2 Nos & ATM 1No.)	Nos	2		
6.3	UPS DB-1 & 2 combined 12 Way SPN MCB DB with 'C' curve MCBs. Incoming : 2 No. 40A DP MCB Outgoing : 8 Nos 6/10A (BM: 1+1 Nos with lighting : Server & Data Rack (1+1) Nos:C.C 2Nos with lighting :counter :2 Nos) SPO MCBs Make standard/Legrand/ABB . Repective UPS lighting to be connected.(BM,C.C,Banking hall 2Nos) or as per SLD	Nos	1		
6.4	Supply and installation of modular type 3 nos 6A multi pin sockets with 2 nos 6A one way switch with indicator housed in MS box to be fixed in partitions or concealed in wall. The box shall be painted with 2 coats of enamel paint over a coat of red oxide primer including making connections complete the rate inclusive of Supplying and running of 3 runs of 2.5 sq.mm UPS DB's to individual powerstation through .(looping 2 sets of 3X6 A socket outlet in one circuit / or as per SLD the following size of 660 volts grade, Finolex brand PVC insulated wire (For UPS point only).(For B.M,C.C,Sever each 2Nos.) +5 Nos for Counter+Rack 1Nos)	Nos	7.00		
6.5	Supply & Laying of 4 runs of 6.0 Sqmm and 2 runs of 2.5 sqmm, PVC insulated, single core, multistranded copper conductor cable in suitable rigid / flexible metal conduit from MainUPS DB to auto phase shifter	mtr	10.00		
6.6	Supply, installation, testing and commissioning of 40A rated 3 phase to single phase auto phase shifter for 3.0 KVA UPS (SLHD of Swift make)	Nos	2.00		

6.7	Supply & Laying of 2 runs of 6.0 Sqmm and 1 run of 2.5 sqmm, PVC insulated, single core, multistranded copper conductor cable in suitable rigid PVC conduit from automatch phase shifter to UPS unit	mtr	10.00		
6.8	Supply and Installation of Moduler type 2 X 20A plug & socket housed in for UPS output control (Branch 2 Nos & ATM 1No.)	Nos	3.00		
6.9	Supply & Laying of 2 runs of 4.0 Sqmm and 1 run of 2.5 sqmm, PVC insulated, single core, multistranded copper conductor cable in suitable rigid / flexible metal conduit from 3 KVA UPS to UPS DB	mtr	10.00		
sub total I					
8 ELECTRICAL FITTINGS (S/I/T/C					
8.1	Supply and Installation Recess mounted 2'-0"X2'-0" watt ,38 W LED FULL GLOW Philips MAKE . Light should be fixed through SS threaded bolt tighted the upper end on ceiling using anchor bolt and lower end on Light fitting with nut and bolt (RC380B G2 LED35S-6500/4000 PSU OD WH) PHILIPS/WIPRO MAKE (ATM 2 No)	Nos.	11		
8.3	SQUARE SHAPE DOWNLIGHTER - INTEGRA 15W, 3000K, LHEBGTP5Z1W015. PHILIPS Razor/WIPRO MAKE (ATM 2NOS)	Nos.	26		
8.4	TUBELIGHT - TITANIA SLEEK NEW LED TUBELIGHT 36 W, LHLD CNVENL8Z018. PHILIPS/WIPRO MAKE. ATM 1 No	Nos	9		
8.5	HANGING LIGHT - LHECDOL5PW1W040 (40WATTS), PHILIPS/WIPRO MAKE	NOS.	2		
8.6	150 mm dia Heavy Duty Exhust fan 230 voltA.C.(Havells / Crompton make).(UPS & Toilet)	Nos	3		
8.7	Wall mountaing fan 400 mm dia 230 volt A.C. PHILIPS/WIPRO MAKE	Nos.	9		
8.8	Supply of Ceiling fan with 1200mm sweep, double ball bearing motor, capacitor, three MS blades die cast Al housing in stove enameled white with, suspension rod including all accessories of approved make.(5 star rated) (ORIENT/KHAITAN).(UPS,Strong room & Store room)	Nos.	2		
SUB TOTAL					
TOTAL FOR ELECTRICAL WORK (B)					
C SCHEDULE - 'C' (LAN & TELEPHONE WORK)					
S.NO.	DESCRIPTION	UNIT	QTY.		
2.0 DATA SYSTEM - CONDUITING & CABLING					
2.2	Wiring for computer networking from I/O hub to computer workstation with UTP Cat-6 computer cable including providing ferrules at both ends and termination at both ends including providing & fixing frame for with shutter, RJ 45 outlet, faceplate and mounting box complete of modular type, This work includes providing PVC conduits (1/2", 3/4" size or as required) in chases from the I/O hub to the point. The cost includes testing, commisioning etc complete. Note : Do not run more than 3 wire in single pipe & should be concealed. (Server,BM,CC & ATM each 2Nos and counter 5Nos)	Nos.	7		
2.3	Supply of Cat - 6 D-Link patch cord 7' 0" (ATM 1No)	Nos.	7		
2.4	Supply of Cat - 6 D-Link patch cord 3' 0"(ATM 2No)	Nos.	7		
2.5	Supply & fixing 24 Port Jack Panel Make:-D-Link	Nos.	1		
2.6	19" Rack 9U with Glass Door , Locking system Make: APW	Nos.	1		
2.7	24PORT 10/100Mbps Switch	Nos.	1		
GRAND TOTAL FOR LAN & TELEPHONE (C)					

D- AIR CONDITIONING WORK					
S.NO.	DESCRIPTION	UNIT	QTY.		
	(AIR CONDITIONING WORK)				
1	Supplying, installation, testing and commissioning of 3-Star rated as per 2022 version Hi-wall split air conditioner of following capacity with On Off Timer along with wireless remote controller including providing and laying the standard length of 5 m copper, electrical and 25mm dia heavy duty PVC drain piping with all necessary fittings duly insulated with 9mm thick nitrile rubber pipe insulation including Initial refrigerant charge suitable for 5 Mtrs distance between IDU and ODU along with drilling the holes and packing and making good the damaged surfaces good comprising and 5 mtr Condensate drain pipe as specified spec of the following:- i) Indoor unit consisting of evaporator coil, blower fan with motor, filters, insulated drain pan control panel with cabling between control panels and units etc ii) Outdoor unit consisting of hermetically sealed Rotary Compressor to operate on 230 V, Single Phase, 50 Hz AC Supply, Anti Corrosive Coated Condensor Coil with fan and motor, interconnecting refrigeration piping, starters/controls/cutouts/relays etc., mounted inside a powder coated sheet metal cabinet duly treated for corrosion protection. the rate included interconnecting cable from indoor unit to outdoor unit (APPROVED BRAND : DAIKIN, BLUE STAR, CARRIER, HITTACHI, O GENERAL)				
B	3-Star rated Hi-wall split air conditioner of 1.5 TR capacity*blue Star/Hitachi/Carrier	Each	4		
C	3-Star rated Hi-wall split air conditioner of 1.0 TR capacity	Each	1		
2	Charges for providing additional copper pipes (one circuit) for the above split units with necessary insulation and with adequate pvc insulated copper wire from indoor to outdoor units concealed and taken through beyond the standard 5 mtr length.	Rmt	35		
3	Charges for providing additional 25 mm dia heavy duty PVC drain piping with all necessary fittings duly insulated with 9mm thick nitrile rubber pipe insulation drain pipe concealed / surface mounted and taken through wall / partition beyond the standard 5m length for the above split units.	Rmt	30		
4	Supply, installation, testing and commissioning of wall mounting 4KVA stabilizers for 1.5Tr & 1.0Tr Hi-Wall Split Air Conditioning units with input voltage range of 170-270 Volts and output 220 +/- 10% as required.	Each	4		
6	Providing and fixing standard powder coated support brackets & including grille gauge with locking arrangement for the above split / cassette units including fasteners and other accessories as required.				
a	For split air conditioner	Each	0		
7	Supplying and fixing 0-24 hrs electronic timer with 2nos 25A SP MCBs, 2 nos 25A TP contactors completely wired housed in a suitable powder coated enclosure with hinged door and mounted on wall with all interconnections. (for ac units in System Room)	No	0		
	TOTAL				
	GRAND TOTAL-B+C+D				
	NOTE :- GST TAX WILL BE EXTRA.				

LEGENDS FOR FALSE CEILING BRANCH

S.NO.	SYMBOL	DESCRIPTION	HT.
1.		2x36w CFL RECESS LIGHT	-
2.		1X36W TUBE LIGHT	7'-0"
3.		2X36W TUBE LIGHT RECESS	-
4.		CEILING FAN	-
5.		2X36W TUBE LIGHT Hanging	8'-0"
6.		WALL MOUNTED FAN	6'-6"
7.		EXHAUST	8'-6"
8.		1X11W CFL WALL LIGHT	8'-6"
9.		SWITCH BOARD	4'-6"
10.		POWER POINT	1'-0"
11.		A.C.POINT PROPOSED AC	1'-0"
12.		MAIN LT INCOMING PANEL	
13.		TPN Db	6'-0"

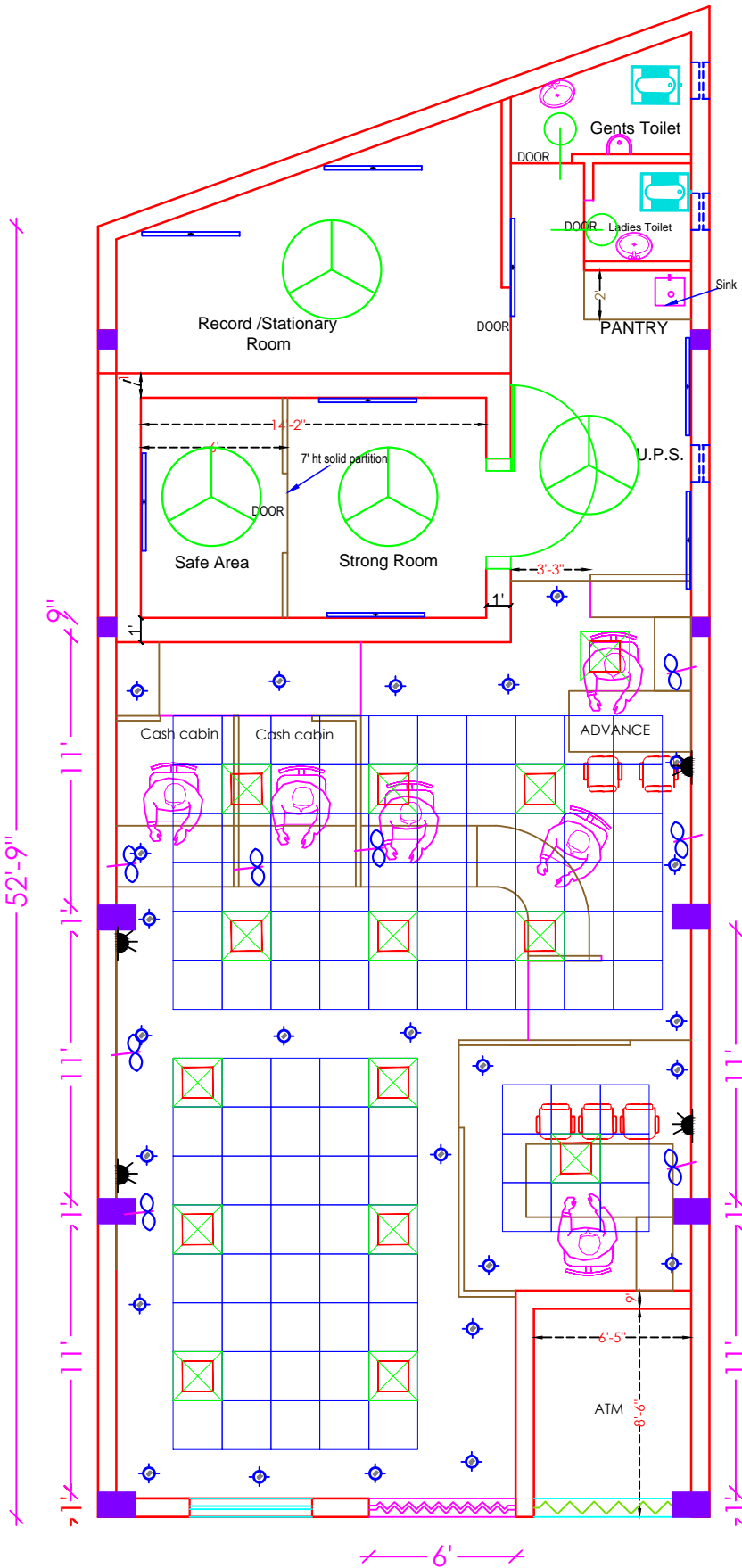

OPTION-10

PROJECT
 PROPOSED FURNISHING LAYOUT OF INDIAN BANK BRANCH AT RUDRAPUR-
 DISTRICT LAKHIMPUR KHERI - U.P

DRAWING
ELECTRIC LAYOUT



SCALE
 N.T.S.
 DATE
 MAY 2022

ARCHITECT
MOHIT & ASSOCIATES
 ARCHITECTS, INTERIORS, ESTIMATORS.
 I-2554 VINEET KHAND, GOMTI NAGAR,
 LUCKNOW. MO. - 9582218092, 7428217659

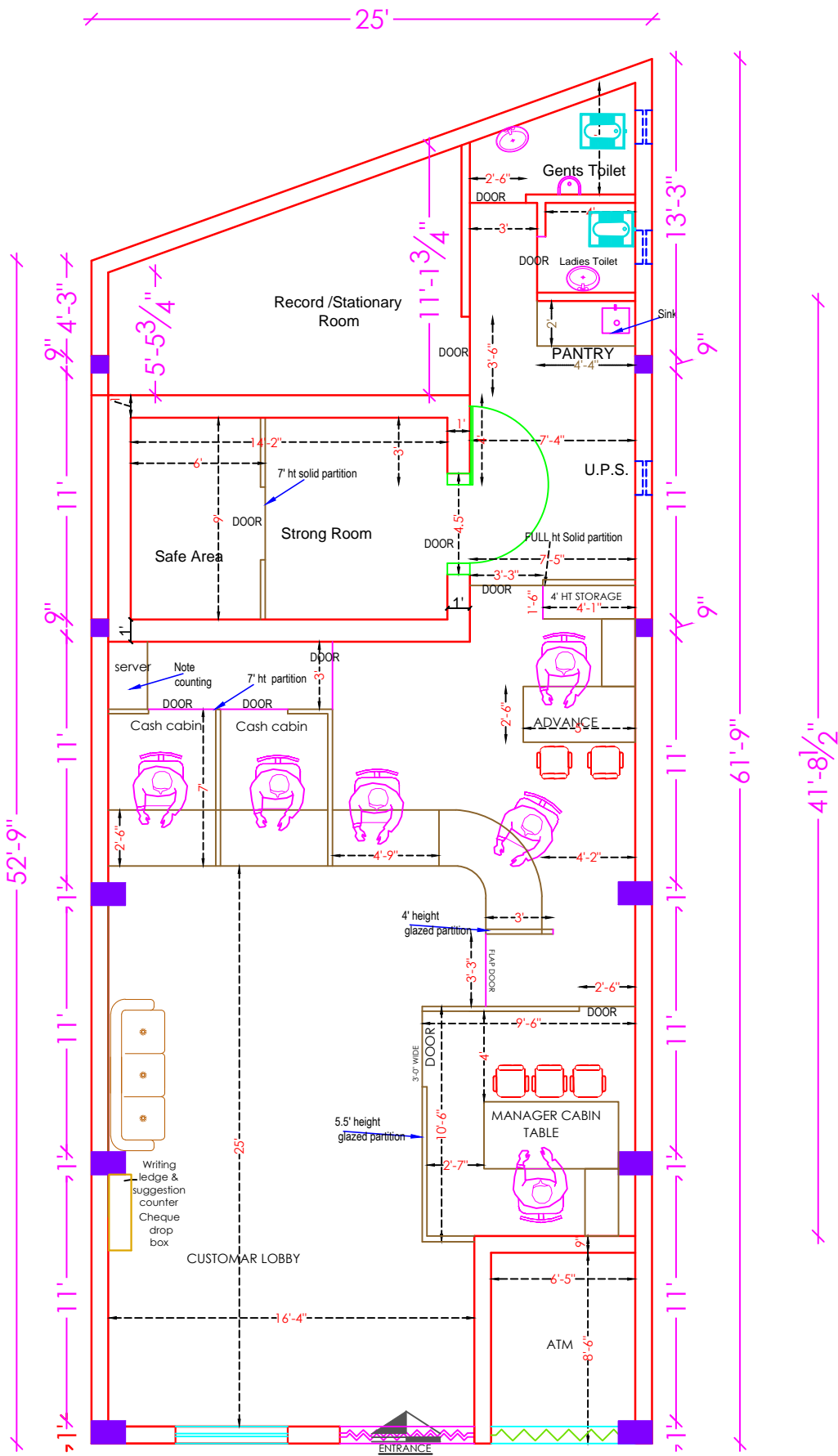

OPTION-10

PROJECT	DRAWING	NORTH	SCALE	ARCHITECT
PROPOSED FURNISHING LAYOUT OF INDIAN BANK BRANCH AT RUDRAPUR-DISTRICT LAKHIMPUR KHERI - U.P	FURNITURE LAYOUT		N.T.S.	MOHIT & ASSOCIATES ARCHITECTS, INTERIORS, ESTIMATORS.
			DATE	L-2554 VINEET KHAND,GOMTI NAGAR, LUCKNOW. MO. -9582218092,7428217659
			MAY 2022	