

**MANOROMA
CONSULTANCY**

Architect and Interior Designer

Pune Office : C-2, Kubera Gulshan Co-op Housing Soc., Parihar Chowk, Aundh, Pune-411007.
Mumbai Office : A-302, Green Hedges, Royal Complex, Eksar Road, Borivali (W), near Daffodil Hotel, Mumbai -92.
Email : manoroma2@gmail.com
Mobile: 973000556

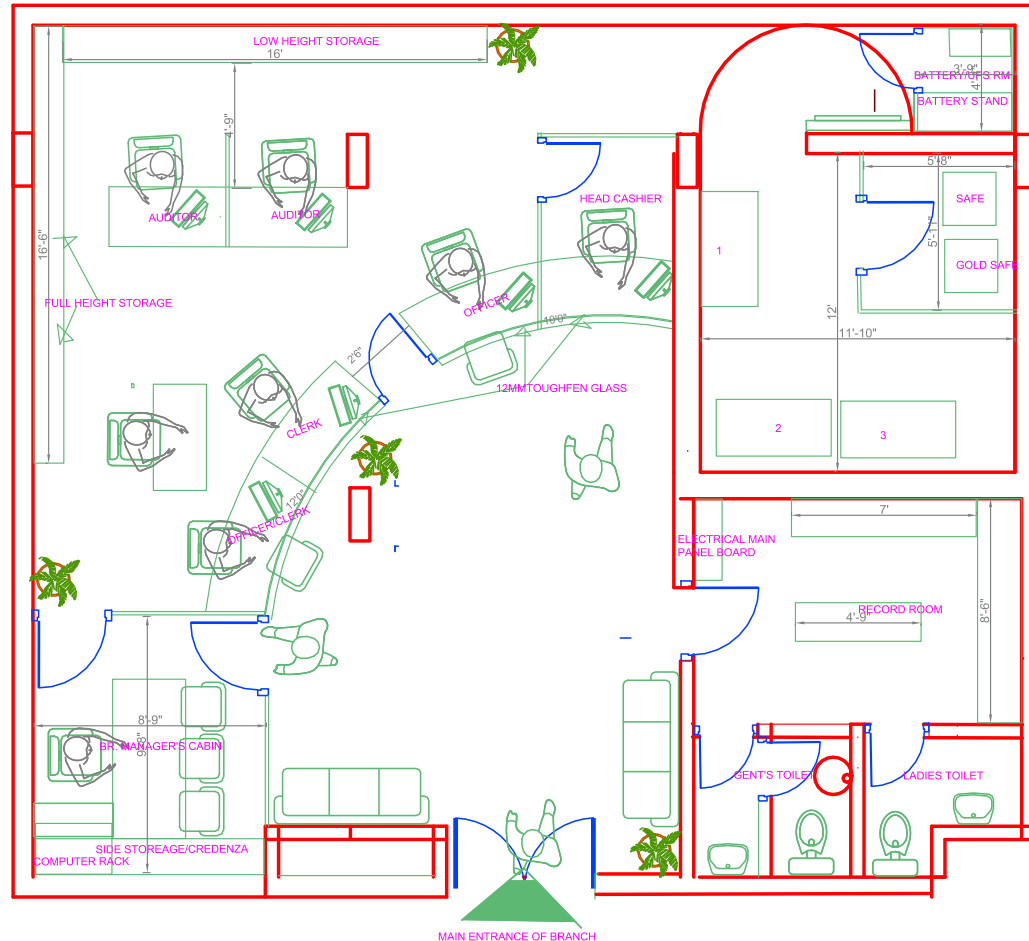
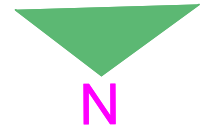

PROPOSED LAYOUT

NOTES

1. Measurements are based on the British / Metric System.
2. All levels are in meters to principal Datum (mPD) unless noted otherwise.
3. Do not scale the drawing.
4. Figure dimensions are to be followed.
5. Do not use for construction unless expressly permitted.
6. Any discrepancy in the drawing should be immediately brought to the notice of the architect and a revised drawing must be obtained before resuming work on site.
7. These drawing should be followed in reference with constant reference to other working drawings whenever necessary.
8. All dimensions are from unfinished to unfinished surfaces.
9. Large scale details supercede the smaller drawings.
10. These drawings are meant for execution details and any deviation from statutory approval/ approved designs should be brought to the notice of the local authorities and all such changes shall be got approved from the local authorities by the clients before execution of such changes on the site.

COPYRIGHT

Copyright in this document and all proprietary rights in the information it contains belong to Manoroma Consultancy. It is a condition of the supply of this document in whatever form, that the recipient shall hold it in confidence and shall not duplicate or otherwise reproduce it in whole or in part or disclose its contents without the written consent of Manoroma Consultancy.

Project Title :

**BANK OF INDIA,
SUKRAWARPETH BRANCH**

Drawing Title:

Drawn by	Ar, R.R. M	Drawn on	01.08.2020
Diss. no.	02	Diss. date	
Scale		North	