

INVITATION TO TENDER

INSTRUCTIONS TO TENDERS

AND

GENERAL CONDITIONS OF CONTRACT

FOR

INTERIOR FURNISHING, ELECTRICAL, DATA
CABLING AND AIR CONDITIONING WORKS FOR
INDIAN BANK – ZONAL OFFICE RAJAHMUNDRY

AT

INDIAN BANK
ZONAL OFFICE,
Camp Office: 36-2-2, Shyamalamba Temple Road,
InnesPeta, Rajahmundry, East Godavari, Andhra Pradesh-533101.
Contact : 9940688611 / Raju.SR@indianbank.co.in.

CONSULTANTS:



SRR ARCHITECTNIQUES

PLANNERS-ENGINEERS-VALUERS-INTERIOR-LANDSCAPE- INFRASTRUCTURE : DESIGNERS & PROJECT MANAGEMENT CONSULTANTS

**3-6-460, 101/A & 102, Gokulkunj Street – 5
Hardikarabagh, Himayat Nagar,
Hyderabad – 500 029**

Email: raghuram.srra@gmail.com, Mo: 9959554845.

Notice of Invitation of Tender

Sealed Tenders on item rate basis are invited from empanelled contractors to do Interior/Furnishing & Electrical works for INDIAN BANK – ZONAL OFFICE work at Rajahmundry.

- Earnest Money Deposit : **Rs.69,000/-** Demand Draft in favour of
**THE ASSISTANT GENERAL MANAGER
INDIAN BANK,
ZONAL OFFICE,
RAJAHMUNDRY.**
- Time of Completion : Thirty - Days (30) Calendar days.
- Time and date of Submission of Tender : Before 3.00 pm on 25.08.2022
Opening of Tender : After 5.00 pm on 25.08.2022
INDIAN BANK
Camp Office: 36-2-2, Shyamalamba Temple Road,
InnesPeta, Rajahmundry,
East Godavari, Andhra Pradesh-533101.
- Liquidated Damages for delay : 1% of total value of contract per week up to a maximum 10% of the accepted contract sum.
- Defects Liability Period : 12 Months
- Validity of the Tender : 90 Calendar Days.
- Sales Tax. IT. Octroi. Levies : **The rates quoted should include GST and Other Taxes etc.,**
- Transportation and Lifting of : The rates quoted should include cost of Materials transportation, carting, wastages and Lifting for all leads, night work etc.,

Note:

The bank is not bound to accept the lowest tender & reserves the right to accept or reject any or all the tenders without assigning any reason whatsoever.

The Assistant General Manager,
Indian Bank,
Zonal Office,
Camp Office: 36-2-2, Shyamalamba Temple Road,
InnesPeta, Rajahmundry,
East Godavari, Andhra Pradesh-533101

**PROPOSED INTERIOR / FURNISHING , ELECTRICAL , DATA CABLING &
AIR CONDITIONING WORKS FOR ZONAL OFFICE -
INDIAN BANK, RAJAHMUNDRY ZONE.**

2. GENERAL RULES AND INSTRUCTION FOR THE GUIDANCE OF TENDERER.

1. Tenders are hereby invited for **M/s INDIAN BANK, ZONAL OFFICE, RAJAHMUNDRY– 533101, Ph:** to carry out the **Interior Furnishing Electrical Data Cabling & Air-conditioning works for Indian Bank, ZONAL OFFICE.** Contract document/consisting of the Plans, Complete Specification, the schedule of quantities of the various classes of work to be done and the set of conditions of contract to be compiled with by the person whose tenders may be accepted
2. Tenders which should always be placed in sealed cover with the name of project written on the envelopes will be received by The Assistant General Manager, Indian Bank, Rajahmundry- 533101 up to **3.00 pm on 25.08.2022** and will be opened by the authorized officer in his office on the same day at **5.00pm on 25.08.2022**. The tenders received after the stipulated time will not be accepted.
3. Tenders are to be on the prescribed form, which can be obtained from the office of M/s INDIAN BANK, Zonal office Rajahmundry. Ph: 91-88324-36044/ Ph: 91-88324-33044, The time allowed for carrying out of the work for the Interiors & Electrical works will be 30 (Thirty days) Calendar days from the same day after the date of written orders to commence work.
4. The empanelled contractors should quote in figures as well as in words the rate and amount tendered by them. The amount for each item should be worked out and requisite totals given.
5. When empanelled contractors sign a tender in an Indian Language the tendered amount and the total amount tendered should also be written in the same language. In the case of illiterate empanelled contractors the rate or the amounts tendered should be attested by a witness.
6. Issue of tender form will be stopped one day before the date fixed for the opening of tenders.
7. Earnest Money amounting to Rs.69,000/- in the form of bank draft drawn in favour of **The Assistant General Manager**, Indian Bank, Zonal Office, Rajahmundry-533101, must accompany with each tender and each tender is to be in a sealed cover super/scribed “Tender for the Interior Works Indian Bank – Zonal Office”. **The empanelled contractor, whose tender is accepted will be required to furnish by the way of security deposit for the due fulfillment of his contract @ 10% of the contract.** The EMD of the empanelled contractor whose tender is accepted shall be forfeited in full in case he does not remit the Initial Security Deposit within the stipulated date mentioned in the award letter.
8. The acceptance of the tender will rest with The Assistant General Manager, Indian Bank, Zonal Office, Rajahmundry-533101 and will not be bound to accept the lowest tender, and reserve the authority to reject any or all of the tenders received without assigning any reason. All tenders in which any of the prescribed conditions are not fulfilled or are incomplete in any respect are liable to be rejected. Canvassing in connection with tenders is strictly prohibited and the tenders submitted by the empanelled contractors who resort to canvassing will be liable to rejection.
9. Power and Water will not be provided by the Employer. The empanelled contractor has to make the arrangement for the same. Sub-meter shall be provided by the empanelled contractor at his own cost.
10. All rates shall be quoted on the proper form of the tender alone.

11. No Advance payment will be provided. Hence Empanelled contractors are advised to raise the bill after completion of the work only.

12. An item rate tender containing percentage below/above will be summarily rejected. However, where a tenderer voluntarily offers a rebate for payment within a stipulated period, this may be considered.
13. On acceptance of the tender, the name of the accredited representative(s) of the empanelled contractor who would be responsible for taking instructions from the Bank/Architects shall be communicated to the Bank.
14. Special care should be taken to write the rates in figure as well as in words and the amount in figures only, in such a way that interpolation is not possible. The total amount should be written both in figures and in words. In case of figures the words 'Rs' should be written before the figures of rupees and words 'P' after the decimal figures, e.g., Rs.2.15 "P" and in case of words. The word 'Rupees' should precede and the word 'Paise' should be written at the end, unless the rate is in whole rupees and followed by the words 'only'. It should invariably be up to two decimal places. While quoting the rate in schedule of quantities the word 'only' should be written closely following the amount and it should not be written in the next time.
15. Sales tax or any other tax on material or on finished works like works contract tax, turnover tax etc., in respect of this contract shall be payable by the empanelled contractor and the bank will not entertain any claim whatsoever in this respect.
16. The empanelled contractor shall give a list of relative working with the bank along their designations and addresses.
17. The tender for works shall remain open for acceptance for a period of **Seven (07)** calendar days from the date of opening of tenders. If any tenderer withdraws his tender before the said period, then the bank shall be at liberty to forfeit the Earnest Money paid along with the tender.
18. The tender of the work shall not be witnessed by an empanelled contractor who himself/themselves has/have tendered or who may have had/have tendered for the same work. Failure to observe this condition would render tenders of the empanelled contractors tendering as well as witnessing the tender liable to summary rejection.
19. It will be obligatory on the part of the tenderer to tender and sign and tender documents for all the component parts and that, after the work is awarded, he will have to enter into an agreement for each component with the competent authority in the bank.
20. In the event of Correction, Overwriting, Addition occurrence at the time of filling rate in words and figures, the number of such Correction, Overwriting, Alteration shall be entered at the relevant space marked as "C", "O" and "A" in each page of schedule of quantities.

21. 3.1 ADDITIONAL CONDITIONS OF CONTRACT

Tender shall sign wherever provided for. The tenders not so signed shall be rejected. The tenders shall be submitted in on or before the due date.

No tenders shall be accepted unless the full amount of the earnest money deposit is paid at the time of submission of the tender. No exemption will be entertained.

Fluctuations in the prices of any materials or equipment or labour etc., shall not be taken into account either for compensation for damages for extras.

Watch and ward in respect of all plants, machinery and materials at site for use in works shall be the empanelled contractor's sole responsibility.

The empanelled contractor shall have to make his own arrangements to house his labour

and staff and for their services.

All instructions regarding the execution of works shall be received from the Architects/Bank only. Any other instructions issued directly to the empanelled contractor by anyone else shall not be binding on the employer.

During execution of works the empanelled contractor must check his work with the drawings. The empanelled contractor shall be responsible for all the errors in this connection and will have to rectify all defects at his own cost, failing which the employer reserves all right to get the same rectified at the risk and cost of the empanelled contractor.

The empanelled contractor entrusted with the work shall indemnify the Bank and the Architects against theft, mishaps in construction and injury to workmen, damage to persons, property etc., He shall make well the damage at his own expense.

The Bank through the Architects shall have the power to omit or cancel any item of work without assigning any reason whatsoever and no claim for compensation for damage will be entertained for such omissions and cancellations.

Time is the essence of the work. All the works shall have to be completed within **30 days** from the same day of the work order. If the work is not completed within the aforesaid period the empanelled contractor shall pay the Bank the liquidated damages as mentioned before and the Bank shall be entitled to deduct from the money due to the said empanelled contractor.

The empanelled contractor shall maintain satisfactory progress of work as well as maintain a desired workmanship. If in the opinion of the Architects the progress is unsatisfactory and/or the workmanship is unsatisfactory, the architects shall advise the bank to take possession of the work with 7 days notice to that effect.

The Employer shall then complete the entire work and rectify all the defects at the empanelled contractor's cost and consequences.

In case the Bank/Architects are not satisfied with the quality of materials used by the empanelled contractor they reserve the right to direct the empanelled contractor to procure such supplies from agencies they deem fit.

The empanelled contractor shall submit the bills for payment along with the detail statement showing the actual works carried out under different circles of items.

The empanelled contractor shall clear of works as per instruction of the Bank/Architects. The site of works shall be cleared of all men, materials, etc., belonging to the empanelled contractor. The site shall be delivered in a broom clean and neat condition immediately after the job is completed. In case of failure by the empanelled contractor, the employer shall have the right to get the site cleared at the risk and cost of the empanelled contractor.

The empanelled contractor shall not without the written consent of the Bank / Architects assign the agreement or sublet any portion of works.

The quoted rates shall be all inclusive and cover the cost of all materials, freight, all types of taxes, duties, royalties, erection, construction, overhead, profit and any other expenditure incurred for completion of work as per drawings and specifications.

Wherever required, the Bank/Architect shall instruct erecting items sample, or mock-up as the case may be, and upon approval of the same, the items shall be fabricated and completed by the empanelled contractor (with or without modifications as the Bank/Architects shall instruct).

The final bill from the empanelled contractor shall not be entertained under any circumstances without full completion of all the items of works. Any work found defective wrongly carried out, and instructed by the Bank/Architect to be rectified or replaced should be rectified or replaced prior to submission of final bill. It is to be expressly noted that no final bill will be held valid in the event of non-rectification of the defective or wrongly carried out items and the completion date shall not on this account be extended. Defects liability period will be effective from the day of satisfactory completion of all the items of works, as may be certified by the Architect.

In the event of the work being executed on holidays/beyond the Bank normal office working hours which might be required for the completion of the work within the stipulated time, the utmost care to be taken for not to disturb to normal working of Branch prior permission shall be obtained in the event of any night work is to be carried out.

While executing the work, considerable amount of shifting and re-shifting of several furniture items are likely to be involved. It is also likely that some of the items might be required to temporarily shift elsewhere in the premises on any other floors. These shall be done by the Empanelled contractor, and no payment against these works shall be separately paid for by the Bank. As the work is to be carried out and completed in the working Bank, the empanelled contractor shall be responsible for maintaining the premises in clean condition every morning for the normal functioning of the Bank.

The empanelled contractor shall acquaint himself with the site conditions, local traffic regulations, local authority regulations availability of materials, labour, tax, structure, etc., and quotes accordingly. No extra charges/increases in rates shall be allowed on any of these or any other accounts.

The empanelled contractor shall have a component supervisor on the site at all the times. The empanelled contractor and/or his authorized representatives will attend all the meetings, whenever called for and the decisions taken in meeting will be binding on the empanelled contractor.

The empanelled contractor shall extend all necessary help to the agencies of associated works like A.C works, Intercom works, Computer wiring works, fire detection works and works to be carried out by landlord's agencies in such a manner that they can carry out their work smoothly and whole finished work must appear absolutely integrated. Nothing extra shall be paid on this account whatsoever. Figured dimensions are in all cases to be followed and in no case should they be scaled. Large scale details take precedence over small-scale drawings. In case of any ambiguity, conflict of interpretation shall prevail; the Bank/Architects decisions in this regard shall be final and binding.

The empanelled contractor shall be given a single electrical connection at the work site. Electrical charges for consumption by the empanelled contractors will be charged separately by the Bank.

The empanelled contractor shall be bound to carry out any extra items of work, whenever possible the rate for extra item shall be derived from the rate already quoted.

The empanelled contractor shall submit his FINAL bills for payment concerning work executed or materials delivered on the site, or work executed at his workshop which will be certified by the Architect for payment within 15 days from the date of submission of bill.

The architect will not certify any application for payment if there are:

- a. Defective items of work still uncorrected.
- b. Any claims or liens filed against the empanelled contractor for failure to pay for materials, labour or sub-empanelled contractors amount due; or reasonable evidence that includes probable filing of such claims
- c. Damage to another empanelled contractor.
- d. A reasonable doubt that the empanelled contractor can be completed for the balance then unpaid.

When the works are completed in all respects, the Empanelled contractor shall intimate in writing to the Architects and bank to enable to take possession of the same. The works shall not be considered virtually complete until the Bank/Architect have jointly inspected the works and certified in writing that this has been completed.

Empanelled contractor's Seal and
Signature.

3.2 GENERAL CONDITIONS OF CONTRACT

Except where provided for in the description of the individual items in the schedule of quantities in the specifications, conditions laid down hereinafter and in the Drawings, the work shall be carried out as per standard specifications and under the direction of Bank/Architects.

INTERPRETATION:

In constructing these conditions, the specifications, the schedule of quantities, tender and Agreement, the following words shall have the meaning herein assigned to them except where the subject or context otherwise requires:

- a. **Employer:** The term employer shall denote M/s INDIAN BANK, Zonal office, Rajahmundry-533101 and any of its employees representatives authorized on their behalf.
- b. **Architects:** The term Architects shall mean M/s SRR ARCHITECTNIQUES, 101 & 102, GOKUL KUNJ, STREET NO-5, HARDIKARBAGH, HIMAYATNAGAR, HYDERABAD-500 029 ,TELENGANA PH: 040-40072083, 9959554845 or in the event of his/her ceasing to be the Architects for the purpose of this contract such other persons/as the Employer shall nominate for the purpose.
- c. **Empanelled contractor:** The term empanelled contractor shall mean (Name and address of the empanelled contractor) and his/hers legal representatives, assign and successors.
- d. **Site:** The site shall mean the site where the works are to be executed. The site is in Indian Bank, Rajahmundry.
- e. **Site Engineer:** The site engineer shall be appointed by the Bank/Architect. The bank may also determine the number of site Engineers and the supporting staff at site office to assist them and also whether the site engineer shall be temporary or permanent. As far as possible, the site engineer should assume change of his post before the empanelled contractor reports on site of work. Where more than one site engineer appointed, one of them shall be designated as senior engineer by the Premises Department and the other Site Engineer shall be reporting to the Senior Engineer.
- f. The work is to be carried out in accordance with drawings, specifications, the schedule of quantities and any further drawings which may be supplied or any other instructions, which may be given by the employer during the execution of the work. All drawings relating to work given to the empanelled contractor together with a copy of schedule of quantities are to be kept at site and the Employer/Architects shall be given access to such drawing and/or dimensional sketches therefore and have it confirmed by the Employer/Architects prior to taking up such work. The empanelled contractor shall ask in writing for all clarifications on matter occurring anywhere in drawings, specifications and schedule of quantities or to additional instructions at least 3 days ahead from the time when it is required for implementation so that the Employer may be able to give decision thereon.
- g. "The Works" shall mean the work or works to be executed or done under this contract.
- h. "Act of insolvency" shall mean any act as such as defined by the Presidency Towns Insolvency Act or in Provincial Insolvency Act or any amending statutes.
- i. "The schedule of Quantities" shall mean the schedule of quantities as specified and forming part of this contract.
- j. "Priced Schedule of Quantities" shall mean the schedule of quantities duly price with the accepted quoted rates of the empanelled contractors.

2. SCOPE:

The work consists of construction of Employer's Interior & Electrical works in accordance with the "drawings" and "Schedule of Quantities" It includes furnishing all materials, labour, tools and equipment and management necessary for and incidental to the completion of the work. Should any detail essential for efficient completion of the work be omitted from the drawings and specifications it shall be the responsibility of the empanelled contractor to inform the Employer/Architects and to furnish and install such detail with Employer's/Architects concurrence, so that upon completion of the proposed work the same will be acceptable and ready for use.

Employer/Architects may in their absolute discretion issue further drawings and/or written instructions, details, directions and explanations, which are hereafter collectively referred to as "The Employer's/Architect's instructions" in regard to:

- a) The variation or modification of the design quality or quantity of works or the addition or omission or substitution of any work.
- b) Any discrepancy in the drawings or between the schedule of quantities and/or drawings and/or specification.
- c) The removal from the site of any defective material brought thereon by the empanelled contractor and the substitution of any other material thereof.
- d) The demolition removal and/or re-execution of any work executed by the empanelled contractor/s.
- e) The dismissal from the work of any persons employed thereupon.
- f) The opening up for inspection of any work covered up.
- g) The rectification and making good of any defects under clauses hereinafter mentioned and those arising during the maintenance period (retention period).

The empanelled contractor shall forthwith comply with and duly execute any work comprised in such Bank's/Architects' instructions, provided always that verbal instructions, directions and explanations given to the empanelled contractor's or his representatives upon the works by the Bank/Architects shall if involving a variation be confirmed in writing to the empanelled contractor within seven days. No works, for which rates are not specifically mentioned in the priced schedule of quantities, shall be taken up without written permission of the Bank/Architects. Rates of items not mentioned in the priced schedule of quantities shall be fixed by the employer in consultation with the Architects as provided in clause "variation". Regarding all factory made products for which ISI marked products are variable, only products bearing ISI marking shall be used in the work.

3. TENDERER SHALL VISIT THE SITE:

Intending tenderer shall visit the site and make himself thoroughly acquainted with the local site condition, nature and requirements of the works, facilities of transport condition, effective labour and materials, access and storage for materials and removal of rubbish. The tenderer shall provide in their tender cost of carriage, freight and other charges as also for any special difficulties and including police restriction for transport etc., for proper execution of work as indicated in the drawing. The successful tenderer will not be entitled to any claim of compensation for difficulties faced or losses incurred an account of any site condition which existed before the commencement of the work or which in the opinion of the Employer/Architects might be deemed to have reasonably been inferred to be so existing before commencement of work.

4. TENDERS:

The entire set of tender paper issued to the tenderer should be submitted fully priced and also signed on the last page together with initials on every page. Initial/Signature will indicate the acceptance of the tender papers by the tenderer the schedule of quantities shall be filled in as follows:

- (i) The 'Rate' column to be legibly filled in ink in both English figures and English words.
- (ii) Amount column to be filled in for each item and the amount for each circle as detailed in the "Schedule of Quantities".
- (iii) All corrections are to be initialed.
- (iv) The 'Rate Column' for alternative items of which the quantities are not mentioned shall not be filled up.
- (v) In case of any errors/omissions in the quoted rates, the rates given in the tender marked 'Original shall be taken as correct rates.

No modifications, writings or corrections can be made in the tender papers by the tenderer, but may at his option offer his comments or modifications in a separate sheet of paper attached to the original tender papers.

The Bank reserves the right to reject the lowest or any tender and also to discharge any or all of the tenders for each section or to split up and distribute any item of work to any specialist firm or firms without assigning any reason.

The tender should note that tender is strictly on the item rate basis and their attention is drawn to the fact that the rate for each and every item should be correct, workable and self-supporting. If called upon by the Employer/Architects detailed analysis of any or any or all the rates shall be submitted. The Employer/Architects shall not be bound to recognize the empanelled contractor's analysis.

The work will be paid for the "measured work" on the basis of actual work done and not as "Lump sum" contract.

All items of work described in the schedule of quantities are to be deemed and paid as complete works in all respects and details including preparatory and finishing works involved, directly, related to and reasonably detectable from the drawings, specifications and schedule of quantities and no further extra charges will be allowed in this connection. In any case of lump-sum charges in the tender in respect of any item of works, the payment of such items of work will be made for the actual work done on the basis of lump-sum charges as will be assessed to be payable by the Employer/Architects.

The employer has power to add to, omit from any work as shown in drawings or described in specifications or included in schedule of quantities and intimate the same in writing but no addition, omission or variation shall be made by the empanelled contractor without authorization from the Employer. No variation shall vitiate the contract.

The tenderer shall note that his tender shall remain open for consideration for a period of **07 calendar days** from the date of opening of the tender.

5. AGREEMENT:

The successful empanelled contractor may be required to sign agreement as may be drawn up to suit local conditions and shall pay for all stamps and legal expenses, incidental thereto.

6. PERMITS AND LICENSES:

Permits and licenses for release of materials which are under Government control will be arranged by the empanelled contractor. The employer will render necessary assistance, sign any form or applications that may be necessary. The basic price of controlled materials for the purpose of valuing the tender is to be considered as stipulated below. This will also be the basis of adjustment in settling the empanelled contractor's bills.

It may be clearly understood that no compensation or additional charges can be claimed by the empanelled contractor for non receipt of any controlled materials in due time on this account or according to his own requirements.

The empanelled contractor will, however, be eligible to a proportionate extension of time on this account which in the opinion of the Bank/Architects is reasonable. The empanelled contractor shall at his own cost arrange for storage shed adequate for taking delivery and storing of the quantity of controlled materials released by the authorities or supplied by the Bank. The costs of storing, transporting etc., of all materials including those under government control are to be included by the tenderer in his quoted rates.

The Bank/Architects shall be indemnified against all government or legal actions for theft and any other controlled materials in the custody of the empanelled contractor.

7. GOVERNMENT AND LOCAL RULES:

The empanelled contractor shall confirm to the provision of all local Bye-laws and Acts relating to the work and to the Regulations etc., of the government and local authorities and of any company with whose system the structure is proposed to be connected. The empanelled contractor shall give all notices required by said Act, Rules, Regulations and Bye-laws etc., and pay all fees payable to such authority/authorities for execution of the work involved. The cost, if any, shall be deemed to have been included in his quoted rates, taking into account all liabilities for licenses, fees for footpath encroachment and restorations etc., and shall indemnify the Employer against such liabilities and shall defend all actions arising such claims or liabilities.

8. TAXED AND DUTIES:

The tenderer must include in their prices quoted for all duties, royalties, cess, income tax and sales tax or any other taxes or local charges if applicable. No extra claim on this account will in any case be entertained.

9. PROVISIONAL SUMS (PS):

All provisional sums described in the schedule of quantities as PS shall be exclusively to the purchase of materials and not for any handling and fixing to be done by the empanelled contractor. Such costs of handling and fixing with profit (including transport charges if required) shall be separately included in the contract price as described in the schedule of quantities. The disposal of the amounts covered under this circle will be absolutely at the discretion of the Bank. Empanelled contractor is to make payments for these materials to the suppliers on certificate or order issued by the Bank/Architects and realizes them through his bills from the Bank.

10. QUANTITY OF WORK TO BE EXECUTED:

The quantities shown in the schedule of quantities are intended to cover the entire new structure indicated in the drawings but the bank reserves the right to execute only a part or the whole or any excess thereof without assigning any reason therefore.

11. OTHER PERSONS ENGAGED BY THE EMPLOYER:

The employer reserves the right to execute any part of the work included in this contract or any work which is not included in this contract by other agency or persons and empanelled contractor shall allow reasonable facilities and use of his scaffolding for the execution of such work. The main empanelled contractor shall extend all co-operations in this regard.

12. a. EARNEST MONEY DEPOSIT:

The tenderer will have to deposit EMD cost as specified in tender notice in the form of Bank Draft drawn in favour of Indian Bank at the time of submission of tender as an Earnest Money. The employer is not liable to pay any interest on the Earnest Money of the unsuccessful tenderer will be refunded without any interest soon after the decision to award the work is taken or after the expiry of the validity period of the tender.

12. b. INITIAL SECURITY DEPOSIT:

The successful tenderer to whom the contract is awarded will have to deposit as initial security deposit a further sum to make up 2% of the value of the accepted tender including the Earnest Money. The initial Security Deposit will have to be made within fourteen (14) days from the date of acceptance of tender, failing which the Employer at his discretion may revoke the letter of acceptance and forfeit the Earnest Money deposit furnished along with the tender. It shall be refunded to the empanelled contractor within fourteen days after the issue of certificate virtual completion.

12. c. RETENTIONAL MONEY:

The initial security made as above will be treated as retention money, if it falls short/excess of 10% of final bill 10%, excess amount will be refunded and short amount will be deducted from the final bill and held upto 12 Months and amount will be refunded to the empanelled contractor 14(fourteen) days after the end of defects liability period provided he has satisfactorily carried out all the work and attended to all defects in accordance with the conditions of the contract. No interest is allowed on retention money.

13. EMPANELLED CONTRACTOR TO PROVIDE EVERYTHING NECESSARY:

The empanelled contractor shall provide everything necessary for the proper execution of the work according to the intent and meaning of the drawings, schedule of quantities and specifications taken together whether the same may or may not be particularly shown or described therein provided that the same can reasonably be inferred there from and if the empanelled contractor finds any discrepancies therein he shall immediately and in writing refer the same to the Bank/Architects whose decision shall be final and binding.

The rates quoted against individual items will be inclusive of everything necessary to complete the said items of work within the contemplation of the contract, and beyond the unit price no extra payment will be allowed for incidental or contingent work, labour and/or materials inclusive of all taxes and duties.

Whatsoever except for specific items, if any, stipulated in the tender documents.

The empanelled contractor shall at all times give access to workers employed by the Bank or any employed on the buildings and to provide such parties with proper sufficient and if required special scaffolding, hoists and ladders and provide them with water and lighting and leave or make any holes, grooves, etc., in any work, where directed by the employer as may be required to enable such workmen to lay or fix pipes, electrical wiring, special fittings etc., The quoted rates of the tenderer shall accordingly include all these above mentioned contingent works.

14. TIME OF COMPLETION EXTENSION OF TIME AND PROGRESS CHART:

- a. **Time of Completion:** The entire work is to be completed in all respects within the stipulated period. The work shall be deemed to be COMMENCE FROM THE DATE OF ISSUANCE OF WORK ORDER. Time is essence of the contract and shall be strictly observed by the empanelled contractor.

The work shall not be considered as complete until the Bank/Architects have certified in writing that this has been completed and the Defects Liability Period shall commence from the date of such certificate.

- b. **Extension of Time:** If in the opinion of the Bank/Architects the works be delayed
- (i) By reason of any exceptionally inclement weather, or
 - (ii) By reason of instructions from the Bank consequence of proceedings taken or threatened by or disputed, with adjoining or neighboring owners or
 - (iii) By the works, or delay, of other empanelled contractors or tradesmen engaged or nominated by the Employer and not referred to in the specification or
 - (iv) By reason of authorized extra and additions or
 - (v) By reason of any combination of workmen or strikes or lock-out affecting any of the building trades or
 - (vi) From other causes which the Bank may consider are beyond the control of the empanelled contractor, the bank at the completion of the time allowed for the contract shall make fair and reasonable extension of time for completion in respect thereof. In the event of the Bank failing to give possession of the site upon the day specified above the time of completion shall be extended suitably.

In case of such strikes or lock-outs, as are referred to above, the empanelled contractor shall, immediately give the bank, written notice thereof. Nevertheless, the empanelled contractor shall use his best endeavors to prevent delay, and shall do all that may be reasonably required, to the satisfaction of the employer to proceed with the works and on his doing so that it will be ground of consideration by the employer for an extension of time as above provided. The decision of the employer as to the period to be allowed for an extension of time for completion hereunder (which decision shall be final and binding on the empanelled contractor) shall be promulgated at the consideration of such strike or lock-out and the employer shall then, in the event of an extension being granted, determine and declare the final completion date.

Progress of Work: During the period of construction the empanelled contractor shall maintain proportionate progress on the basis of program chart submitted by the empanelled contractor immediately before commencement of work and agreed to by the Employer/Architects. Empanelled contractor should also include planning for procurement of scarce material well in advance and reflect the same in the program chart so that there is no delay in completion of the project.

15. LIQUIDATED DAMAGES:

Should the work be not completed to the satisfaction of the Employer/Architect within stipulated period the empanelled contractor should be bound to pay to the Employer a sum calculated as given below by way of liquidated damages and not as penalty during which the work remains uncompleted or unfinished after the expiry of the completion date.

- | | |
|---|---|
| a. For contracts having time for completion 6 months and less | 1% of the estimated amount shown in the tender per week subjected to 10% of the accepted contracted sum. |
| b. For contracts having time for completion exceeding 6 months but not exceeding 24 months. | 0.5% of the estimated amount shown in the tender per week subjected to 7.5% of the accepted contracted sum. |
| c. For contracts having time for completion exceeding 24 months. | 0.25% of the estimated amount shown in the tender per week subjected to 5% of the accepted contracted sum |

16. TOOLS, STORAGE OF MATERIALS, PROTECTIVE WORKS AND SITE OFFICE REQUIREMENTS:

The empanelled contractor shall provide, fix up and maintain in an approved position proper office accommodation for the empanelled contractor's representative and staff which offices shall be open at all reasonable hours to receive instruction notices or communications and clear away on completion of the works and make good all distributed work.

All drawings maintained on the site are to be carefully mounted on boards of appropriate size and covered with a coat of approved varnish. They are to be protected from ravages of termites, ants and other insects.

The empanelled contractor shall provide at his own cost all artificial light required for the work and to enable other empanelled contractors and sub-empanelled contractors to complete the work within the specified time.

The empanelled contractor shall provide a suitable temporary hut for the watchmen and clear away the same when no longer required and to provide all necessary attendance, lights, etc., required.

The empanelled contractor shall arrange for temporary latrines for the use of workers and field staff and keep the same in clean and sanitary condition to the satisfaction of the public Health Authorities and small cause such latrines and soil to be cleared away whenever necessary and shall make good all the works disturbed by these conveniences.

Every precautions shall be taken by the empanelled contractor to prevent the breeding of mosquitoes on the works during the constructions, and all receptacles, cisterns, water tanks, etc., used for the storage of water must be suitable protected against breeding of mosquitoes. The empanelled contractor shall indemnify the employer against any breach of rules in respect of anti-malarial measures.

The empanelled contractor shall not fix or place any placards or advertisement of any description or permit the same to be fixed or placed in or upon any boarding gantry, building structure other than those approved by the Employer.

Protective Measures: The empanelled contractor from the time of being placed in possession of the site must make suitable arrangements for watching, lighting and protecting the work, the site and surrounding property by day, by night, on Sundays and other holidays.

Tools: The empanelled contractor should cover in his rates for making provisions for all reasonable facilities for the use of his scaffolding, tools etc., by sub empanelled contractors for their work.

17. NOTICE AND PATENTS OF APPROPRIATE AUTHORITY AND OWNERS:

The empanelled contractor shall confirm to the provisions of any Acts of the Legislature relating to the work, and to the regulations and bye-laws of any authorities, and/or any water, lighting and other companies, and/or authorities with whose systems the structures were proposed to have connection and shall before making any variations from the drawings or specification that may be associated to so conform, give the Employer/Architects written notices specifying the variations proposed to be made and the reasons for making them and apply for instruction thereon. The Employer/Architects on receipt of such intimation shall give a decision within a reasonable time.

The empanelled contractor/s shall arrange to give all notices required for by the said Acts, Regulations or Bye-Laws to be given to any authority, and to pay to such authority or to any public officer all fees that may be properly chargeable in respect of the work and lodge the receipts with the Employer.

The empanelled contractor shall indemnify the Employer against all claims in respect of patent right, royalties, damages to building, roads or members of public in course of execution of work and shall defend all actions arising from such claims and shall keep the Employer saved harmless and indemnified in all respects from such actions, costs and expenses.

18. CLEARING SITE AND SETTING OUT WORKS:

The site shown on the plan shall be cleared of all obstructions. If at any time, any error shall appear during the progress of any part of the work, the empanelled contractor shall at his own expenses rectify such error if called upon to the satisfaction of the Employer. The empanelled contractor shall further set out the works to the alternative positions at the site until on is finally approved and the rates quoted in his tender should include for this and no extra on this account will be entertained.

19. MATERIALS, WORKMANSHIP, SAMPLES, TESTING OF MATERIALS:

All the works specified and provided for in the specifications or which may be required to be done in order to perform and complete any part thereof shall be executed in the best and most workman like manner with materials of the best and approved quality of the respective kinds in accordance with the particulars contained in and implied by the specifications and as represented by the drawings or according to such other additional particulars, and instructions as may from time to time be given by the Employer/Architects during the execution of the work, and to his entire satisfaction.

If required by the Employer/Architects the empanelled contractor shall have to carry out tests on materials and workmanship in approved materials testing laboratories or as prescribed by the Employer/Architects at his own cost to prove that the materials etc., under test conform to the relevant I.S Standards or as specified in the specifications. The necessary charges for preparation of transporting, testing, etc., shall have to be borne by the empanelled contractor. No extra payment on this account should in any case be entertained.

All the materials stores and equipment required for the full performance of the work under the contract must be provided through normal channel and must include charge for import duties, sales tax, octroi and other charges and must be the best of their kind available and the empanelled contractor/s must be entirely responsible for the proper and efficient carrying out of the work. The work must be done in the best workmanlike manner. Samples of all materials to be used must be submitted to the Employer/Architects when so directed by the Engineer/Architects and written approval from Employer/Architects must be obtained prior to placement of order.

Should the work be suspended by reason of rain, strike, lock-outs or any other cause, the empanelled contractor shall take all precautions necessary for the protection of work and at his own expenses shall make good any damage arising from any of these causes.

The empanelled contractor shall cover up and protect from damage, from any cause, all new work and supply all temporary/doors, protection to windows and any other requisite protection for the extension of the work whether by himself or special tradesmen or sub empanelled contractor and any damage caused must be made good by the empanelled contractor at his own expenses.

20. REMOVAL OF IMPROPER WORK:

The employer shall during the progress of the work have power to order in writing from time to time the removal from the work within such reasonable time or times as may be specified in the order of any materials which in the opinion of the Employer/Architects are not in accordance with specifications or instructions, the substitution or proper re-execution of any work executed with materials or workmanship not in accordance with the drawings and specifications or instructions. In case the empanelled contractor refuses to comply with the order the employer shall have the power to employ and pay other agencies to carry out the work and all expenses consequent thereon or incidental thereto as certified by the Employer/Architects shall be borne by the empanelled contractor or may be deducted from any money due to or that may become due to the empanelled contractor. No certificate which may be given by the Architects shall relieve the empanelled contractor from his liability in respect of unsound work or bad materials.

21. SITE ENGINEER:

The term 'Site Engineer' shall mean the person appointed and paid by the Employer to superintend the work. The empanelled contractor shall afford the Site Engineer every facility and assistance for examining the works and materials and for checking and measuring work and materials. The Site Engineer shall have no power to revoke, alter, enlarge or relax any requirements of the empanelled contractor or to sanction any day work, additions, alterations, deviations or omission any extra work whatever, except in so far as such authority may be specifically conferred by a written order of the Employer.

The site engineer shall have power to give notice to the empanelled contractor or to his foreman, of non-approval of any work or materials and such work shall be suspended or the use of such materials shall be discontinued until the decision of the Employer is obtained. The work will from time to time be examined by the Architects, Engineer from the premises department of the Employer and the Site Engineer. But such examination shall not in anyway exonerate the empanelled contractor from the obligation to remedy any defects which may be found to exist at any stage of the work or after the same is complete. Subject to the limitation of this clause the empanelled contractor shall take instructions only from the Architects/Engineer.

22. CONTRACTOR'S EMPLOYEES:

The empanelled contractor shall employ technically qualified and competent supervisors for the work who shall be available (by turn) throughout the working hours to receive and comply with the instructions of the Employer/Architects. The empanelled contractor shall engage at least one experienced Engineer as site-in-charge for the execution of the work. The empanelled contractor shall employ in connection with the work person having the appropriate skill or ability to perform their job efficiently.

The empanelled contractor shall employ local labourers on the work as far as possible.

No labour below the age of 16 years and who is not an Indian National shall be employed on the work.

Any labourer applied by the empanelled contractor to be engaged on the work on day-work basis either wholly or partly under the direct order or control of the Employer or his representative shall be deemed to be a person employed by the empanelled contractor.

The empanelled contractor shall comply with the provision of all labour legislation including the requirements of

- a. The payment of Wages Act
- b. Employer's Liability Act
- c. Workman Compensation Act
- d. Contract Labour (Regulation & Abolition) Act, 1970 & Central Rules 1971.
- e. Apprentices Act 1961
- f. Any other Act or enactment relating thereto and rules framed there under from time to time.

The empanelled contractor shall keep the Employer saved harmless and indemnified against claims if any of the workmen and all costs and expenses as may be incurred by the Employer in connection with any claim that may be made by any workmen.

The empanelled contractor shall arrange to provide first aid treatment to the labourers engaged on the works. He shall within 24 hours of occurrence of any accident at or about the site or in connection with execution of the works, report such accident to the Employer and also to the competent authority where such report is required by law.

23. DISMISSAL OF WORKMEN:

The empanelled contractor shall on the request of the Employer immediately dismiss from works any person employed thereon by him, who may in the opinion of the Employer be unsuitable or incompetent or who may misconduct himself. Such discharge shall not be basis of any claim for compensation or damages against the Employer or any of the officer or employee.

24. ASSIGNMENT:

The whole of the works included in the contract shall be executed by the empanelled contractor and the empanelled contractor shall not directly or indirectly transfer, assign or undersert the contract or any part, share or interest therein nor, shall take a new partner, without written consent of the Employer and no subletting shall relieve the empanelled contractor from the full and entire responsibility of the contract or from active superintendence of the work during their progress.

25. DAMAGE TO PERSONS AND PROPERTY INSURANCE ETC.,

The empanelled contractor shall be responsible for all injury to the work or workmen to persons, animals or things and for all damages to the structural and/or decorative part of property which may arise from the operations or neglect of himself or of any sub-empanelled contractor or of any of his or a sub-empanelled contractor's employees, whether such injury or damage arise from carelessness, accident or any other cause whatsoever in any way connected with carrying out of this contract. The clause shall be held to include inter-alia, any damage to building whether immediately adjacent or otherwise, and any damage to roads, streets, foot paths or ways as well as damages caused to the buildings and the works forming the subject of this contract by rain wind or other inclemency of the weather. The empanelled contractor shall indemnify the Employer and hold harmless in respect of all and any expenses arising from any such injury or damages to persons or property as aforesaid and also in respect of any claim made in respect of injury or damage under any acts of compensation or damage consequent upon such claim.

The empanelled contractor shall reinstate all damage of every sort mentioned in this clause, so as to deliver the whole of the contract works complete and perfect in every respect and so as to make good or otherwise satisfy all claims for damages to the damages to the property or third parties.

The empanelled contractor shall effect the insurance necessary and indemnify the Employer entirely from all responsibility in this respect. The insurance must be placed with a company approved by the Employer and must be effected jointly in the name of the empanelled contractor and the employer and the policy lodged with the latter. The scope of insurance is to include damage or loss to the contract itself till this is made over in a complete state. Insurance is compulsory and must be effected from the very initial stage. The empanelled contractor shall also be responsible for anything which may be excluded from damage to any property arising out of incidents, negligence or defective carrying out of this contract.

The employer shall be at liberty and is hereby empowered to deduct the amount of any damages, compensations, costs, charges and expenses arising or accruing from or in respect of any such claim or damages from any sums due or to become due to the empanelled contractor.

26. INSURANCE:

Unless otherwise instructed the empanelled contractor shall insure the works and keep them insured until the virtual completion of the empanelled contractor against loss or damage by fire and/or earthquake, flood. The insurance must be placed with a company approved by the Employer, in the joint names of the Employer and the empanelled contractor for such amount and for any further sum if called to do so by the employer, the premium of such further sum being allowed to the empanelled contractor as an authorized extra.

The empanelled contractor shall deposit the policy and receipt for premium paid with the Employer within 30 (thirty) days from the date of issue of work order unless otherwise instructed. In default of the empanelled contractor insuring as provided above, the employer on his behalf may so insure and may deduct the premiums paid from any money due, or which may become due to the empanelled contractor. The empanelled contractor shall as soon as the claim under the policy is settled or the work reinstated by the Insurance company should they elect to do so, proceed with due diligence with the completion of the works in the same manner as though the fire has not occurred and in all respects under the conditions of the contract. The empanelled contractor in case of rebinding or reinstatement after fire shall be entitled to extension of time for completion as the Employer may deem fit.

27. ACCOUNTS RECEIPTS AND VOUCHERS:

The empanelled contractor shall upon the request of the employer furnish them with all invoices, receipts, accounts and other vouchers that may require in connection with the work under this contract. If the empanelled contractor shall use materials less than what he is required under the contract, the value of the work difference in the quantity of the materials he was required to use and that he actually used shall be deducted from his dues. The decision of the Employer shall be final and binding on the empanelled contractor as to the amount of materials the empanelled contractor is required to use for any work under this contract.

Before taking any measurement of any work the site Engineer or a subordinate deputed by him shall give reasonable notice to the empanelled contractor. If the empanelled contractor fails to attend at the measurements after such notice or fails to counter sign or to record the difference within a week from the date of measurement in the manner required by the site engineer then in any such event the measurements taken by the site engineer or by the subordinate deputed by him as the case may be is final and binding on the empanelled contractor and the empanelled contractor shall have no right to dispute the same.

28. PAYMENTS:

All bills shall be prepared by the empanelled contractor in the form prescribed by the Employer/Architects. Normally one interim bill shall be prepared each month subject to a minimum value for interim certificate as stated in these documents. The bills in proper forms must be duly accompanied by detailed measurements in support of the quantities of work done and must show deductions for all previous payments, retention money, etc.,

The Employer/Architects shall issue a certificate after due scrutiny of the empanelled contractor's bill stating the amount due to the empanelled contractor from the Employer and the empanelled contractor shall be entitled to payment thereof, within the period of honoring certificates named in these documents.

The amount stated in an interim certificate shall be the total value of work properly executed and 75% of invoiced value of material brought of site for permanent incorporation into the work up to the date of the bill less the amount to be retained by the Employer as retention money vide clause 12 of these conditions, provided that such certificate shall only include the value of said material and good as and from such time as they are reasonably, properly and not prematurely brought to or places adjacent to the work and then only if adequately protected against weather or other causalities.

The employer will deduct retention money as described in clause 12 of these conditions. The refund of retention money will be made as specified in the same clause.

If the Employer has supplied any materials or goods to the empanelled contractor, the cost of any such materials or goods will be progressively deducted from the amount due to the empanelled contractor in accordance with the quantities consumed in the work.

No interim payments shall be encouraged and all the payments are made against the final payment only and not as payments for work actually done and completed, and shall not preclude the requiring of bad, unsound, and imperfect or unskilled work to be removed and taken away and reconstructed, or reelected or be considered as an admission of the due performance of the contract, or any part thereof in any respect or the accruing of any claim, nor shall, it conclude determine or affect in anyway the power of the Employer under these conditions or any of them as to the final settlement and adjustment of the accounts or otherwise or in any other way vary or affect the contract. The final bill shall be submitted by the empanelled contractor within one month of the date fixed for completion of the work or of the date of certificate of completion furnished by the Site Engineer and payment shall be made within three months.

29. FINAL PAYMENT:

The final bill shall be accompanied by a certificate of completion from the Employer/Architects. Payments of final bill shall be made after deduction of Retention Money as specified in clause 12 of these conditions, which sum shall be refunded after the completion of the Defects Liability Period of Twelve (12) months after receiving the Employer's/Architects certificate that the empanelled contractor has rectified all defects to the satisfaction of the Employer/Architects. The acceptance of payment of the final bill by the empanelled contractor would indicate that he will have no further claim in respect of the work executed.

30. VARIATION / DEVIATION:

The price of all such additional items/non-tendered items will be worked out on the basis of rate quoted for similar items in the contract whether existing or on engineering rate analysis based on prevalent fair price of labour, material and other components as required. The tender rates, shall hold good for any increase or decrease in the tendered quantities up to variation of +05%., For variation beyond ± 05%, the rate for the respective item may be reviewed on mutually agreed terms.

31. SUBSTITUTION:

Should the empanelled contractor desire to substitute any materials and workmanship, he/they must obtain the approval of the Employer/Architects in writing for any such substitution well in advance. Materials designated in this specification indefinitely by such term as “Equal” or “Other approved” etc., specific approval of the Employer/Architects has been obtained in writing.

32. PREPARATION OF INTERIOR WORKS FOR OCCUPATION & USE ON COMPLETION:

The whole of the work will be thoroughly inspected by the empanelled contractor and deficiencies and defects put right. On completion of such inspection the empanelled contractor shall inform the Employer that he has completed the work and it is ready for inspection. On completion the empanelled contractor shall clean all windows and doors including the cleaning and oiling if necessary, of all hardware, inside and outside, all floor, stair cases, and part of the building. He will leave the entire building neat and clean and ready for immediate occupation and to the satisfaction of the bank.

33. CLEARING SITE ON COMPLETION:

On completion of the works the empanelled contractor shall clear away and remove from the site all surplus materials, rubbish and temporary works of every kind and leave the whole of the site and the works clean and in a workman like condition to the satisfaction of the Employer/Architects.

34. DEFECTS AFTER COMPLETION:

The empanelled contractor shall make good at his own cost and to the satisfaction of the Employer all defects, shrinkage, settlements or other faults which may appear within 6 months after completion of the work. In default the Employer may employ and pay other persons to amend and make good such damages, losses and expenses consequent thereon or incidental thereto shall be made good and borne by the empanelled contractor and such damages, loss and expenses shall be recoverable from him by the Employer or may be deducted by the employer, in lieu of such amending and making good by the empanelled contractor, deduct from any money due to the empanelled contractor a sum equivalent to the cost of amending such work and in the event of the amount retained being insufficient, recover that balance from the empanelled contractor from the amount retained under clause No. 12 together with any expenses the Employer may have incurred in connection therewith.

35. CONCEALED WORK:

The empanelled contractor shall give due notice to the Employer/Architects whenever any work is to be buried in the earth, concrete or in the bodies of walls or otherwise becoming inaccessible later on, in order that the work may be inspected and correct dimensions taken before such burial, in default whereof the same shall, at the opinion of the Employer/Architect be either opened up for measurement at the empanelled contractor's expense or no payment may be made for such materials. Should any dispute to differences arise after the execution of any work as to measurements etc., or other matters which cannot be conveniently tested or checked, the notes of the Employer/Architects shall be accepted as correct and binding on the empanelled contractor.

36. FISCALATION:

The rate shall be firm throughout the tenure of the contract (including extension of time, if any, granted) and will not be subject to any fluctuation due to increase in cost of materials, labour, sales tax, octroi, etc., unless specifically provided in these documents.

37. IDLE LABOUR:

Whatever the reasons may be, no claim for idle labour, additional establishment cost of hire and labour charges of tools and plants would be entertained under any circumstances.

38. SUSPENSION:

If the empanelled contractor except on account of any legal restraint upon the Employer preventing the continuance of the work or in the opinion of the Employer shall neglect or fail to proceed with due diligence in the performance of his part of the contract or if he shall more than once make default, the Employer shall have the power to give notice in writing to the empanelled contractor requiring the work be proceeded within a reasonable manner and with reasonable dispatch, such notice purport to be a notice under this clause. After such notice shall have been given the empanelled contractor shall not be at liberty to remove from the site of the works or from any ground contiguous thereto any plant or materials to subsist from the date of such notice being given until the fall for 7 (seven) days after such notice has been given to proceed with the works as therein prescribed, the Employer may proceed as provided in the following.

38. TERMINATION OF CONTRACT BY EMPLOYER:

If the empanelled contractor being a company go into liquidation whether voluntary or compulsory or being a firm shall be dissolved or being an individual shall be adjudicated insolvent or shall make an assignment or a composition for the benefit of the greater part, in number of amount of his creditors or shall enter into a Deed or arrangement with his creditors, or if the Official Assignee in insolvency, or the Receiver of the empanelled contractor in insolvency, shall repudiate the contract, or if a receiver of the empanelled contractor's firm appointed by the court, shall be unable within fourteen days after notice to him requiring him to do so, to show to the reasonable satisfaction of the employer that he is able to carry out and fulfill the contract, and if so required by the employer to give reasonable security there for, or if the empanelled contractor shall suffer execution to be issued, or shall suffer any payment under this

contract to be attached by or on behalf of and of the creditors of the empanelled contractor, or shall assign, charge or encumber this contract or any payments due or which may become due to the empanelled contractor, there under, or shall neglect or fail to observe and perform all or any of the acts matters of things by this contract, to be observed and performed by the empanelled contractor within three clear days after the notice shall have been given to the empanelled contractor in manner hereinafter mentioned requiring the empanelled contractor to observe or perform the same or shall use improper materials or workmanship in carrying on the works, or shall in the opinion of the employer not exercise such due diligence and make such due progress as would enable the work to be completed within due time agreed upon and shall fail to proceed to the satisfaction of the employer after three clear days notice requiring the empanelled contractor so to do shall have been given to the empanelled contractor as hereinafter mentioned, or shall abandon the contract, then and in any of the said cases, the bank may notwithstanding previous waiver determine the contract by a notice in writing to the effect as hereinafter mentioned, but without thereby effecting the powers of the employer of the obligations and liabilities of the empanelled contractor the whole of which shall continue in force as fully as if the contract, had not been so determined and as if the works subsequently executed had been executed by or on behalf of the empanelled contractor (without thereby creating any trust in favour of the empanelled contractor) further the employer or his agent, or servants, may enter upon and take possession of the work and all plants, tools, scaffolding, sheds, machinery, steam and other power, utensils and materials lying upon premises or the adjoining lands or roads and sell the same as his own property or may employ the same by means of his own servants and workmen in carrying on and completing the works or by employing any other empanelled contractors or other persons or person to complete the works, and the empanelled contractor shall not in any way interrupt or do any act, matter or things to prevent or hinder such other empanelled contractors or other persons or person employed from completing and furnishing or using the materials and plants for the works when the works shall be completed, or as soon thereafter as conveniently may be, the employer shall give notice in writing to the empanelled contractor to remove his surplus materials and plants and should the empanelled contractor for the amount so realized. Any expenses or losses incurred by the employer in getting the works carried out by other empanelled contractors shall be adjusted against the amount payable to the empanelled contractor by way of selling his tools and plants or due on account of work carried out by the empanelled contractor prior to engaging other empanelled contractors or against the Security Deposit.

40. ARBITRATION:

All disputes or differences of any kind whatsoever which shall at any time arise between the parties hereto touching or concerning the works or the execution or maintenance thereof of this contract of the rights touching or concerning the execution or maintenance thereof of this contract of the construction remaining operation or effect thereof or to the rights or liabilities of the parties to arising out of or in relation thereto whether during or after determination foreclosure of branch of the contract (other than those in respect of which the decision of any person is by the contract expressed to be final and binding) shall after written notice by either party to the contract to other of them and to the Employer hereinafter mentioned be referred for adjudication to a sole Arbitrator to be appointed as hereinafter provided.

For the purpose of appointing the sole Arbitrator referred to above, the Employer will send within thirty days of receipt of the notice, to the empanelled contractor a panel of three names of persons who shall be presently unconnected with the organization for which the work is executed.

The empanelled contractor shall on receipt of the names as aforesaid, select any one of the persons name to be appointed as a sole Arbitrator and communicate his name to the Employer within thirty days of receipt of the names. The Employer shall thereupon without any delay appoint the said person as the Sole Arbitrator. If the empanelled contractor fails to communicate such selection as provided above within the period specified, the competent authority shall make the selection and appoint the selected person as the Sole Arbitrator.

If the Arbitrator so appointed is unable or unwilling to act or resign his appoint or vacates his office due to any reason whatsoever another Sole Arbitrator shall be appointed as aforesaid.

The work under the Contract shall, however continue during the arbitration proceedings and no payment due to or payable to the empanelled contractor shall be withheld on account of such proceedings.

The Arbitrator shall be deemed to have entered on the reference on the date he issued notice to both the parties fixing the date of the first hearing.

The Arbitrator shall give a separate award in respect of each dispute or difference referred to him. The Arbitrator shall decide each dispute in accordance with the terms of the contract and give a reasoned award. The venue of arbitration shall be such place as may be fixed by the Arbitrator in his sole discretion.

The fees, if any, of the Arbitrator shall, if required to be paid before the award is made and published, be paid half and half by each of the parties. The cost of the reference and of the award including the fees, if any, of the Arbitrator who may direct to and by whom and in what manner, such costs or any part thereof shall be paid and may fix of settle and amount of costs to be so paid.

The award of the Arbitrator shall be final and binding on both the parties. Subject to aforesaid the provisions of the Arbitration Act 1940 or any statutory modification or reenactment thereof and the rules made there under and for the time being in for, shall apply to the arbitration proceeding under this clause.

The Employer and the empanelled contractor hereby also agree that arbitrator under clause shall be condition precedent to any right to action under the contract with regard to the matters hereby expressly agreed to be so referred to arbitration.

I/we hereby declare that I/we read and understood the above terms and conditions and that we shall abide them if the works is awarded to us.

4. SAFETY CODE:

Personal Safety Equipment's:

All necessary personal safety equipments as considered adequate by the Engineer should be kept available for the use of the person employed on the site and maintained in a condition suitable for immediate use, and the empanelled contractor should take adequate steps to ensure steps to ensure proper use of equipments by those concerned.

The empanelled contractor shall not employ men below the age of 18 years and women on the work of painting with products containing lead in any form. Wherever men above the age of 18 are employed on the work of lead painting the following precautions should be taken:

First Aid:

- a. At every work place, there shall be maintained in readily accessible place first aid appliance including and adequate supply of sterilized dressings and sterilized cotton wool. The appliance shall be kept in good order and in large work place they shall be placed under the charge of a responsible person who shall be readily available during working hours.
- b. At large work places, where hospital facilities are not available within easy distance of the works, first aid posts shall be established and be run by a trained compounder.

In every work place, there shall be provided and maintained at suitable places easily accessible to labour sufficient of cold water fit for drinking.

**Empanelled contractor's Seal and
Signature.**

5. SPECIFICATION AND WORKMANSHIP

GENERAL SPECIFICATIONS:

1. GENERAL:

These specifications are for work to be done, if item to be supplied and materials to be used in the works as shown and defined on the drawings and described herein, to the satisfaction of the Bank/Architect.

The workmanship is to be the best possible and of a high standard. The empanelled contractor shall take all steps immediately to make up deficiency if any noticed by the Bank/Architects. Use must be made up of special tradesmen in all aspects of the work and allowances must be made in the rates for the same.

The materials is to be the best possible and of a high standard. The empanelled contractor shall take all steps immediately to make up deficiency if any noticed by the Bank/Architects. Use must be made up of special tradesmen in all aspects of the work and allowances must be made in the rates for the same.

The materials to be provided by the empanelled contractor shall be accordance with the samples already got approved from the Bank/Architect by the empanelled contractor and in conformity with specifications and approved list of manufactures and brand. The empanelled contractor shall produce all invoices, vouchers or receipts for any material if called upon to do so by the Bank/Architect.

Samples of all materials are to be submitted to the Bank/Architects for their approval before the empanelled contractor orders or delivers the material to the site. Samples together with their packings are to be provided free of charge by the empanelled contractor and should any materials be rejected they will be removed from the site at the empanelled contractor expense. All samples will be retained by the Bank/Architects for comparison with materials which will be delivered at site. Also the empanelled contractor will be required to submit specimen finished of colors, fabrics, etc., for the approval of the Bank/Architects before proceeding with the works.

The empanelled contractor shall be responsible for providing and maintaining temporary coverages required for the protection of finished work. He is also to clean out all word shavings, cuts ends and other waste from all parts of the works before covering or infilling are constructed.

Empanelled contractor shall maintain uniform quality and consistency in workmanship throughout the execution of the work.

ARTICLES OF AGREEMENT

Articles of Agreement made at Rajahmundry this day of _____ between The Assistant General Manager, Indian Bank, Zonal Office, Rajahmundry –535101. (hereinafter referred to as “The Employer” which expression shall unless excluded or repugnant to the context be deemed to include its successors and assigns) of the one part, and M/s _____ carrying on business at _____ (hereinafter referred to as the “Empanelled contractor” which expression shall unless excluded or repugnant to the context be deemed to include their heirs, executors, administrators, representatives and assigns) of the other part.

WHEREAS

1. The Employer is desirous of carrying out the Interior/Furnishing works for Indian Bank, Zonal Office, Rajahmundry and has drawings and specifications, schedule of quantities describing the work to be done, have been prepared by the Consultant M/s SRR ARCHITECTNIQUES, 101 & 102, GOKUL KUNJ, STREET NO-5, HARDIKARBAGH, HIMAYATNAGAR, HYDERABAD-500 029 ,TELENGANA PH: 040-40072083, 9959554845 under the direction of the Employer. The Employer is desirous of completing the said work strictly and according to the said drawings and specifications.

2. The empanelled contractors in their tender dated__ and negotiations through letter on _____ have agreed to execute the said works as per said drawings specification and schedule of quantities, rates and subject to the conditions set forth in the special conditions of contracts (all of which are collectively hereinafter referred to as “the said conditions”). The special conditions and condition of contract have been pursued, examined and accepted by the empanelled contractor. Total tender value is accepted as Rs. _____ (Rupees _____ only).

3. The empanelled contractors has deposited Rs. _____ (Rupees _____ only) with the Employer Security Deposit for performance of this agreement.

NOW IT IS HEREBY MUTUAL AGREED AND DECLARED BETWEEN THE PARTIES HERETO AS FOLLOWS:

1. The empanelled contractor hereby agrees and undertakes to execute and complete the said works shown in the said drawings and such further detailed drawings as may be furnished to it by the Employer and described in the said specification and the said schedule of quantities upon and subject to the said conditions.

2. The Employer shall for such interior works, pay to the empanelled contractor such sums as shall become payable at time, in the manner specified in the said conditions.

3. The said tender and allied documents, drawings, specification, prices schedule of quantities, agreement and documents above mentioned, shall from the basis of this contract and the decision of the Employer as mentioned in the condition of contract with reference to the clauses of this agreement or the said conditions shall be final and binding on both the parties.

4. The contract herein contained, comprises of the said work above mentioned and all subsidiary works connected therewith in the same site may be ordered to be done from time to time by the Employer even though such works may not be shown in the said drawings or described in the said specifications or the schedule of quantities. The empanelled contractor hereby agrees and undertakes to do and perform all such works in a thorough and work man like manner. With best materials and within the time limit herein mentioned.

5. The employer reserved to himself the right after the drawings and nature of the work and of adding or omitting any item of work or of having portions of the same carried out departmentally or otherwise and such alterations and such alterations or variations shall be carried out without prejudice to this contract.
6. The said conditions shall be read and constructed as forming part of this agreement and parties hereto will respectively abide by and submit themselves to the conditions and stipulations and perform the agreements on their parts respectively as such conditions contained.
7. It will be the entire responsibility of the empanelled contractor to procure all materials required for the said works.
8. The empanelled contractor shall complete the said work within 30 days from the date of commencement of work as per work order for the work and will remove from the site all plants, scaffoldings, materials, in use rubbish and leave the work site clean within the said period.
9. All disputes arising out of or in anyway connected with this agreement shall be deemed to have arisen in Madras and only in courts in Calcutta shall have jurisdiction to determine the same.
10. The several parts of this contract have been read and fully understood by us.
11. The work-order issued to the empanelled contractor shall be treated as part of this agreement.

In witness where of the parties hereto have set their respective hands on the day month and year above written.

Signed and Delivered by

The Indian Bank

Signed and Delivered by

The Empanelled contractor

In the presence of Witness

In the presence of Witness

INDIAN BANK APPROVED MATERIALS

LIST OF APPROVED MANUFACTURERS OF MATERIALS TO BE USED IN THE INTERIOR WORKS SUBJECT TO THE APPROVAL OF SAMPLES BY THE CONSULTANT/ ENGINEER

PLYWOOD ISI MARKED AND AS PER IS 710, BWP GRADE(GURJAN CORE)	GREEN PLY, CENTURY PLY, ARCHID
ALUMINIUM SECTIONS	JINDAL
FIBRE REINFORCED CEMENT SHEETS	CENTURY ZYKRON,
LAMINATE	SUNMICA / GREENLAM / ROYAL TOUCH / DURIAN / ARCHID / BLOOM / CENTURY / MERINO
ALL LOCKS	GODREJ, EBCO, DOORSET FOR DOORS, STORAGES.
SLIDING TELESCOPIC CHANNEL	EBCO, EARL BIHARI
DOOR CLOSER	HARDWIN/ EVERITE/ DORMA/EFFICIENT GADGETS.
HANDLES	BRUSH STEEL FINISHED OF DOORSET, KITCH, KIRCHEFF, HATRDWIN
PATCH FITTING	EBCO, GODREJ, HARDWIN
GLASSES	MODI, SAINT GOBAIN
HINGES	BRASS
TOWER BOLT	BRASS
ALL SCREW	GKW/ NETTLE FOLD
PAINT	ASIAN, NEROLAC
MELAMINE	ASIAN IN MATT FINISH
CASTER	REXELO, SRU
VERTICAL BLINDS	VISTA LEVALOR, MAC, MARC
ADHESIVES	FEVICOL
MAGNETIC CATCHER	MUKUND
POLYURETHANE	U FOAM
FOAM	KING FOAM
MINERA FIBRE TILES	ARMSTRONG
GYPSON BOARD	SAINT GOBAIN GYPSON.
24"X24" GRID CEILING BOARD	ARMSTRONG
TEXTURE(EXTERIORS&INTERIORS)	SPECTRUM , WALL TEXTURES.
ROLLER TEXTURE	ICI DUET, BURGER PAINTS.
WOODEN BEADING	STEAM BEECH WOOD.
SIGNATURE OF THE CONTRACTOR	

LIST OF APPROVED MANUFACTURERS OF MATERIALS TO BE USED IN THE ELECTRICAL WORKS SUBJECT TO THE APPROVAL OF SAMPLES BY THE CONSULTANT/ ENGINEER

<u>S.No.</u>	<u>Material Name.</u>	<u>Brand / Manufacturer / Recommended Make.</u>
1.	Switches/ Sockets	Legrand Myrius
2.	Copper Conductor wires	Finolex FRLSH/ KEI FRLS
3.	PVC conduits, Casing, Capping & Accessories	Precision / Sudhakar/ Avon plast/ FINOLEX
4.	MS Conduits	AKG/BEC/Vimco
5.	Metal clad Sockets	Legrand EkinoX ³
6.	MCBs /MCB Distribution boards	Legrand EkinoX ³
7.	MCCBs/Switchgear	Legrand EkinoX ³
8.	Underground Cables	CCI /Nicco /Havells/ Universal/ Poly Cab/ V-Guard/Finolex
9.	Cable Glands	HMI /Comet/ Cosmos/Dowells (Biller India)/ Hax Brass (Copper Alloy India)
10.	Capacitor Bank	Epcos /Neptune/ Tibcon
11.	Cable Lugs	Dowell's / 3D
12.	MV Panels (PCCs)	Manufacturers with CPRI Test Certificate.
13.	ELRs/CBCT	Prokdvs/Nagoba
14.	Measuring Instruments	Conzerv/ CMS/ El measure/IME/ L&T/ Nippen/ Schneider Electric
15.	Selector Switches	Vaishno / Salzer / Kaycee
16.	Indication Lamps LED (protected type)	Schneider / Vaishno / Binay
17.	Resin cast CTs	AE / Kappa
18.	Telephone Wires	Lapp / Delton / Poly cab/ Finolex
19.	Light Fixtures (LED)	Philips / Havells/ Wipro
20.	Ceiling Fans, Wall mounted fans & Exhaust Fans	Havells/ Orient

SIGNATURE OF THE CONTRACTOR

LIST OF APPROVED MANUFACTURERS OF MATERIALS TO BE USED IN THE AIR-CONDITIONING WORKS SUBJECT TO THE APPROVAL OF SAMPLES BY THE CONSULTANT/ ENGINEER

<u>Material Name.</u>	<u>Brand / Manufacturer / Recommended Make.</u>
SPLIT AIR CONDITIONER	DAIKIN INVERTER-5 STAR
VRV AIR CONDITIONER	DAIKIN
SIGNATURE OF THE CONTRACTOR	

NOTE : The contractor shall use only above mentioned material .make to be approved by the Consultant/ bank. All other materials shall confirm to the specifications laid down. The tenderer shall take this into account while tendering rates / prices. The Consultant / Owner has got every right to select any of the above Makes for the Project. However the samples of every material including all fixing accessories shall be got approved by Owner / Consultant before Execution. As far as possible multiple brands should not be used at site in each category.

PROPOSED INTERIOR FURNISHING, ELECTRICAL & AIR CONDITIONING WORKS FOR INDIAN BANK REGIONAL OFFICE, MAPC & RAPC AT RAJAHMUNDRY, ANDHRA PRADESH.		
ABSTRACT ESTIMATE		
S.No	Description of item	Amount (In Rupees)
1	INTERIOR FURNISHING WORKS	
2	ELECTRICAL WORKS	
3	AIR CONDITIONING WORKS	
	TOTAL	
	IF ANY DISCOUNT	
	GRAND TOTAL	
Note:1	The Quantities of the above items may be increased or decreased as per site condition and the bank has got the right to delete or increase/ decrease any quantity as per the convenience at the branch. However the contractor shall have binding over the rates quoted by them.	
Note:2	The maker of all the material Specified above shall be followed as per the list of material approved and enclosed here with	
Note:3	The above rates are inclusive of GST.	

SIGNATURE OF THE CONTRACTOR

PROPOSED INTERIOR FURNISHING WORKS FOR INDIAN BANK, REGIONAL OFFICE, MAPC & RAPC AT RAJAHMUNDRY, ANDHRA PRADESH					
SCHEDULE OF QUANTITIES, SPECIFICATIONS AND ESTIMATE: INTERIOR FURNISHING WORKS					
Sl. No.	Description of item	Unit	Quantity	Rate	Amount
				(in Rs.)	(in Rs.)
	<u>INTERIOR FURNISHING WORKS:</u>				
1	<u>Solid Full Height Partition</u>				
	Providing & fixing partitions with 100mm x 50mm x 1.5mm thk extruded aluminum box section framework at spacing not exceeding 600mm both ways (horizontal and vertical), at the floor & soffit, all complete as per detail dwg. & manufacturers specification with 8 mm thk. fibre reinforced cement sheets (asbestos free - confirms to ISI 14862) skinning is finished using proprietary supplied jointing tape & jointing compound as per manufacturer's specification and apply putty and paint				
	Item including all necessary Stainless Steel finish fittings/ hardware, door closers, Godrej locks and paint etc. as per list of approved material and as approved by the Project Consultant/ Bank officer complete for finished item of work in all respects.				
	Note: In case of false ceiling, the Vertical sal wood members to be fixed with pucca ceiling but the area of partition payable will be below the false ceiling only). Exposed clear measurements only shall be considered for payment				
	EDP AND SERVER, UPS ROOM, PANTRY/ LUNCH ROOM, DGM CABIN, MAIN ENTRANCE FRONT AND REST ROOM	SQM	114.22		
2	<u>SOLID FULL HEIGHT PARTITION</u>				
	Providing & fixing in position solid Full height Double Skin Partition in frame work including door in 2' x 2' grid (horizontally and vertically) comprising of 2" x 2" (thickness not less than 1.5mm) aluminium Section frame work of approved make with 9mm thick BWP Grade make plywood on both sides finished with 1mm thick laminates of approved make and colour. All exposed beech wood surfaces to be finished in melamine polish of matching laminate colour as directed including all necessary Stainless Steel finish fittings/ hardware, door closers, Godrej locks and wood preservative paint etc. as per list of approved material and as approved by the				

	Project Consultant/ Bank officer complete for finished item of work in all respects.				
	Note: In case of false ceiling, the Vertical sal wood members to be fixed with pucca ceiling but the area of partition payable will be below the false ceiling only). Exposed clear measurements only shall be considered for payment.				
	Z.M CABIN AND REST ROOM	SQM	16.64		
3	<u>PARTLY GLAZED FULL HEIGHT PARTITION:</u>				
	Providing & fixing partitions with 100mm x 50mm x 1.5mm thk extruded aluminum box section framework at spacing not exceeding 600mm both ways (horizontal and vertical), at the floor & soffit, all complete as per detail dwg. & manufacturers specification. with 8 mm thick fibre reinforced cement sheets (asbestos free - confirms to ISI 14862) skinning is finished using proprietary supplied jointing tape & jointing compound as per manufacturer's specification and apply putty and paint				
	Item to include 8mm thick Saint gobain Make glass with etching and frosting as per design and 2" x 2"(thickness not less than 1.5mm) aluminium Section frame work of approved make, door frame to take 8mm thick Saint gobain make glass with etching and frosting.				
	Item including all necessary Stainless Steel finish fittings / hardware, door closers, Godrej.				
	Locks and paint etc. as per list of approved Consultant/ Bank officer complete for finished item of work in all respects.				
	(Note: In case of false ceiling, the vertical members to be fixed with pucca ceiling but the area of partition payable will be below the false ceiling only). Exposed clear measurements only shall be considered for payment.				
	CONFERENCE ROOM AND CM CABINS	SQM	34.80		
4	<u>FULL HEIGHT GLASS PARTITION</u>				
	Glass Partition- Providing and fixing of 12mm thk toughened glass partition Bottomline. 45 series anodised finish as per approved sample and design. The thickness, sizes and fixing of profiles to the floor/wall/ceiling are to be as per the architect design and manufacturer specification.				

	Glass Door- Providing and fixing of Toughened glass door with 12mm thick toughened glass (top & bottom) and mounted on floor spring ozone FS-9400or equivalent (Ozone /dorma or equivalent) SS handles 2' long D handle (32mm x 600 mm Ozone or equivalent) all complete. Size of door 900 x 2100 mm				
	(Note: In case of false ceiling, the vertical members to be fixed with pucca ceiling but the area of partition payable will be below the false ceiling only). Exposed clear measurements only shall be considered for payment.				
	DGM CABIN AND CM CABINS WITH DOORS	SQM	23.05		
5	SOLID HALF HEIGHT PARTITION Providing and fixing in position solid low height partition (2½" thick) in frame work with 2' x 2' (thickness not less than 1.5mm) aluminium Section frame work of approved make with 9mm thick BWP plywood on both sides finished with 1mm thick laminates of approved make and shade as shown drawings. The exposed edges of the glass to be finished in mirror polish. Beech wood runner should be melamine polished in matching colour of laminate etc., complete for finished of work in all respects.	SQM	36.11		
6	PARTLY GLAZED HALF HEIGHT PARTITION Providing and fixing in position partly glazed low height partition (2½" thick) with 8mm thick Saint gobain Make glass with etching and frosting as per design in frame work with 2' x 2' (thickness not less than 1.5mm) aluminium Section frame work of approved make with 9mm thick BWP plywood on both sides finished with 1mm thick laminates of approved make and shade as shown drawings. The exposed edges of the glass to be finished in mirror polish. Beech wood runner should be melamine polished in matching colour of laminate etc., complete for finished of work in all respects.	SQM	65.52		
7	COVER FOR ROLLING SHUTTER: Providing, fabricating and fixing cover for rolling shutter made of 2"x2" aluminium frame work spaced at 18" c/c both directions, fixing 19mm thick BWP plywood and 1mm thick laminate(only outside) of approved shade with necessary locking arrangements. Separate flap door should be made for rolling	SQM	34.15		

	shutter to operate. The Shutters should be provided with locking arrangement.				
8	Doors in Partition				
	Providing and fixing 35mm thick solid core flush shutter with 85mm x 15mm beech wood jamb around and 12mm x 12mm button beading fixed with 1mm thk laminate on both sides and 8mm clear float glass with etching fixed and approved bank logo fixed as per drawing with 50mm x 15mm beech wood jamb around the glass opening and 12mm x 12mm beech wood beading for fixing of glass on both sides, including necessary hardware viz., door stopper, door closure, lock, handles, brass hinges (all of approved make and quality), melamine spray polish finish for all beech wood members, etc., complete as directed.				
8.1	ZM CABIN DOOR	SQM	1.95		
8.2	CONFERENCE ROOM DOORS	SQM	3.90		
8.3	UPS, EDP, PANTRY, REST ROOM AND DOORS	SQM	7.81		
9	Main Entrance Door	SQM	18.22		
	Providing and fixing 12 mm thick full glazed frame less toughened glass door shutter with all required patch fittings, heavy duty floor spring, locks, decorative SS handle of 600mm of approved brand, floor spring Locks, etc all complete, with etching design and bank logo with necessary sand blasting/granular blasting to be provided and edge should be machine beveled polished. The work to be completed as per design and specification of the Architect all complete.				
10.0	TABLES:				
	Providing and fixing in position Zonal Manager (7'-0" x 3'-0"), DGM Cabin (6'-0"x3'-0"), CM Table (5'-6" x 2'-9"), Work station table of size 4'-0" x 2'-3" using of table top 25mm thk BWP plywood with 1mm thk laminate, including Built in Storage (Credenza) by using 19 mm thick BWP plywood and sides & Front 19mm thick BWP plywood for all other horizontal and vertical members 12mm thick plywood Including Telescopic CPU Stand/ ready made keyboard tray shall be provided of approved model and make. Footrest ready made with T.W. member of size 4" x 1 ½" "finished with French polish.				

	<p>Side Storage (Credenza) as per drawing shall be provided. Facia of Side Storage (Credenza) shall be finished with 1mm thick laminates as shown drawing and all other sides shall be finished with white enamel paint. The Side Storage (Credenza) shall be provided with handles (Stainless Steel finish) and channels as per approval of the Project Consultant / Bank.</p> <p>All exposed plywood surfaces to be finished with 1mm thick laminate of approved make & shade and all exposed edges of table top & ply verticals to have 1" x ¼" beech wood lipping. All exposed beech wood sections to be melamine and Internal surfaces to have white enamel paint as directed. Item to include plywood boxing, all necessary hardware and fittings in Stainless Steel finish, lipping to all edges etc. complete for the finished item of work in all respects.</p>				
10.1	Z.M Table with table top glass (7'-0"X3'-0")	NO	1		
10.2	DGM Table with table top glass (6'-0"X3'-0")	NO	1		
10.3	CM TableS with table top glass (5'-6"X3'-0")	NO	6		
10.4	Work stations (4'-0"X2'-3")	NOS	39		
10.5	Conference Table (22'-0" x 4'-0")	NO	1		
	<p>Providing and fixing in position video conference table, size of 22'-0" x 4'-0" top using 19 mm thick plywood, side verticles 19mm thick BWR grade double layer with legs as shown in the drawings. Footrest made with T.W. member of size 4" x 1 ½" "finished with French polish</p> <p>All exposed plywood surfaces to be finished with 1mm thick laminate of approved make & shade and all exposed edges of table top & ply verticals to have 1" x ¼" beech lipping. All exposed beech sections to be melamined and Internal surfaces to have white enamel paint as directed. Item to include plywood boxing for cables, all necessary hardware and fittings in Stainless Steel finish, lipping to all edges etc. complete for the finished item of work in all respects.</p>				
11.0	Column/ Wall Paneling:	SQM	52.15		

	Providing and fixing partition in position as per design with 50mm x 50mm aluminium frame work of approved make with @ 600mm/c both ways screwed to the floor and ceiling with M.S.Cleats and to be treated with anti termite oil. The measurement will be taken up to the false ceiling visible height in case of full height partition. The frame work will be claded with 19mm thick BWP plywood and to be finished with approved 1.0mm laminate as per design with approved band adhesive. The work should be completed as per specification, design & approval of the Architect. Concealing down take elect/ data cables / Switch boards, etc.)				
12.0	False Ceiling:				
12.1	Gypsum Ceiling	SQM	221.67		
	Providing & fixing in position false ceiling in Gypboard 12mm thick for horizontal & verticals fixed over G.I. framework as specified by India Gypsum Co. Ltd. Including trap doors for A.C unit in 19mm thick BWP Grade plywood with Stainless Steel hinges & locks with moulding 1" x 1" for edges including finishing with Birla wall care putty 2 coats, White Plastic Emulsion Paint 3 coats etc. complete in all respects.				
	(Note:- Only the plan area will be measured for payment. No extra payment will be made for cutouts, grooves, mouldings etc.)				
12.2	Mineral Fiber Tiles:	SQM	139.41		
	Armstrong or Equivalent make False Ceiling of Trlock Sihouette Suspension System, Providing and Fixing in the true Horizontal level false ceiling system of Armstrong world industries. The suspension system shall be the Armstrong. Trulock Sihouette revealed profile grid system with 15mm wide flanges incorporating 3mm or 6mm central recess colour black revealed silhouette main runners and cross tees to have mitered cruciform junctions. Main runners to be spaced at 12mm c/c fixed by using 2mm pre straightened GI Wire. Main tee, rotary stitched of size 15mm x 38mm x 3000mm at every 1200mm c/c maximum and 600mm c/c cross tee of size 15mm x 38mm x 600mm at every 1200mm c/c maximum and 19mm x 19mm x 3000 wall angel all-round the wall to form grid size of 600mm x 600mm and suspending the grid using 2mm prestraightened Gi Wire and 6mm nylon raw plug at every 1200mm Intervals at the main tee laying of Armstrong mineral fiber SANDFINISH (DUNEMAX RH99) tiles manufactured by Armstrong world industries				

	of size 600mm x 600mm x 19mm over the formed grid completed as directed,				
	Making necessary framework for A.C. ducting, if any, and necessary cutouts for diffusers and light fittings, taping and finishing to proper line & level, including making grooves and trap doors for A.C. unit in 19mm Thick BWP Grade Plywood with Stainless Steel hinges & Locks with moulding 1" x 1" for edges including finishing with white Plastic Emulsion Paint etc. Complete in all respects.(Note:- Only the plan area will be measured for payment. No extra payment will be made for cutouts, grooves, mouldings etc.)				
13.0	Storage units:				
	Providing and fixing in position Full Height/ Low Height/ Back Storage as shown in Drg.s respectively using BWP Plywood 19mm thick verticals and horizontal and block board shutters finished with 1mm thick laminate approved colour and make as shown in the drawing and all other sides shall be finished with white enamel paint as detailed therein. The Storage Units shall be provided with handles(Stainless Steel finish)as per approval of the Project Consultant / Bank.				
	All exposed plywood surfaces to be finished with 1mm thk laminate approved shade and all exposed edges of plywood to have 1" x ¼" T.W./ beach wood lipping. All exposed T.W. sections to be melamine in matching colour laminate and internal surfaces to have white enamel paint as directed. Item to include all necessary hardware and fittings in Stainless Steel finish, Godrej multipurpose locks including magnetic ball catcher etc. the item including all taxes, service tax, labour charges, all necessary items, cost and conveyance, complete for the finished item of work.				
13.1	Full Height Storage	SQM	55.39		
13.2	Half Height Storage	SQM	31.25		
13.3	Back Storage	SQM	20.68		
14	Roller Blinds:	SQM	53.90		
	Supply and fixing of Roller Blinds of approved make Mac/ Vista, quality and colour shade & pattern. The roller blinds to be fitted on to aluminium powder coated channels with height adjustment ropes complete with installation hardware etc.,				

15	Cassette A.C paneling:	NOS	10.00		
	Providing and fixing Cassette A.C all round paneling used 19mm thick BWP plywood and to be finished with approved 1.0mm laminate as per design with approved band adhesive. The work should be completed as per specification, design & approval of the Architect.				
16	Running table top	RMT	9.45		
	Providing & Fixing of Running Table top 1' - 6" width using of 19mm thick BWP grade plywood finished with 1mm thick laminate, including all necessary items, labour charges, screws, Taxes. The work to be completed as per specification and approval of the architect.				
	TOTAL			Rs.	
	GST @ 18%			RS	
	GRAND TOTAL OF INTERIOR FURNISHING WORKS			RS	

PROPOSED ELECTRICAL WORKS FOR INDIAN BANK, REGIONAL OFFICE, MAPC & RAPC AT RAJAHMUNDRY, ANDHRA PRADESH.					
SCHEDULE OF QUANTITIES, SPECIFICATIONS AND ESTIMATE: ELECTRICAL WORKS					
S.NO	DESCRIPTION OF ITEM	UNITS	QTY	RATE	TOTAL AMOUNT(Rs)
	ELECTRICAL WORKS				
	Lighting work:				

	Supply and wiring with 3runs of 1.5 sqmm copper FRLS wire for earth continuity in 2mm/1.5sqmm thick PVC Conduit with all required accessories, Concealed surface or poc casing as required for light points with suitable Concealed box with modular plate, item including swithes and sockets, DB to swith box wiring to be included, with required termination with suitable sized pin type copper lugs complete.				
1	Primary light Points (With Switches):	PTS	137		
2	Secondary Light points	PTS	35		
3	Ceiling Fan Points				
	Supply and wiring for ceiling fan point with 3 runs 1.5 sq.mm FRLS PVC insulated copper conductor single core cable in surface / recessed steel conduit, with odular switch, modular plate, suitable GI box and earthing the point with 1.5 sq.mm FRLS PVC insulated copper conductor single core cable etc. as required, the item included 120w step type regulator, anchor fastner, provinding of fan hook.	PTS	1		
4	Wall Mounted Fan Points				
	Supply and wiring similar to item similar to the above but for wall Mounting fan point including box and 5 Amp. Control switch, Providing Clamp.	PTS	30		
5	Exhaust fan points:				
	Supply and wiring for exhaust fan point with 3runs of 1.5 sq.mm FRLS PVC insulated copper conductor single core cable in surface / recessed medium class PVC conduit, with piano type switch, phenolic laminated sheet, suitable size M.S. box and earthing the point with 1.5 sq.mm.FRLS PVC insulated copper conductor single core cable etc. as required.	PTS	5		
6	Call bell wire less				
	Supply and fixing of call bell wire less with remote controller, complete for the finished item of work.	NOS	4		
	AC MAIN DB				
7	Supply and Fixing of 8 way Vertical TPN DB with (1) 125A, 4P, MCB-1 no (input from PDB), (2) 63A,4P, 100mA, RCCB-1 no (Input), (3) 32A, 3P, MCB-10 NOS (cassette Acs), (4) 6-32A SP MCB-6 Nos (split Ac), (5) 63A, 4P, MCB- 1No to AC Sub DB, (6) 63 Amps TP MCB - 1 No Spare	NOS	1		
8	Copper Armoured cable 4 Core 4 Sq mm from AC Main DB to Sub DB, Light DB & UPS DB's	RMT	25		
	AC sockets				

9	Supply and fixing of 32A TP MCB with 40A 30ma RCCB on a suitable weather proof metal box concealed in wall with supply and laying of 4 Core 4.0 Sq mm Copper armoured cable as required for 4.15 TR	NOS	5		
10	Supply and fixing of 32A TP MCB with 40A 30ma RCCB on a suitable weather proof metal box concealed in wall with supply and laying of 4 Core 4.0 Sq mm Copper armoured cable as required for 3.31 TR	NOS	2		
11	Supply and fixing of 32A TP MCB with 40A 30ma RCCB on a suitable weather proof metal box concealed in wall with supply and laying of 4 Core 4.0 Sq mm Copper armoured cable as required for 2.0 TR	NOS	3		
12	Supply and fixing of 16A SPMCB on a suitable weather proof metal box concealed in wall with supply and laying of 3 Core 4.0 Sq mm Copper armoured cable as required for 1.5 TR	NOS	6		
	Raw Power Sockets				
13	Supplying and fixing metal box of 180mm X 100mm X 60mm deep (nominal size) on concealed with suitable size of phenolic laminated sheet cover in front including providing and fixing 6 pin ,15/16 A socket outlet and 15/16 A piano type switch, connections, painting etc. as required, supply and wiring with 2 runs of 2.5 Sq.mm with 1 runs of 1.5 Sq.mm copper wire FRLS for earth continuity in 2mmsqmm thick PVC conduit with all required accessories, complete for the finished item of work.	NOS	12		
	Raw Power at the Work station				
14	Supply and fixing of 1 nos. of flush type 6A, 5 pin combined switch socket outlets in the modular type plastic box including 1 no of 6A switches in a separate box above table and front plates including interconnections,item including 3 core x 1.5sqmm copper wire FRLS with suitable size heavy guage PVC Conduit concealed in wall/flooring (including cutting and filling)	NOS	50		
	or suitable width casing and capping of approved quality along with required accessories and interconnections.				
15	CHANGE OVER SWITCH				
	Supply and Fixing of fabricated 125A, 4 pole on load Change over switch with provision for the service cable termination asrequired. (1) Input-1: From PDB (2) Input-2: From DG set (3) Output:7 segment display (LDB) and MTS 2nd Input.	NO	1		
	UPS DB				

	UPS Incoming				
16	63 Amps FP MCB with SS Enclosure as UPS Incoming DB	NOS	5		
	UPS out going DB				
17	Supply, installation, testing of 12way SPN MCB distribution Board Concealed/ surface double door type with incoming 63 Amps Four pole MCB and out going 10 Amps SP MCB - 10 No's	NO	2		
18	Supply, installation, testing of 8way SPN MCB distribution Board Concealed/ surface double door type with incoming 32 Amps DP MCB and out going 10 Amps SP MCB - 6 No's	NO	3		
	UPS MODULAR SOCKETS:				
19	Supply and fixing of 3 nos. of flush type 6A, 5 pin combined switch socket outlets in the modular type plastic box including 1 no of 16A switches in a separate box above table and front plates including interconnections, item including 3 core x 2.5sqmm multistrand copper conductor FRLS wires with suitable size heavy guage PVC Conduit concealed in wall/flooring (including cutting and filling) or suitable width casing and capping of approved quality alongwith required accessories and interconnections.	NOS	62		
	LT Cables				
20	Incoming Cable from CT Meter : Supply and installation of Aluminium Armoured, 70sqmm x 3½core surface cable 1100V grade IS 1554 either in ground, treach, Surface with all required accessories including labour complete for the finished item of work.	RMT	48		
21	Supply and End termination of 3½ x 70 Sqmm Aluminium Armored Cables with required Gland, Copper Lugs and all materials etc., complete.	NOS	2		
22	Incoming Cable from Main Panel to AC DB: Supply and installation of Aluminium Armoured , 50sqmm x 3½core surface cable 1100V grade IS 1554 either in ground, treach, Surface with all required accessories including labour complete.	RMT	25		
23	Supply and End termination of 3½ x 50 Sqmm Aluminium Armored Cables with required Gland, Copper Lugs and all materials etc., complete.	NOS	2		
	Power Distribution Board				

24	Supply and fixing 415V TPN wall mounting type Power Distribution Board with necessary wall mounting frame work including grouting on the wall. The distribution Board shall be made of 16 G CRCA sheet steel and Al reinforcement wherever necessary for mechanical support, with oven baked painting of approved colour and shade after pre-treating of steel for derusting and degreasing. The distribution board with live terminals duly shrouded, properly segregated and compartmentalized and shall be accessible for operation/maintenance only after opening of hinged door which shall have locking arrangements and padlocks. all switches and all MCCB/MCB/RCBO knobs shall be visual,all components should be in seperate compartments. The distribution board should have Danger Board engraved on 2.0 mm thick PVC plates.The distribution board should have the following components: (Refer Electrical SLD for any clarifications)	NO	1		
	Incomer				
	160A/ 4 pole, 415V, MCCB-35 KA - 1No , (L&T/ ABB/ HPL OR EQUIVALANTS make) with adequate space for termination 70 sq. mm 3 1/2 core PVC armoured UG cable:				
	200 Amps Bus Bar with Triple pole and Neutral , CT 200/5 coils, suitable sizeAL bus bars with coded PVC sleeves/tape regidly supported on fiber glass reinforced insulating 10mm sheet fiber glass insulator, Multi function meter , volt meter, amp meter, selector swith.				
	One number 25 X 3 mm size aluminium earth bus bar with tap holes, bolts/ nuts provided with nuts for external earth connections;				
	125 A Four Pole change over Switch - 01 no				
	Out Goings: 125 A TP MCCB 25 KA-1 no for AC DB				
	63 Amps four pole MCCB-1no for UPS DB & 40 Amps FP MCB - 1 No for lighting DB 1, 40 Amps FP MCB - 1 No for lighting DB 2, 63 Amps MCCB for APFC Panel- 1 NO, 63 Amps TP MCCB - 1 No Spare, 32 Amps TP MCB - 1No as spare				
	Three sets of RYB supply indicator lamps each set consisting of one No. 230V filment type indicator lamp holder of TEKNIC type indicator, one NO. TEKNIC make push button for operation of RYB lamps.				

25	APFC Panel - 25 Kvar, with 5 Kvar as Fixed capacitor bank with 16 amps TP MCB as back up and 5 kvar with 16 Amps TP MCB as back up and 7.5 Kvar capacitor duty contactors - 2 No's with APFC relay 4 steps	NO	1		
26	Lighting DB's: Supply, installation of 6way 7 segment DB's for DX ³ MCB, Isolator, RCCB and RCBO: With provision for FP MCB/Isolator/RCCB/RCBO as incomer and SP MCB's as (1) 40 A 4 Pole MCB- 1no (Input From PDB), (2) 40A 2P 30mA RCCB-3nos (3) 6-10A SP MCB-14nos for raw power sockets and light point circuits (4) 16A SP MCB-2 nos of water cooler, Pantry power point	NOS	1		
27	Lighting DB's: Supply, installation of 4way 7 segment DB's for DX ³ MCB, Isolator, RCCB and RCBO: With provision for FP MCB/Isolator/RCCB/RCBO as incomer and SP MCB's as (1) 40 A 4 Pole MCB- 1no (Input From PDB), (2) 40A 2P 30mA RCCB-2nos (3) 6-10A SP MCB-10nos for raw power sockets and light point circuits.	NOS	2		
	LIGHT FITTINGS:				
	SFTC of the following light fittings with lamps. The fixtures shall be installed with supply of all materials such as wooden round block, balancing socket, conduit pipe, nipples, cheaknuts, bolts, nuts, PVC flexible hose, suspension rod/chain clamps/Connection wire from Ceiling Rose to fittings, Hard ware etc,				
28	Supply and Fixing of Havells Make LED Venus Neo 2x2 34W Panel Light (LHEWBPP7PK1W034) or equivalent with all required accessories, including the cost and conveyance, required labour charges, material and necessary tools and accessories to execute the work complete for finished item of work.	NOS	53		
29	Supply and Fixing of Havells 24W LED Down Light (INTEGRANEODLR24WLED857S) or equivalent with all required accessories, including the cost and conveyance, required labour charges, material and necessary tools and accessories to execute the work complete for finished item of work.	NOS	14		
30	Supply and Fixing of Havells 15W LED Down Light (LHEWEKP7PL1W015) or equivalent with all required accessories, including the cost and conveyance and all necessary taxes, GST Tax etc., for required labour, material and necessary tools and accessories to execute the work complete for finished item of work.	NOS	62		

31	Supply & Fixing of Havells Make 18W four feet LED Light (LHEXBQP7IN1W018) or equivalent with all required accessories, including the cost and conveyance and all necessary taxes, GST Tax etc., for required labour, material and necessary tools and accessories to execute the work complete for finished item of work..	NOS	8		
32	Supply and fixing of 48" double ball bearing Ceiling fan for High Speed	NOS	1		
33	Supply and fixing of 400mm dia. wall mounted fans (Make/Model: Orient Electric Wall-45 400mm Wall Fan	NOS	30		
34	Supply & fixing of 200 mm exhaust fan 'Ventilair DX W' with self closing louvers and plastic body, out side bird mesh with all accessories etc, item including transport charges, labour charges, taxes, complete for finished item of work.	NOS	5		
Earthing					
35	Providing Earth stations with 2.5mt depth soil excavation with 600mm x 600mm x 3mm Copper earth plate along with 40mm dia.GI perforated earth pipe along with tunnel. The earth pit to the filled up with charcoal and salt, alternative layers upto brim the and covered with excavated soil, The earth pit should be concreted and provided with CI slab as per IS 3043 of 1987 as main earth pit.	NO	2		
36	Providing G.I earth station, with 40mm dia, 2500mm long galvanised iron pipe including construction of brick pedestal, providing meshed funnel CI cover and other Civil Engineering Works, spreading a homogeneous mixture of salt charcoal around the pipe etc, for Earthing.	NO	1		
37	Supplying and laying 25 mm X 3 mm G.I strip at 0.50 metre below ground as strip earth electrode, including connection/ terminating with G.I. nut, bolt, spring, washer etc. as required. (Jointing shall be done by overlapping and with 2 sets of G.I. nut bolt & spring washer spaced at 50mm) . For Main Panel earthing	MTR	85		
38	Supplying and laying 6 SWG G.I. wire at 0.50 metre below ground level for conductor earth electrode, including connection/ termination with GI thimble etc. as required. For DB Earthing	MTR	42		
TELEPHONE AND LAN WIRING:					
LAN:					

	Supply and laying of heavy duty PVC conduits concealed in wall/floor and with suitable width casing and capping of approved quality along with required accessories and drawing of 12SWG GI Wire as fish wire for laying of Telephone cables at a later stage and supply of all fixing materials complete as required				
39	Providing and fixing of Lan points Double Line Laying of 4Pair, UTP cat 6 Systemax Lan Cable with 2nos cat 6 RJ-45 Information outlets and Suitable 2mm Thick PVC Pipe Laying Below Flooring/Wall/Slab etc MS Junction Boxes to All Tables , Including all Related Civil Works etc All Cable Numbers to be Provided at both ends	NOS	50		
40	Supply of Dlink 7 feet length moulded Patch Cord.	NOS	100		
41	Supply of Dlink 3 feet length moulded Patch Cord.	NOS	100		
42	Supply and Fixing of CAT-6, 24 Port Jack Panel.	NOS	5		
43	Supply and fixing of 9U Rack with all accessories (Self, Cable Manager, Power Manager)	NOS	5		
44	Supply and fixing of d-Link 10/100A mbps port switch	NOS	5		
	Telephone:				
44	Supply and fixing of RJ 11 Telephone point socket with 2 Pair Telephone Cable From Each Table to EPABX , this include suitable Surface/concealed box and required all materials this Includes Supply and fixing of Suitable PVC Conduits and Cable Numbers to provided, item including Wiring of Telephone Points Wiring with 5 Pair Copper cable and suitable conduits,required all materials etc.	SET	50		
45	Supply and fixing of 20 Pair Termination EPBX Box with Connectors	SET	3		
46	Main Lines Upto EPBX Line 10 Pair 0.5mm Copper Cable With Conduits etc	MTS	225		
	TOTAL OF ELECTRICAL WORKS			Rs.	
	GST @ 18%			RS	
	GRAND TOTAL (ELECTRICAL WORKS)			RS	

PROPOSED AIR - CONDITIONING WORKS FOR INDIAN BANK, REGIONAL OFFICE, MAPC & RAPC AT RAJAHMUNDRY, ANDHRA PRADESH.

SCHEDULE OF QUANTITIES, SPECIFICATIONS AND ESTIMATE: AIR - CONDITIONING WORKS					
S.NO	DESCRIPTION	UNITS	QTY	RATE	TOTAL AMOUNT (Rs)
	<u>Air - Conditioning Works:</u>				
A	<u>PART-I</u>				
I	Split Air - Conditioners				
1	SERVER ROOM				
	Supply of Spilt Air Conditioner of 1.0 TR - Wall Mounted Inverter AC, 3-STAR, R-32 Eco-Friendly Gas, compressor type: rotary, condenser coil: copper, as per technical specifications, including, cost, conveyance, all government heavy duties and all taxes, GST tax for the material and labour at site and necessary tools, fasteners, out door unit stand, fittings, screws, brackets, bolts, Brick wall cutting with neat plastering, complete for finished item work.	NOS	2		
II	Daikin Latest X Series VRV SYSTEM				
	Supply of (Cooling Only) Variable Refrigerent Volume Outdoor units with inverter technology scroll compressor, low noise propellor type aero spiral fan, Condenser coil with special acrylic pretreatment for improved resistance to salt corrosion, refrigerant shut off valves,safety devices, lead free PC boards suitable for operation on R410a and on 380 - 415 V, 50 Hz, 3 phase A/C supply etc. as per standards (Cooling Only Top Discharge)				
1	20 HP VRV X SYSTEM	NOS	2		
	Cassette Units				
2	Supply, fixing and installing and commissioning 4.15 Ton Cassette Air Conditioner approved make (4.15 TR Round Flow Cassette AC, including the drain pipe, required electrical wiring for IN door, INDoor mounting, cost, conveyance, all government heavy duties and all taxes, GST tax for the material and labour at site and necessary tools, fasteners, fittings, screws, brackets, bolts, Brick wall cutting with neat plastering, complete for finished item work. (Unit Size: H-298mm x W-840mm x D-840mm)	NOS	5		
3	Supply, fixing and installing and commissioning 3.31 Ton Cassette Air Conditioner approved make (3.31 TR Round Flow Cassette AC, including the drain pipe, required electrical wiring for IN door, IN Door mounting arrangement, cost, conveyance, all government heavy duties and all taxes, GST tax for the material and labour at site and necessary tools, fasteners, fittings, screws, brackets, bolts, Brick wall cutting with neat plastering, complete for finished item work. (Unit Size: H-298mm x W-840mm x D-840mm)	NOS	2		

4	Supply, fixing and installing and commissioning 1.32 Ton Cassette Air Conditioner (1.32 TR Round Flow Cassette AC, including the drain pipe, required electrical wiring for IN door, INDoor mounting, cost, conveyance, all government heavy duties and all taxes, GST tax for the material and labour at site and necessary tools, fasteners, fittings, screws, brackets, bolts, Brick wall cutting with neat plastering, complete for finished item work. (Unit Size: H-256mm x W-840mm x D-840mm)	NOS	3		
	Split Units				
5	Supply, fixing and installing and commissioning 2.1 Ton Split Air Conditioner (2.1 TR High Wall Split AC, including the drain pipe, required electrical wiring for in door, indoor mounting, cost, conveyance, all government heavy duties and all taxes, GST tax for the material and labour at site and necessary tools, fasteners, fittings, screws, brackets, bolts, Brick wall cutting with neat plastering, complete for finished item work. (Unit Size: H-298mm x W-885mm x D-229mm)	NO	1		
6	Supply, fixing and installing and commissioning 1.6 Ton Split Air Conditioner (1.6 TR High Wall Split AC, including the drain pipe, required electrical wiring for in door, indoor mounting, cost, conveyance, all government heavy duties and all taxes, GST tax for the material and labour at site and necessary tools, fasteners, fittings, screws, brackets, bolts, Brick wall cutting with neat plastering, complete for finished item work. (Unit Size: H-298mm x W-885mm x D-229mm)	NO	1		
7	Supply, fixing and installing and commissioning 1.0 Ton Split Air Conditioner (1.0 TR High Wall Split AC, including the drain pipe, required electrical wiring for in door, indoor mounting, cost, conveyance, all government heavy duties and all taxes, GST tax for the material and labour at site and necessary tools, fasteners, fittings, screws, brackets, bolts, Brick wall cutting with neat plastering, complete for finished item work. (Unit Size: H-298mm x W-885mm x D-229mm)	NOS	4		
	TOTAL			Rs.	
	GST 28%			Rs.	
	TOTAL OF A			Rs.	
B	PART - II				
	Split AC low side work:				
1	Supply & Installation of Soft Copper Pipe with 9 mm Insulation tube for Inverter Split AC				
a	6.4 mm Dia	Rmt	5		
b	12.7 mm Dia	Rmt	26		
2	Indoor to Outdoor Condenser Cable				
	1.5 Sq mm x 4 Core multistrand copper Cable with pvc conduit	RMT	32		

3	Split AC Lifting, Shifting, Positioning, Installation & Commissioning	NOS	2		
	VRV System. Low Side Work				
4	Installation, Lifting, positioning, Testing and Commissioning of VRV Outdoor unit	NOS	2		
5	Supply & Installation of copper refrigerant piping duly insulated with Nitrile rubber insulation of 19mm thickness for Gas Pipe and 13mm thickness for Liquid Pipe / Including supports Clamps etc and incl bends, couplings and necessary fittings,				
a	6.4 mm dia	RMT	30		
b	9.5 mm dia	RMT	52		
c	12.7 mm dia	RMT	55		
d	15.9 mm dia	RMT	125		
e	19.1 mm dia	RMT	8		
f	22.2 mm dia	RMT	10		
g	28.6 mm dia	RMT	14		
h	34.9 mm dia	RMT	12		
6	Installation, Lifting, positioning, Testing and Commissioning of VRV Indoor units				
a	4.15 Ton Cassette Air Conditioner	NOS	5		
b	3.31 Ton Cassette Air Conditioner	NOS	2		
c	1.32 Ton Cassette Air Conditioner	NOS	3		
d	2.1 Ton Split Air Conditioner	NOS	1		
e	1.6 Ton Split Air Conditioner	NOS	1		
f	1.0 Ton Split Air Conditioner	NOS	4		
7	Supply & Installation of control cum Transmission wiring between ODU & IDU of copper 2 core 1.5 sqmm copper cabling in required PVC conduits	RMT	480		
8	Pressure , Vacuum testing of entire refrigerant piping and commissioning of VRV system including topping of Refrigerant 410a and proper air balancing as per site conditions	LOT	2		
9	Gas top up	KG	40		
10	External pipe line tray	RMT	20		
10	Supply and Fixing of Hard PVC drain piping with suitable supports as required & insulated with 6mm thick Nitrile rubber insulation				
a	25 mm dia	Rmt	40		
b	32 mm dia	Rmt	320		
11	Installation , Testing and Commissioning of suitable Refnet joints / Distribution joint kits to take care of connectivity and circuiting as per detailed in drawings	Nos	11		
	TOTAL				Rs.
	GST 18%				Rs.
	TOTAL OF B				Rs.
	TOTAL (A+B)				Rs.

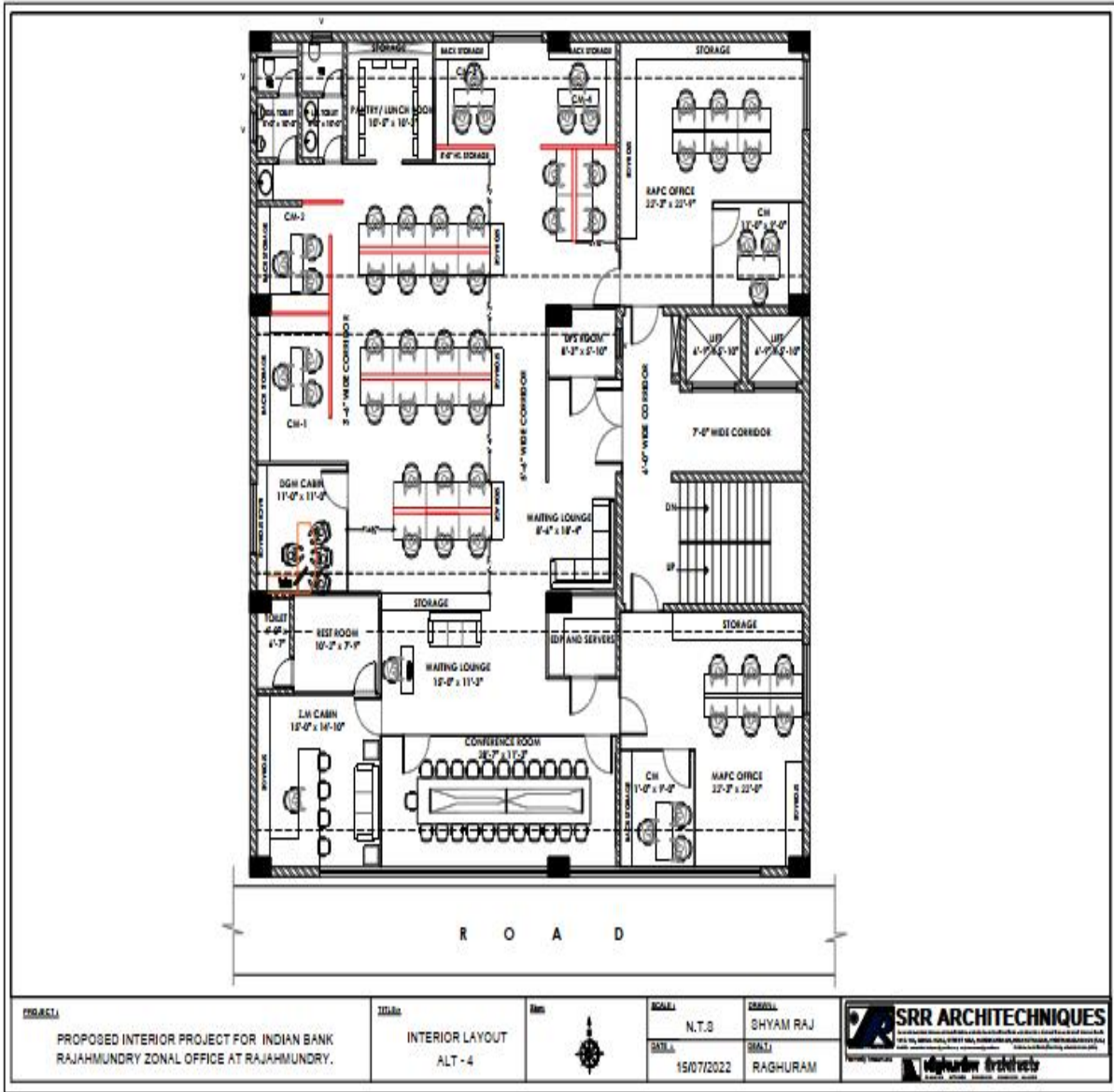

PROJECT:
 PROPOSED INTERIOR PROJECT FOR INDIAN BANK
 RAJAHMUNDRY ZONAL OFFICE AT RAJAHMUNDRY.

TITLE:
 INTERIOR LAYOUT
 ALT - 4



SCALE:
 N.T.S.
DATE:
 15/07/2022

DESIGNER:
 SHYAM RAJ
DRWING:
 RAGHURAM

SRR ARCHITECTNIQUES
 ARCHITECTURE INTERIOR DESIGN
 SRR ARCHITECTNIQUES
 15/07/2022

