

**PROPOSED INTERIOR RENOVATION OF FIRST FLOOR, B-WING, 101, NEO VIKRAM CHSL, SAHAKAR NAGAR,
NEW LINK ROAD, ANDHERI WEST, MUMBAI 400 058.**

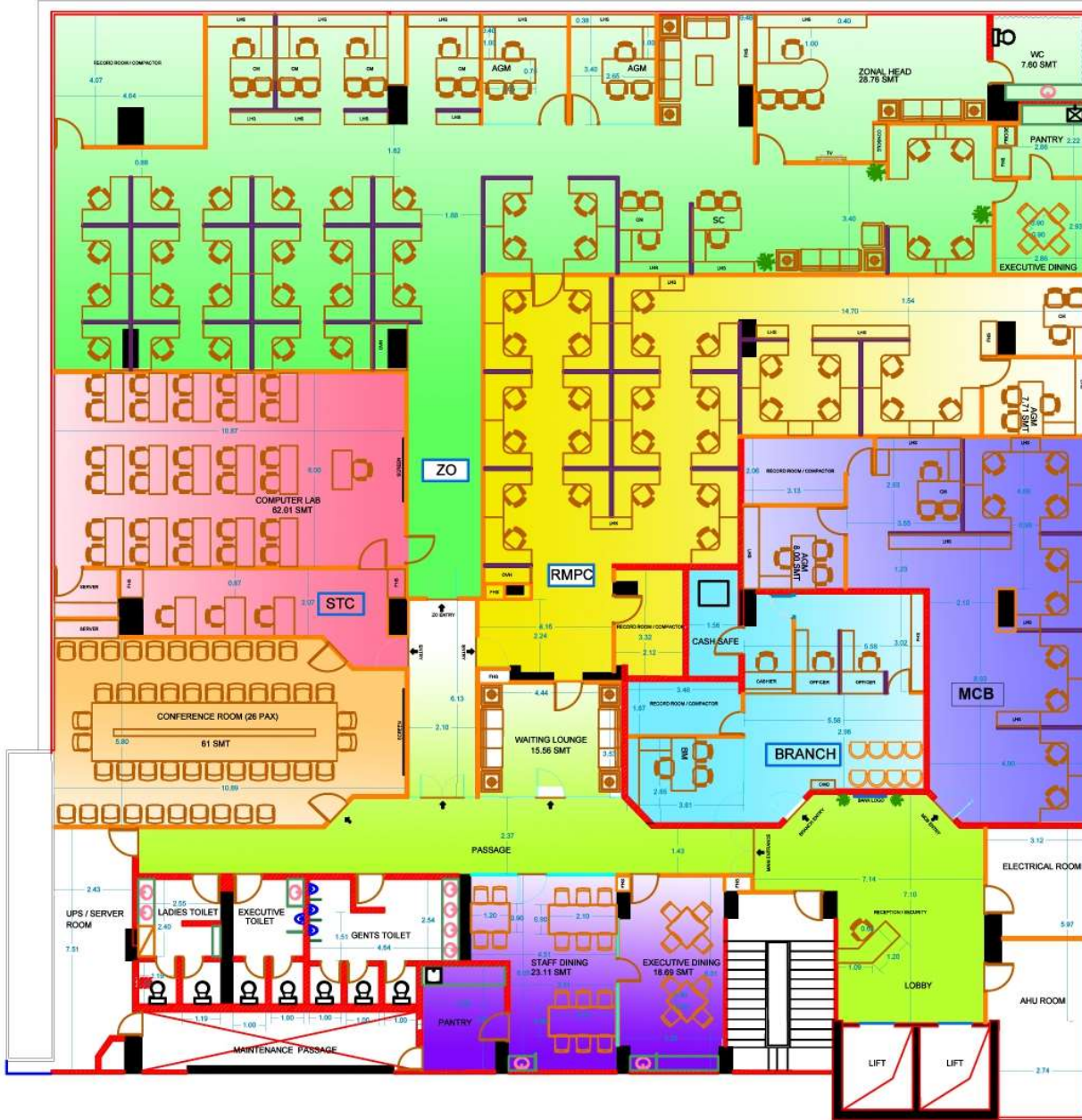

LEGEND	
	WALL
	SOLID PARTITION
	TOUGHENED GLASS PARTITION
	PARTLY GLAZED PARTITION
	LOW HT. PARTITION
	FIRE EXIT DOOR INDICATION

REQUIREMENTS (REVISED)								
SR NO.	DEPARTMENT	Z.O.	RMPC	MCB	STC	BRANCH	COMMON	TOTAL
1.	CARPET AREA (APPROX SMT)	259.75	178.14	102.68	75.16	80.69	292.94	990.66
1.	ZONAL HEAD	1				1		
2.	CASHIER							
3.	AGM	2	1	1				
4.	CM	4	1	1				
5.	OFFICER	31	28	10		2		
6.	CLERK/SECY/ FACILITY	1			3			
7.	SUB STAFF							
8.	BRANCH MANA.					1		
9.	COMPUTER LAB				26			
10.	SITTING CAPA. CONF. ROOM						22	
11.	MEETING 10PX							
12.	WASHROOM	1					G/L/EX	
13.	SECRETARY ELEC/JVAC	1						1
14.	DINING- EXEC. COMMON & PANTRY							EX/COM
15.	WAITING			1				A

NOTE: EXCLUDING LIFT LOBBY & STAIRCASE BLOCK



SANDEEP GOVALKAR DESIGN ASSOCIATES
Architects Interiors Landscape, Designers & Project Consultants
A3, 301/302, SHIVCHHAYA, GILBERT HILL ROAD,
ANDHERI-WEST, MUMBAI-58.
Email: govalkarsgda@gmail.com, Cell: +91-9969699169