

**TENDER FOR PROPOSED INTERIOR WORK OF  
MULUND (WEST) BRANCH.**

FOR

**INDIAN BANK**

**AT GROUND FLOOR, HARI OM PLAZA, RHB ROAD,  
NEAR RAILWAY LINE, MULUND WEST, MUMBAI.**

DATE OF ISSUE: - 14/ 12 / 2021.

TENDER SUBMISSION ON: - 28 / 12 /2021 AT 3.00 P.M.

TENDER OPENING: - 28 / 12 /2021 AT 3.30 P.M.

JOB PERIOD 30 Days

ARCHITECT

**KALA AREKHAN**  
ARCHITECT & DESIGNERS

101, VINDHYACHAL SOCIETY, PLOT NO. 204,  
SECTOR -4 CHARKOP, KANDIVALI (W),  
MUMBAI - 400067, TEL: 022 – 28682567.

## **NOTICE INVITING TENDERS**

1. Sealed tenders are hereby invited from empanelled contractor only for **INDIAN BANK MULUND WEST BRANCH**, for the **INTERIOR WORK** to be carried out, for their new branch premises at Ground Floor, Hari Om Plaza, RHB Road, Near Railway Line, Mulund West, Mumbai.
2. The work is to be completed within 30 Days from the date of issue of the work order.
3. The tender document should be downloaded from Bank's website under Tender section from 14/ 12 / 2021 onwards, and the last date for receipt of tender is 28 / 12 / 2021 up to 3.00 pm. And the tenders will be opened same day at 3.30 pm. or will be informed as decided.
4. The tender document including the set of drawings must be returned to the Bank's Office on or before the Last date of submission even if the contractor does not wish to quote for the project.
5. a) At the time of submitting his tender, the tenderer shall deposit with the Bank earnest money of Rs. 12000/- (Rupees Twelve thousand only ) by way of DEMAND DRAFT in favor of **INDIAN BANK** of Any Nationalized Bank.  
  
b) This Earnest Money Deposit will not bear any interest. The earnest money deposit will be forfeited in the event of any evasion, refusal or delay on the part of the Tender to sign and execute the contract on the acceptance of his tender. The Earnest Money Deposit, without any interest, will be returned to the tenderer if their tender is not accepted.  
  
c) The tenderer whose tender is accepted will be required to deposit further amount to make total of 0.5% contract value including EMD or may be deducted from 1<sup>st</sup> Running Bill in addition to the amount already deposited towards earnest money deposit, thus making total Security Deposit to 5% of the total contract value will form part of the performance guarantee, which shall not bear any interest. This amount will be refunded only after virtual completion of the work.
6. The tenders shall be submitted as per instructions with the name of work supervised on the envelopes written prominently and addressed to The Deputy Zonal Manager, INDIAN BANK – Zonal Office Mumbai South, 2<sup>nd</sup> floor, 37, Mumbai Samachar Marg, Fort, Mumbai-400 023.  
  
The full name and postal Address of the Tenderer shall be written on the bottom left hand corner of the sealed cover. The sealed tenders shall be submitted to Deputy Zonal Manager at the address mentioned above.
7. Acceptance of tender will rest the employer who receive the right to accept or reject any or all the tenders in part or full without assigning any reason therefore. Any tender who does not fulfill any two prescribed conditions would be liable for rejection.

8. All the rates mentioned in the tender are inclusive of all taxes i.e. Income tax any tax, Octroi, Local Municipal Overheads/ levies/ transport etc. charges. No separate amount for these will be considered except GST. Tenderers should note that the GST will be paid separately as applicable.
  
9. This Tender Notice forms part of the contract.

PLACE:

DATE:

DEPUTY ZONAL MANAGER  
INDIAN BANK, MUMBAI SOUTH ZONE  
2<sup>ND</sup> FLOOR, 37 MUMBAI SAMACHAR  
FORT MUMBAI 400023

## **FORM OF TENDER**

To,  
The Deputy Zonal Manager,  
INDIAN BANK,  
Zonal Office Mumbai South,  
2<sup>nd</sup> floor, 37,  
Mumbai Samachar Marg,  
Fort, Mumbai-400 023.

Dear Sir,

With reference to the tender invited by you on behalf of **INDIAN BANK FOR INTERIOR WORK** to be carried out for their new branch Ground Floor, Hari Om Plaza, RHB Road, Near Railway Line, Mulund West, Mumbai.

I/ We have undersigned hereby tender and undertake to execute the work under the contract at the rates quoted by me /us in the schedule of quantities and rates and on the condition of contract with this tender.

I/We have carefully studied and understood the drawings, conditions of contract, specifications, schedule of works and have acquainted myself/ ourselves with the site conditions.

I/We agree to complete the works within 30 Days after receiving the work order in conformity with the said conditions of contract, specifications, Schedule of quantities and rates and drawings. I/ We enclosed herewith earnest money deposit Rs.12,000/- In Words (Rupees twelve thousand only) in the manner as prescribed. The said sum shall not bear any interest and Bank Only deduct 5% of contract value less EMD from the 1<sup>st</sup> R.A. Bill to make a total of 5% of the tender amount as Security Deposit for the faithful performance of the contract, or to commence the work being called upon to do so. The amount of total 05% ( Five Percent) of the total bill of work done shall remain with bank till defects liability period is over and the said amount shall bear no interest.

It is understood by me/us that the lowest or any tender will not necessarily be accepted.

Yours faithfully,

Signature of contractor

Stamp/ Seal.

Date:

Place:

Address:

## SECTION - I

### **CONDITIONS OF CONTRACT**

1. Tenderers shall sign wherever provided for. Tenders not so signed shall be rejected. The tenders shall be submitted in sealed cover in the office of **The Deputy Zonal Manager**, INDIAN BANK, Zonal Office Mumbai South, 2<sup>nd</sup> floor, 37, Mumbai Samachar Marg, Fort, Mumbai 400023. Tender will be Issue on 18/12/2021 and need to Submit on before 28 / 12/ 2021 at 3.00 pm.
2. No Tenders shall be accepted unless the full amount of Earnest Money Deposit is paid by DD/ Pay Order of appropriate amount mentioned at the time of submitting the tender.
3. Fluctuations in the prices of any materials or equipment or labour etc; shall not be taken into account either for compensation for damages or for extras. The validity of the tender shall be 90 days for acceptance.
4. Watch and ward in respect of all plants, machinery and materials at site for use in work shall be the contractor's sole responsibility.
5. The contractor shall have to make his own arrangements to house his labour and staff, and for their services.
6. All instructions regarding the execution of the work shall be received from the architect/ Bank engineers only. Any other instruction issued directly to the contractor by anyone else shall not be binding on the employer.
7. During execution of works the contractor must check his work with the drawings. The contractor shall be responsible for all the errors in this connection and will have to rectify all defects at his own cost, failing which the employer reserves all the rights to get the same rectified at the risk and the cost of the contractor.
8. The contractor entrusted with the work shall indemnify the Bank and the Architects against theft, mishaps in construction and injury to workmen, damage to persons, property etc. He shall make good the damage at his own expenses.
9. The Bank, through the Architects, shall; have the power to omit or cancel; any item of work without assigning any reason whatsoever and no claim for compensation for damage will be entertained for such omissions and cancellations.
10. Time is the essence of the work. All the works shall have to be completed within 30Days from the date of work order (Appendix –A). If the work is not completed within the aforesaid period, the contractor shall pay the bank or the bank shall be entitled to deduct from the payment due to the said contractor the sum of ½% of contract value per week of delay or part thereof, subject to a maximum limit of 05% of the contract amount.

11. The contractor shall maintain satisfactory progress of work as well as maintain a desired of workmanship. If in the opinion of the Architects the progress is unsatisfactory and /or the workmanship is unsatisfactory, the Architects shall advise the employer to take possession of work with Seven days notice to that effect. The employer shall then complete the entire work and rectify all the defects at the contractors cost and consequences.
12. In case the Bank /Architects are not satisfied with the quality of materials used by the contractors they reserve the right to direct the contractor to procure such supplies from agencies they deem fit.
13. It is agreed that if the works are delayed (1) by force-major or (2) by reasons of any damage by exceptionally inclement weather or (3) by reasons of loss or any damage by extensive fire not caused by an act or a default on the part of the contractor, by earthquake or civil commotion, strikes or lockouts affecting any of reasonable extension of completion of works. Upon the happening of in such event, causing delay, the contractor shall immediately give notice thereof in writing to the employer and the employer in all such eventualities agrees, without accepting any contractual obligations in this behalf, to assist the contractor to the utmost extent possible to meet the situation. If no such notice as mentioned above is given within 7 days of happening of such event, no claim for damage or compensation will be entertained on all parties.
14. The contractor shall submit the bills for payment along with detail statement showing the actual works carried out under different heads of items. Minimum value of works interim payment shall be Rs.4, 00,000/-. The bills same shall be to the extent of 75% of the value.
15. The contractor shall clear the site of works as per the instructions of the bank /architects. The site of works shall be cleared of all men, materials etc. belonging to the contractor. The site shall be delivered in a broom clean and neat condition employer shall have the right to day the site cleared at the risk and cost of the contractor.
16. The contractor shall not without the written consent of the bank /Architects assign the agreement or sublet any portion of works.
17. The quoted rates shall be all inclusive and cover the cost of all materials, freight, all types of taxes, duties, royalties, erection, construction, testing of materials, samples brought for approval, overheads, profit &any other expenditure incurred for work as per drawings &specifications.
18. Wherever required the bank /Architect shall instruct erecting items sample, or makeup , as the case may be, and upon approval of the same , the items shall be fabricated and completed by the contractor (with or without modifications as the bank / Architect shall instruct).
19. The final bill from the contractor shall not be entertained under any work found any circumstances without completion of all the items of works .any work found defective or wrongly carried out, and instructed by the bank /Architect to be rectified or replaced shall be rectified or replaced prior to submission of the final bill. It is to be expressly noted that no final bill will be held valid in the event of non - rectification of the defective or wrongly carried out items and completion date shall not this account be extended. Defects liability period will be effective from the day of satisfactory completion of all the items of work, as may be certified by the Architect.
20. In the event of the work being executed day & night on holidays, which might be required for the completion of the work within the stipulated time however utmost care to be taken for not to disturb to normal working of Branch.

21. While executing the work, considerable amount of shifting and re-shifting of several furniture like Tables, Chairs, Steel Cupboards, Filing Cabinets, Side Units, Safes etc. Grills, Door frames, Windows, Partitions & Glass etc. items are Likely to be involved. It is also likely that some of the items might be required to be temporarily shifted elsewhere in the premises on any other floors. These shall be done by the contractor, and no payment against these works shall be separately paid for by the Bank. As the work is to be carried out and completed in the working Bank Branch, the contractor shall be responsible for maintaining the premises in clean condition every morning.
22. The contractor shall acquaint himself with the site conditions, local traffic regulations, local authority regulations availability of materials, labor, tax, structure etc. and quote rate accordingly. No extra charges / increase in rates shall be allowed on any of these or any other accounts.
23. The contractor shall have a complete supervisor on the site at all the times.
24. The contractor and / or his authorized representative will attend all the meetings whenever called for and the decisions taken in the meeting will be binding on the contractor.
25. In case any Municipal Corporation / Local authorities approval is necessary then it shall be the contractors responsibility to get it approved and all expenses incurred there of shall be borne by them without involving or putting financial liability on the Bank..
26. In case the local authorities such as Mumbai Municipal Corporation, CFO& BEST/ADANI raise objections in matters water /electricity consumption, debris disposal etc; the contractors shall solve the matter at their end, without involving or putting financial liability on the Bank.
27. Water shall be available after the requirements of Branch, at the suitable point at the work site. All additional piping connections, from this point, water meters etc., shall be install by the contractor at his own cost. If required contractor has to arranged for tanker water.
28. The contractor shall be given a single electrical connection at the work site. Electrical charges for consumption by the contractors will be charged separately by the Bank. Contractor has to provide sub – meter.
29. The contractor shall be bound to carry out any extra items of works, whenever possible the rate for extra item shall be derived from the rate already quoted, otherwise the rate shall be worked out at cost of material + labour + 10% (overheads, wastage, taxes and transportation) + 15% profit
30. The rates shall be entered in figures as well as words.
31. The payment shall be in the following manner:-
  - a. 5% advance based on the contract amount against a Bank Guarantee for similar amount valid for a period of 3 months and drawn on any Bank other than the INDIAN BANK or its Associates, and this advance shall carry interest at rates as per RBI guidelines in force. The advance shall be recovered from the 3 rd Running Bill in equal proportion to the balance cost of work
  - b. 75% of the material cost brought to the site subject to verification from purchase bills showing of materials which are to the running payment bills.
  - c. On account payment (Minimum Value Rs. 4, 00,000/-) with retention of 8%.

- d. 50% (of Retention Amount + Earnest Money/ Security Deposit) shall be released after virtual completion of work, balance 50% (5% of the total contract value) shall be retained for a period of 12 months of defects liability period.

The contractor shall submit his running bills for payment concerning work executed or materials delivered on the site, or work executed at his work shop which will be certified by the Architect for the payment within 10 days from the date of submission of the bill.

The architect will not certify to any application for the payment to any contractor if there are:

- A. Defective items of the work still uncorrected.
  - B. Any claims or liens filed against the contractor for failure to pay for material, labour or sub contract amount due or reasonable evidence that includes probable filing of such claims.
  - C. Damage to other contractor.
  - D. A reasonable doubt that the contractor can be completed for the balance then unpaid.
32. When the works are complete in all respects, the contractor shall intimate in writing to the architect and the bank to enable to take possession of the same. The work shall not be considered virtually complete until the Bank and the Architect have jointly inspected the works and certified in writing that this has been completed.
33. Layout with civil work shall be approved from EEBP (Building Proposal/ concerned ward with necessary No Objection Certificates from concerned Local Municipal Council departments, CFO or Govt. authorities or keeping on view the mutual understanding between contractor and concerned departments. If permission is not obtained on the time schedule and if the Municipal concerned department arrives on the site for Inspection and issue us the NOTICE either on phone or in writing, Bank shall not inform the contractor neither discuss the issue or reasons whatsoever with the contractor for not obtaining the permission, Bank shall pay the necessary penalty charged by the concerned authorities or appoint any outside agency immediately to solve the matter for obtaining necessary relevant permission for non stopping of work in whatsoever condition and shall pay their fees along with the premium, and the said amount shall be paid on behalf of the contractor by the Bank to the concerned party without prior notice to the contractor to solve the matter at the earliest and the amount shall be deducted either from his running bill or final bill whichever stage the problem arises.

I/We hereby declare I/We have read and understood the above terms and conditions and that we shall abide by them if the work is awarded to us.

DATE:

PLACE:

SIGNATURE OF THE TENDERER WITH STAMP/ SEAL.



## FORM OF AGREEMENT

Article of agreement made at this day of \_\_\_\_\_, 20 \_\_\_\_ between \_\_\_\_\_  
\_\_\_\_\_  
\_\_\_\_\_ ( herein after called “ The Owner”) of the one part and  
\_\_\_\_\_  
\_\_\_\_\_ of ( or whose registered office is situated  
at \_\_\_\_\_  
\_\_\_\_\_  
\_\_\_\_\_ (hereinafter called “the contractor”) of the other part.

WHEREAS the owner is desirous of \_\_\_\_\_  
\_\_\_\_\_  
\_\_\_\_\_ and has caused Drawing and schedule, Quantities and Rates showing and describing the work to be done to be prepared by or under the directions of **M./S. KALA AREKHAN**, 101, Vindhyachal Co-Op-Hsg. Society, Plot no. 204, sector -4, Charkop, Kandivali (west), Mumbai- 400 067.

AND WHEREAS the contractor has supplied the Owner with a fully priced copy of the said schedules of quantities and rates (which copy is herein after referred to as “the contract drawing”) and the contract bill have been signed by or on behalf of the parties hereto:

AND WHEREAS the contractor has deposited the sum of the Rupees \_\_\_\_\_  
\_\_\_\_\_ with the owner for due performance of this Agreement.

Now it is hereby agreed as follows:

1. For the consideration herein after mentioned the contractor will upon the subject to the condition annexed carry out and complete the work shown up[on the contract drawing and describe by or referred to in the contract bill and in the said conditions.
2. The owner will pay the contractor the sum of Rupees \_\_\_\_\_  
\_\_\_\_\_  
(herein after referred to as “the contract sum” or such other sum as shall become payable hereunder at the times and in the manner specified in the said conditions.)
3. The Term “The Architect in the said conditions shall mean the said “M/S.KALA AREKAHAN” or in the event of his death or ceasing to be the Architect for the purpose of this contract, such other person as the Owner shall nominate for that purpose, not being a person to whom the contractor shall object for reasons considered to be sufficient by an arbitrator appointed in accordance with the said conditions. Provided always that no person subsequently appointed to be the Architect under this contract shall be entitled to disregard or overrule and certificate or opinion or decision or approval or instructions given or expressed by the Architect for the time being.

4. The said condition and Appendix thereto shall be read and constructed as forming part of this agreement, and the parties here to shall respectively abide by, submit themselves to the conditions and the perform the agreements on other parts respectively in such conditions contained.

**AS WITNESSED** the hands of the said parties.

**SIGNE BY THE SAID IN THE  
PRESENCE OF**

**CONTRACTOR**

Witness:

Name:

Address:

## APPENDIX – ‘A’

- |  |   |
|--|---|
| 1. DATE OF COMMENCMENT:  | Immediately with issue of the work order.   |
| 2. DATE OF COMPLETEION:  | 30 Days ( From the Date of Work Order)  |
| 3. LIQUIDITY DAMAGES:  | 0.5% Per Week of delay or part thereof but maximum 5% of the Contract amount  |
| 4. DEFECTS LIABILITY PERIOD:                                     | 12 Months.  |
| 5. VALUE OF WORK FOR INTERIUM CERTIFICATE:                       | Rs. 400,000/- and above.  |
| 6.EARNEST MONEY DEPOSIT:   | 5% of Contract value.<br><br>1% of Tender value subject to maximum Rs.12000/- in Demand Draft in favor of <b>INDIAN BANK</b><br><br>Furniture Amount to make total 2% of Tender Amount on acceptance of Tender. |
| 7.RETENTION AMOUNT:  | 8% Of value of Total work excluding earlier money and security deposit from running bills.  |
| 8.RETENTION AFTER VITUAL COMMENCEMENT AGAINST DEFECTS LAIBILITY: | 5% Of Total Bill (Certified) amount for 12 months.  |
| 9.PERIOD FOR HONORNG CERTIFICATES BY THE EMPLOYER:               | 10 Days (after receipt of certificates from the Architect by the Employer)  |

We agree to the Terms incorporated in the above Appendix-‘A’

Date:

**Signature of contractor with Stamp/ Seal.**

**Note:**

**The Brands/ Make mentioned in the following List should be used by the contractor and Rate quoted should be based on the same. In case of the brand / make is not available, material of other make should be used with prior approval of Architect and Bank. The rates will be revised, based on the difference in the basic rates of the make brands / name mentioned below:**

**LIST OF RECOMMENDED MATERIAL TO BE USED BY CONTRACTOR:**

|                               |  |
|-------------------------------|--|
| 1. MARINE/ COMMERCIAL PLY:    | IS 303 M. R. Grade Green/ Century/ Durian/ Samrat / Garnet/ Mayur/ EURO/ Uni Ply / Monark/ DURO/ Finest (6mm, 9mm, 12mm, 19mm thick) |
| 2. LAMINATES:                 | Green-Lam, Marino, Royal Touch., Century, Samrat, Royal Crown, AICA Sunmica. (1mm thick),  |
| 3. SCREWS ( M.S.OXIDISED)     | G.K.W. OR EQUIVALENT   |
| 4. BRASS HINGES:              | Reliance, Punit Heavy Duty.  |
| 5. DRAWER SLIDER FITTING:     | Hafele, Dorma, Enox, CNR, EBCO, for all drawers.   |
| 6. HARDWARE:                  | Reliance, Suzu, Magnum.  |
| 7. DRAWER SHUTTER LOCK:       | Godrej, Vijayan ( with Master Key, 3sets of keys)  |
| 8. BALL CATCH:                | Magnetic (M.2.)S.S.  |
| 9. DOOR LOCKS                 | 4-C, Acme, Godrej, Ultra.  |
| 10.S.S. HANDLES:              | PAG, Hafelle, Dorma, Enox .  |
| 10. VENEER:                   | Century, Durian, Samrat, Timex, URO, Green.<br>(Basic cost of Veneer up to Rs.125/- sqft)  |
| 11. ADHESIVE:                 | Favicol (SH) for furniture, Lamination etc.<br>Araldite of Hindustan Ceiba Geigy Ltd. For fixing<br>Stainless steel mirror etc.      |
| 12.STAINLESS STEEL:           | Salem 16 gauge thick.  |
| 13. DOOR CLOSER:              | PAG, Hafele, Dorma, Enox.  |
| 14. GLASS TINTED/ MIRROR:     | Modi float, TATA, Saint Gobain.  |
| 15.POLISH:                    | Zinc Oxide or Melamine (Asian)   |
| 16.ALLUMINIUM GRILL:          | Jindal, Geeta, Allu Grill.   |
| 17.GYPSUM BOARD:              | India Gypsum, Project Interior.  |
| 18. P.V.C. FLOORING:          | Carara, Premier, Royal.  |
| 19. PAINT:                    | Asian, I.C.I. Dulux, Berger.   |
| 20. GALVANISED FALSE CEILING: | Trac, Vista, Luxlon.   |

|  |   |
|--|---|
| 21. ALLUMINIUM MATERIAL FALSE CEILING: | Trac, Supercil, Vista.  |
| 22. ALLUMINIUM DOOR & WINDOW SECTION:  | Jindal, Indal, Geeta.   |
| 23. FLOOR SPRING/ DOOR CLOSERS:        | PAG, Haffelle, Dorma, Enox.                                       |
| 24. UPHOLSTERY:                        | Reliance, Raymond, Orkey.   |
| 25. WOOD PRESERVATION:                 | Asian Paint, British Paint.                                       |
| 26. VERTICAL BLAINDS:                  | Vista, Mac, Luxaflux, Aerolux.                                    |
| 27. VITRIFIED TILES :                  | H. R. Johnson, Kajaria, URO, NITCO (1 <sup>st</sup> Quality Only) |
| 28. CEMENT:                            | L & T., Ambuja, Narmada, ACC.                                     |
| 29. SUN CONTROL FILM:                  | Garware.  |
| 30. CEMENT PAINT:                      | Snowcem, Surfaced.  |
| 31. STAINLESS STEEL SINK.              | Nirali, Diamond.  |
| 32. CASTORS:                           | Rexello (Load Capacity 100 Kg.)                                   |
| 33. CARPETS:                           | Hitkari, Modi.  |
| 34. CERAMIC TILES:                     | Kajaria, Jhonson, NITCO, Somany (1 <sup>st</sup> Quality Only)    |
| 35. BIB COCK:                          | Jaquar, Plumber, Aquel.   |
| 36. SANITARY FITTINGS:                 | Parryware, Neycer, Hindustan, Cera.                               |
| 37. FLUSH CYSTERNS:                    | Commander Top Hung with concealed Flush Valve, Slim-line.         |
| 38. PVC PIPES:                         | Finolex, Prince, Garware.   |
| 39. CPVC/ UPVC PIPES:                  | Finolex, Prince, Ashirwad, Astal ISI make only/-                  |
| 40. G.I. PIPES:                        | TATA, Zenith. (C-class)   |
| 41. MDF PARTICLE BOARD :               | Associates, Century, Green, Marino.<br>(Exterior grade Only.-)    |
| 42. W.C. PAN:                          | H.R. Jhonson, Parryware, Neycer, Hindware, Cera.                  |
| 43. ALLUMINIUM COMPOSITE PANEL:        | Flexi Bond, Allu Decor , Euro Bond, Timex Bond.                   |

**INDIAN BANK**

**TENDER FOR INTERIOR WORK OF MULUND (WEST) BRANCH.**

| Sr.No    | Description  | Qty. | Per    | Rate | Amount (Rs.) |
|----------|--|------|--------|------|--------------|
| <b>I</b> | <b>CARPENTARY WORK:</b>  |      |        |      |              |
| 1        | Cash Cabin Side & Rear Glass partition:<br>Providing & fixing partly glazed partition to the sides of Cash cabine made of 18 gauge aluminum section members of 2" x 2" size alluminium pipe frame finished (Weight should be 225 gms/ Rft) @ 2'-0" centre to centre frame both ways including 6mm thk ply on both sides with 1.0 mm sued/matt finish laminate upto 3'0" height. In between 3'0" to 6'0" height, 12 mm thick glass with etched borders as per design to be fixed with 2" x 2" size aluminum section / laminated beading finished with paint / polish as directed including opening for passbook printers, registers etc.complete as per Design Rate to include additional 2" x 2" size centre aluminum section member at skirting level and glass to be machine polished in case of Cash partitions with 12mm. thk. glass. this will have curved top with machine polished edges as per detail drg. | 85   | Sq.ft. |      |              |
| 2        | Front Glass Railing for Cash 12mm. Thk.Thoughned glass :<br>Providing and fixing 12mm thick Toughened glass with matt steel D-brackets and Patch Fittings as per design fixed to partition side glass including 2" wide slits/ 4" dia. Round and 4 ½" half round opening in the glass as per detail drawing. All exposed edges of glass to be machine polished.(All glasses to be used for front Railing is to be 12mm. thkToughened Glass of TATA/ Modi/ Saint Gobain Make)   | 18   | Sq.ft. |      |              |

|   |   |     |        |  |  |
|---|---|-----|--------|--|--|
| 3 | <p>Front Glass Railing for Counter 12mm. Thk. Toughned glass<br/>         Providing and fixing 12mm thick Toughened glass with matt steel D-brackets and Patch Fittings as per design fixed to partition side. All exposed edges of glass to be machine polished.(All glasses to be used for front Railing is to be 12mm. thkToughened Glass of TATA/ Modi/ Saint Gobain Make)</p>  | 110 | Sq.ft. |  |  |
| 4 | <p>Branch Manager Cabin Full glazed Partition:<br/>         Prov.&amp; fixing 12mm. thk. Full ht.Toughened Glass partition to with etched borders as per design. Rate should be inclusive of additional Alluminium Profile fixed in the flooring and top above finished false ceiling level to hold the glass with additional wooden support in the ceiling partition. Rate should be also inclusive of 3'-0" size door with 18" ht. S.S. Matt steel H handle with Patch floor spring and centre locking arrangement of Enox/Dorma/Haffele Co. make</p> | 75  | Sq.ft. |  |  |
| 5 | <p>Branch Manager/Sever Rm. Partly glazed Partition: Prov.&amp; fixing Full glazed partition to Branch Manager cabin Partition with 12mm. thk. glass full ht.with etched horizontal lines having T.W. Member of 4" x 2" Size alluminium pipe frame member on top as per design to be fixed with 4" x 2" T.W. moulding/ laminated beading, finished with paint/ polish as directed. Completed as per design. Rate should include Horizontal lines of 1/2" ht. with 1" gap in between as per detail dwgs.</p>   | 225 | Sq.ft. |  |  |

|   |  |      |        |  |  |
|---|--|------|--------|--|--|
| 6 | <p>Solid Partition full ht.<br/> Providing &amp; fixing solid partition of 18 gauge aluminum section members of 2" x 2" aluminium pipe frame (Weight should be 225 gms/ Rft) @ 2'-0" c/c both ways including 12mm thk Exterior Grade Partical Board on both sides with bright Silver ACP Composite Panneling on E-Lobby side and Calcium Silicate Board with white acrylic emulsion painting from UPS side etc. complete as per Design. Rate to include 6" ht. Alluminium Powdercoated Aircon louvers of approved color in full length fixed on top.</p> | 105  | Sq.ft. |  |  |
| 7 | <p>Full ht.Solid Partition with Calcium Silicate :<br/> Prov.&amp; fixing Full ht. Solid partition with 18 gauge aluminum section members of 2" x 2" (Weight should be 210 gms/ Rft) @ 2'-0" centre to centre frame both ways including 12mm. thk. Calcium Silicate boards on Both side finished with Off White Acrylic Emulsion paint and one coat of primer as directed. Complete as per design.</p>   | 125  | Sq.ft. |  |  |
| 8 | <p>Solid Partitions Low height :<br/> Providing &amp; fixing solid partition of 18 gauge aluminum section members of 2" x 2" aluminium pipe frame (Weight should be 225 gms/ Rft) @ 2'-0" c/c both ways including 6mm thk ply on both sides with 1.0mm sued/matt finish laminate on both side etc. complety as per Design. Rate to include additional 18 gauge aluminum section members of 2" x 2"@ 2'-0" frame member at skirting level. (4'-0"height)</p>  | 95   | Sq.ft. |  |  |
| 9 | <p>E-Lobby Divider Glazed partition (5'-0" ht.) :<br/> Providing and fixing of soild partition with 12mm thk. particle board on both side with alluminium framing finished with white colour ACP panelling. The partition will have 12mm thk. toughened glass division of appropriate size with machine polished edges on top.</p>   | 17.5 | Sq.ft. |  |  |



|    |  |     |        |  |  |
|----|--|-----|--------|--|--|
| 10 | <p>Providing, fixing in position Sandwich grill partition: fabricating &amp; tying to the partition frame <b>M.S. hidden grill</b>, out of 12 x 12 mm square rods @5" c/c.both ways with 35mm x 5mm. M.S. Angle frame casing all around fixed to the floor, wall and ceiling with Cement fastner bolts at regular intervals finished with one coat of metal primer and to be covered with 18 gauge aluminum section members of 2" x 1" @ 2'-0" centre to centre frame both ways including 8 mm thk. IS303 MR garde ply on one side with 1.0mm thk. laminate upto ceiling level with dark colour borders and skirting from branch side and PVDF Composite Panel finish from ATM side Complete as per design. up to the ceiling.</p> | 170 | Sq.ft. |  |  |
| 11 | <p>Full ht. Toughened Glass Partition Entrance side:<br/> Prov.&amp; fixing 12mm. thk. Full ht. Toughened Glass partition to with etched borders as per design. Rate should be inclusive of additional Alluminium Profile fixed in the flooring and top above finished false ceiling level to hold the glass with additional wooden support in the ceiling partition. Rate should be also inclusive of 3'-0" size door with 18" ht. S.S. Matt steel H handle with Patch floor spring and centre locking arrangement of Enox/Dorma/Haffele Co. make Rate should include Horizontal lines of 1/2" ht. with 1" gap in between as per detail dwgs.</p>   | 81  | Sq.ft. |  |  |

|    |  |   |      |  |  |
|----|--|---|------|--|--|
| 12 | <b>DOORS :</b>   |   |      |  |  |
| a) | <p>Cash Cabin Door :</p> <p>Providing &amp; fixing shutter Cash cubicals made out of 2" thk. MarineBoard Flush door with 1'-0" wide 6mm thk. glass in the centre leaving 6" from bottom and 4" from top to be fixed with 1" x 3/4"</p> <p>T.W.moulding/laminated . Beading, shutter to be finished with 1.0 mm thick sued finished laminate and to be fixed to partition with 3 Nos 4" x 1 1/4" S.S. hinges with S.S. Pin, Godrej night latch, Matt Steel handle,Door Closer, 4"ht.S.S. tower bolt etc. complete size (2'-3"x6'-6") Rate should be inclusive of 1/2" ht. horizontal etching lines with 1" gap in between etc. complete</p> <p>Providing &amp; fixing shutter Cash cubicals made out of 2" thk. MarineBoard Flush door with 1'-0" wide 6mm thk. glass in the centre leaving 6" from bottom and 4" from top to be fixed with 1" x 3/4"</p> <p>T.W.moulding/laminated . Beading, shutter to be finished with 1.0 mm thick sued finished laminate and to be fixed to partition with 3 Nos 4" x 1 1/4" S.S. hinges with S.S. Pin, Godrej night latch, Matt Steel handle,Door Closer, 4"ht.S.S. tower bolt etc. complete size (2'-3"x6'-6") Rate should be inclusive of 1/2" ht. horizontal etching lines with 1" gap in between etc. complete</p> | 1 | No.s |  |  |
| b) | <p>Doors to Branch Manager cabin :</p> <p>Providing &amp; fixing shutter to Manager cabin made out of T.W. 4" x 1" Top rail and 6" x 1" Bottom rail, with 12mm thk. glass pannel fixed with 1"x3/4"thk.T.W. moulding /laminated. Shutter to be finshed with 1.0mm thk. laminate sued/matt&amp;to be fixed to floor with Heavy Duty Floor Spring, Vijayan Mortice lock,Matt Steel Handle, etc. completed size 3'-0" x 7'-0". Rate should be inclusive of 1/2" ht. horizontal etching lines with 1" gap in between etc. complete as per detail drg.&amp; Architect's instructions.</p>   | 1 | No.s |  |  |

|    |   |   |      |  |  |
|----|---|---|------|--|--|
| c) | Doors to Toilet Entrey/Sever/UPS:<br>Prov. & fix. Door of 3'-0" x 7'-0" size with 8mm. Thk. Glass & made of 35mm. thick flush door shutter with both side laminate . The rate should be inclusive all hard wares like 3 No.of brass hinges.C.P. handles.etc. Round Gully Knobs with concelead lock, complete as per the designs and details form the Architects   | 3 | No.s |  |  |
| d) | Wicket Gate : (size 3'-0" x 4'-6")<br>Prov & fix Wicket gate of 2" thk.Marine Board flush door shutter with both side 1.0mm thk. Laminate sued/matt finished & also to the edges etc. complete (3'-0"x4'-6"size) fixed with 4"ht. S.S. Hinges with S.S. pin & 4" ht. S.S.Tower Bolt   | 1 | No.s |  |  |
| e) | New Entrance door (Size 3'-6"x7'-0" ) :<br>Providing & errecting Double leaf new main entrance door of 5'-0" x 7'-0" size with 12mm. thk. toughened Glass with matching horizontal etched linings of 1" frost & 1/2" clear as per design/ Etched Emblem of Bank on top on each pannel. Matt steel door handles with floor locking 48"ht. of Enox or equivalent Co. make on the both the side/ The rate should be inclusive all hard wares like S.S. finished Patch fitting Hinges, Floor spring Enox, Ozone, Haffele, Dorma make etc.complete as per the designs and details form the Architects. The Rate shall be inclusive of Horizontal Etched Linings In between 3' to 6' horizontal etched linings of 1" frost & 1/2" clear as per design | 1 | Nos. |  |  |

|    |  |     |      |  |
|----|--|-----|------|--|
| f) | <p>E-Lobby door (Size 3'-0"x7'-0" ) :<br/>         Providing &amp; erecting Single leaf new main entrance door of 3'-0" x 7'-0" size with 12mm. thk. toughened Glass with matching horizontal etched linings of 1" frost &amp; 1/2" clear as per design/<br/>         Emblem of Bank on top on each pannel. Matt steel door handles 48"ht. with floor locking arrangement of Enox or equivalent Co. make on the both the side/ The rate should be inclusive all hard wares like S.S. finished Patch fitting Hinges, Floor spring Enox, Ozone, Haffele, Dorma make etc.complete, as per the designs and details form the Architects. The Rate shall be inclusive of Horizontal Etched Linings In between 3' to 6' horizontal etched linings of 1" frost &amp; 1/2" clear as per design</p>          | 1   | Nos. |  |
| 13 | <p>Cash Counter :<br/>         Providing and fixing Cash Counter with 1'-0" wide customer counter top at 12" ht. from main counter top of 19mm. thk. Ply finished with matching laminate. The Front Apron should have 18mm. thk vertical Ply in light colour with 4' ht. Skirting of Dark colour Laminate as per drg. including keyboard drawer on telescopic channels and storage box with 3 no.s drawers of eq. size from top of 6mm. thk. ply. fin.with french polish This should have 3/4' thk.ply shelf fin. with matching laminate for C.PU as per drawing with T.W.member of 2 1/2" x 1 1/2"menber at skirting level for foot rest. All external edges to be in colured polished and internal surfaces to have french polish as per Arch.'s instructions.(clear width of counter 2' 6")</p> | 4.5 | Rft. |  |

|    |  |          |      |  |  |
|----|--|----------|------|--|--|
| 14 | <p>OffierCounter :</p> <p>Providing and fixing Offier Counter with 19mm. thk. Ply finished with matching laminate. The Front Aprron should have 18mm. thk vertical Ply in light colour with 4' ht. Skirting of Dark colour Laminate as per drg. including keyboard drawer on telescpopic channels and storage box with 3 no.s drawers of eq. size from top of 6mm. thk. ply. fin.with french polish This should have 3/4' thk.ply shelf fin. with matching laminate for C.PU as per drawing with T.W.member of 2 1/2" x 1 1/2"member at skirting level for foot rest. All external edges to be in colured polished and internal surfaces to have french polish as per Arch.'s instructions.(clear width of counter 2' 6")</p>  | 4        | Rft. |  |  |
| 15 | <b>TABLES :</b>  |          |      |  |  |
| a) | <p>Branch Manager Table (5'-0" x 2'-6") :</p> <p>Providing and Supplying Manager's table made out of 19mm thick MR grade ply boxing of approved quality and make. Teak wood lippings, foot rest etc. Table top made out of 12mm thick MR-grade ply backing, Table size (2' - 6"wide x 6'- 0"long x 2'-6"ht)Sitting area will have one drawer units in 3Nos x 6"ht drawers with locking arrangements. Earlbihari powder coated Telescopic channels to be provided all the drawers, key board trays, space for CPU stand, wire manager etc; Table top (working area lvl.) with 12mm thick glass with crystal edge poilsh finish with 1.5" ht. studs on top area front fascia in side &amp; out side finished with 1.0mmthick lamination finish of approved quality and shade complete finished with French polish on inside area of drawer units. Key board trays etcas per the designs patterns,details and instructions.</p> | <b>1</b> | Nos. |  |  |

|    |   |   |      |  |  |
|----|---|---|------|--|--|
| b) | Asst. Manager Table (4'-6" x 2'-6") :<br>Providing & fixing Asst. Manager table of 5'-0"x 2'-6"size with 4"ht. drawers on telescopic channels and 15"wide side storage cupboard below with 3/4" comm. Ply shutter with locking arrangement and 1.0 mm.thk.laminate having 3" x11/2"thk. T.W.foot rest and 3/4"thk.all external edges to be colour polish and internally with french polish as per detail drg.   | 1 | Nos. |  |  |
| c) | Officer /Clerk Table (4'-0" x 2'-6") :<br>Providing & fixing Officer table of 4' 0"x 2' 6"size with 4"ht. drawers on telescopic channels and 15"wide side storage cupboard below with 3/4" comm. Ply shutter with locking arrangement and 1.0 mm.thk.laminate having 3" x11/2"thk. T.W.foot rest and 3/4"thk.all external edges to be colour polish and internally with french polish as per detail drg.  | 7 | Nos. |  |  |
| d) | Lunch Table (Size 6'-0"X 3'-0") :<br>Providing and Making Lunch Table made out of 19mm thk ISI 303 BWR grade ply boxing of approved quality and make. Teak wood lippings, foot rest etc. Table top made out of 19mm thk. ISI 303 BWR-grade ply backing table The top below should be finished middle colour laminate with dark border front fascia in side & out side finished with light & dark colour matching laminate finish.etc. as per the designs patterns,details and instructions. | 1 | Nos. |  |  |
| 16 | Side Storages :<br>Providing and fixing new wooden side storages made out of 19mmthick BWR grade ply boxing OR 12mm. thk. exterior grade particle board , teak wood lippings.silding /openable shelves (19mm thick) and fully exposed area finished with 1.0mm thick laminate finish of approved quaility and shade inside area finished with French polish etc. complete as per designs patterns and instructios.  |   |      |  |  |
| a) | Size (3'-6" x 2'-6") :  | 1 | Nos. |  |  |
| b) | Size (3'-0" x 2'-6") :  | 2 | Nos. |  |  |

|    |  |     |        |  |  |
|----|--|-----|--------|--|--|
| 17 | <p>Full Ht. Storage Unit :<br/>         Providing &amp; fixing Full ht storage filling Unit 15" deep of 3/4"thk. ISI 303 BWR grade ply OR 12mm. thk. exterior grade particle board on shutters 2no.s (up to 4'-0" from Ground &amp; 3'-0" ht. above) finished with 1mm thk. Sued/matt finished laminate of app.shade as per design and 6mm.thk. ply back with 2 no.s of shelf in top &amp; bottom to be finished with 1mm thk. sued white laminate &amp; Lock etc. complete.</p> | 190 | Sq.ft. |  |  |
| 18 | <p>Low Ht. Storage Unit :<br/>         Providing &amp; fixing Low ht storage filling Unit 15" deep of 3/4"thk. ISI 303 BWR grade ply OR 12mm. thk. exterior grade particle board on shutters finished with 1mm thk. Sued/matt finished laminate of app.shade as per design and 6mm.thk. ply back with 2 no.s of shelf to be finished with 1mm thk. sued white laminate &amp; Lock etc. complete.</p>   | 15  | Sq.ft. |  |  |
| 19 | <p>Round Writing Desk :<br/>         Providing and fixing 3'-6" Length &amp; 1-6" wide slip writing desk in the centre of customerside area made out of 19mmthick MR grade ply boxing in horizontally. 6"wide grid in vertically , fully inside area in 1.0mm thick lamination finish of approved quality and shade. 12mmthick clear glass on top (in crystal edge polish finish) complete as per the designs.</p>   | 1   | Nos.   |  |  |

|    |  |     |        |  |  |
|----|--|-----|--------|--|--|
| 20 | <p>PVDF Composite Pannel Cladding on Columns :</p> <p>Prov. &amp; fix. In position Metallic Bright Silver All. Composite Pannel Cladding with PVDF Coating and LDPE Copre Laminated with Alludecor/ EuroBond/ TimexBond extrior grade 4mm. thk. with Composite of ( 0.5 mm.- 3.0 mm. - 0.5mm. thk.) including Fabrication for the same with Alluminium Sections &amp; necessary hardware, Silicon-Sealant ( Dow Coring-789), masking Tapes, necessary Scaffolding on Two sides.</p>  | 200 | Sq.ft. |  |  |
| 21 | <p>Soft Board panneling :</p> <p>Providing &amp; fixing 1/2"thk. Softboard to be fixed on 6mm. Thk. Ply &amp; to be covered with woolen felt/ cloth of approved colour and Texture Basic cost of cloths up to 350/Rmt. including side leaping patti fin.with colour polish etc. complete.</p>  | 30  | Sq.ft. |  |  |
| 22 | <p>Laminate Panneling to walls (4'-0" ht):</p> <p>Prov.&amp; fixing panneleing to walls in office area with 18 gauge aluminum section members of 2 1/2" x 1 1/2" (Weight should be 210 gms/ Rft) @ 2'-0" centre to centre frame both ways including 6mm thk.ply on one side with 1.0mm sued/matt finished laminate upto ceiling level. as per design. Complete as per design. Rate should be inclusive of Gypsum Sheet with white Paint/ Coom ply with white laminate above door height upto the ceiling bottom &amp; additional 2" x 11/2" T.W. member at skirting level.</p> | 20  | Sq.ft. |  |  |



|    |   |     |        |  |  |
|----|---|-----|--------|--|--|
| 23 | <p>E lobby PVDF Composite Panneling to walls Full ht:<br/> Prov. &amp; fix. In position Metallic Bright Silver All. Composite Pannel Cladding to walls with PVDF Coating and LDPE Copre Laminated with Flexi Bond/Alludecor/ EuroBond/ TimexBond extrior grade 4mm. thk. with Composite of ( 0.5 mm.- 3.0 mm. - 0.5mm. thk.) including Fabrication for the same with Alluminium Sections &amp; necessary hardware, Silicon-Sealant ( Dow Coring-789), masking Tapes, necessary Scaffolding on Two sides.</p>                  | 115 | Sq.ft. |  |  |
| 24 | <p>Notice Board :<br/> Prov.&amp; mak.display notice board of Champeon Gold Anodised Alluminium frame with Glass shutter having soft borad panelling inside to be finished with Felt/ Cloth of approved texture (Basic Cost Rs.350/Rmt.) with back and having 2 no.s of hooks etc. complete polish.(size 2' 0" x 3' 0") As per Arch.'s Instruction</p>  | 1   | Nos.   |  |  |
| 25 | <p>Suggestion Box :<br/> Prov. &amp; fix suggestion box of 18" x 24" size angular front of 3/4" thk comm. Ply. &amp; lam. Fin. Top with openable shutter having Locking arrangement of vijayan mortice lock with necessary hardware etc. complete as per Arch.'s Instruction</p>  | 1   | No.    |  |  |
| 26 | <p>Pannel Board Cabinet :<br/> Providing and fixing electrical panel board area shutter (openable and partly louvered) made out of 19mm thick MR grade ply boxing, shutters. The Board will have 12mm. thk back of MR grade ply with 12mm. thk bison board top on all internal surfaces and 1.0mm thick laminate finish on front, with app. colour polish to external edges brass hinges, handles etc. as per the details. The shutters should have 12" ht. All. Powder coated louvers on top and bottom for ventilation.</p> | 35  | Sq.ft. |  |  |

|                               |  |    |        |  |  |
|-------------------------------|--|----|--------|--|--|
| 27                            | M.S. Collapsible Gate to Entrance :<br>Providing and fixing M.S.Collapsible Gate at the branch entrance with standard size gate telescopic channels having 20mm.x 5mm.M.S.patti's inside & M.S.Angle (31x31x3 size) frame with Red- oxide based coat & two coats of Black / Silver Oil- Paint etc. complete. Rate should be inclusive of additional M.S. girder support at one side to hoist the Shutter frame and other side will be fixed to the wall. | 40 | Sq.ft. |  |  |
| 28                            | M.S. Grills: Prov. & Fix. M.S. Grills to entrance glass partition of out of 12 x 12 mm square rods @125 mm c/c.both ways with 35mm x 5mm. M.S. Angle frame casing all around fixed to the floor, wall and ceiling with Cement fastner bolts at regular intervals. Rate should be inclusive of Red- oxide based coat & two coats of Black Oil- Paint etc. complete.   | 54 | Sq.ft. |  |  |
| 29                            | 18" ht. x 3" BWR. Ply Boxing for Split AC :<br>Prov. & fix. 3" deep 18 mm. thk. MR ply boxing for covering AC Copper piping and cableing etc. complete to be finished with matching light colour laminate. (Ht. Upto 18" as required )   | 90 | Sq.ft. |  |  |
| <b>TOTAL CARPENTARY WORK:</b> |  |    |        |  |  |
|                               |  |    |        |  |  |
|                               |  |    |        |  |  |

| II | P.O.P. WORK:  |     |        |  |  |
|----|---|-----|--------|--|--|
| 1  | <p>Gypsum Board Ceiling (with painting) : Providing &amp; Fixing suspended 12.5 mm thick gypsum false ceiling, including P&amp; F G.I.Perimeter channels of size 0.55mm thick having one flange of 20mm &amp; another flange of 30mm &amp; aweb of 27mm along with perimeter of ceiling screw fixed to brick wall/ partition with the help of nylon sleeves and screws at 600mm centres then suspended G.I. Intermediate channels of size 45mm x 0.9mm thk. with 2 flanges of 1.5mm each from the soffit at 1220mm centres with the ceiling angle of width 25mm x 10mm x 0.55mm thk. fixed to soffit with G.I. &amp; steel expansion fastners. (As per manufacturer's specifications) Rate should be inclusive matching Acrylyc Emulsion paint in thwo coats with one coat of Primer paint in line level etc. complete</p> <p>Notes:- Area of the False Ceiling wil be measured in plan ie; Wall to Wall.</p> | 100 | Sq.ft. |  |  |
| 2  | <p>Prov. &amp; fix. Mineral Fibere Ceiling : Providing and fixing Mineral Fibbre false ceiling made out of Powdercoated G.I supported Scelotte Grid frames with 2'-0" x2'-0" size 12mm thick armstrong/Project Interior co. Tiles fixed below with necessary cut outs for light fittings,ultima board of approved design fully in the and level and as per the instructions.</p>  | 800 | Sq.ft. |  |  |
| 3  | <p>Gyp. Board 6" Deep patta (with painting) : Prov. &amp; fixing Gyp. Board 1' Deep patta at junction of walls and Ceiling and edges of Tube light Truff. With 10" wide flat band .Rate shousl be inclusive matching Acrylyc Emulsion paint in thwo coats with one coat of Primer paint in line level etc. complete</p>   | 108 | Rft.   |  |  |
|    | <b>TOTAL P.O.P. WORK:</b>   |     |        |  |  |
|    |   |     |        |  |  |
|    |   |     |        |  |  |

|            |   |    |        |  |  |
|------------|---|----|--------|--|--|
| <b>III</b> | <b>PAINTING WORK:</b>   |    |        |  |  |
| 1          | Texture Paint / Wall Paper :<br>Providing & Fixing Birla/ Spectrum/<br>Nitco/ Kemtex/ Asian Paints make<br>texturised paint after removing existing<br>finishes of plaster and applying<br>texturised paint as per the<br>Manufacturar's specifications OR<br>Pasting up the Wall Paper of approved<br>design to any given wall surface with<br>aproprate adhesive including leveling<br>the existing surface with plaster of POP,<br>cracks filled with chemicals/ M-Seal<br>material etc. complete as per site<br>requirement and instructions of<br>Architect. | 60 | Sq.ft. |  |  |
|            | <b>TOTAL OF PAINTING WORK:</b>  |    |        |  |  |
|            |   |    |        |  |  |
|            | <b>SUMMARY:</b>   |    |        |  |  |
| <b>I</b>   | <b>CARPENTARY WORK:</b>   |    |        |  |  |
| <b>II</b>  | <b>P.O.P. WORK:</b>   |    |        |  |  |
| <b>III</b> | <b>PAINTING WORK:</b>   |    |        |  |  |
|            | <b>TOTAL AMOUNT (WITHOUT<br/>GST):</b>  |    |        |  |  |
|            |   |    |        |  |  |
|            | <b>Add CGST @ 9% Rs.</b>  |    |        |  |  |
|            |   |    |        |  |  |
|            | <b>Add SGST @ 9% Rs.</b>  |    |        |  |  |
|            |   |    |        |  |  |
|            | <b>Rounded off Rs.</b>  |    |        |  |  |
|            |   |    |        |  |  |
|            | <b>GRAND TOTAL (WITH GST):</b>  |    |        |  |  |

**Signature of contractor with Stamp/ Seal.**

PRODUCED BY AN AUTODESK EDUCATIONAL PRODUCT

PRODUCED BY AN AUTODESK EDUCATIONAL PRODUCT

PRODUCED BY AN AUTODESK EDUCATIONAL PRODUCT

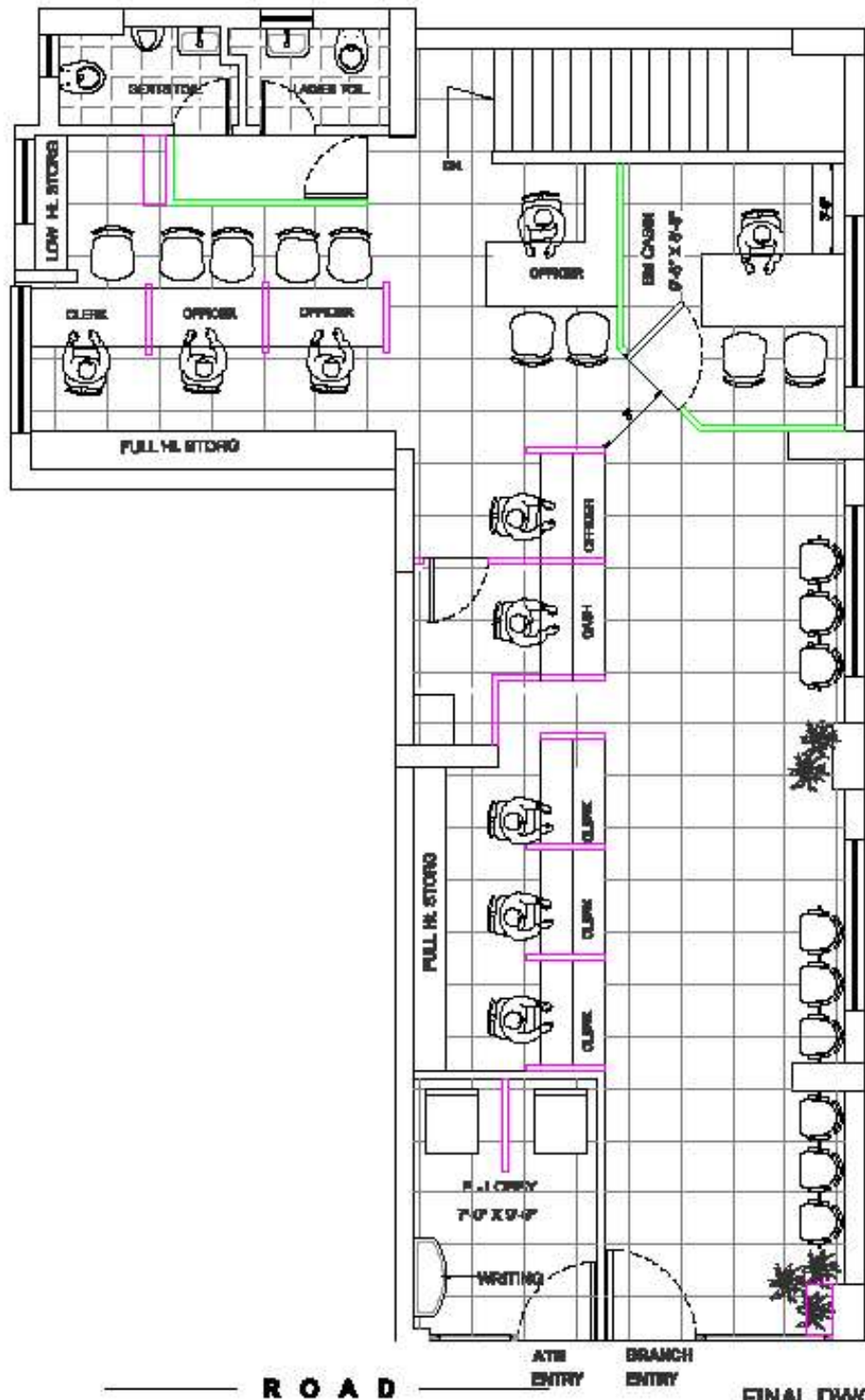

R O A D

FINAL DWG.

PROPOSED **MEASUREMENT LAYOUT**  
 OF GROUND FLOOR OF MULUND  
 BRANCH FOR INDIAN BANK



**KALA AREKHAN**  
 ARCHITECT & INTERIOR DESIGNERS  
 901, CHANDRUP VINDYACHAL CO-OP. HSG. SOCIETY,  
 PLOT NO.289, SECTOR-4, CHANDRUP KARNATAKI (M),  
 MUMBAI, MCL-400007  
 PHONE: MCL - 80000 8000 / 80000 8000

DATE: 14-10-2018 SCALE: 1:100 DRAWN BY: VAISHNA

PRODUCED BY AN AUTODESK EDUCATIONAL PRODUCT