

(A GOVT. OF INDIA UNDERTAKING)

**ZONAL OFFICE, ASANSOL**

**NOTICE INVITING TENDER**

Indian Bank, Zonal Office Asansol, invites competitive sealed tenders in the prescribed format on item rate basis two bids (technical & financial) systems from the interested, reputed, well experienced Bank's Corporate Office empanelled contractors / firms (Corporate Office empanelment letter to be enclosed) for the below mentioned work of RAMPC, Asansol at Udrej Bhawan, 2 (8) G. T. Road, Upper Chelidanga, Asansol 713304

Tender document along with other details may be downloaded from Bank's web site [www.indianbank.co.in](http://www.indianbank.co.in) or may be obtained from **Premises & Expenditure Department, Zonal Office Asansol, Udrej Bhawan, 2<sup>nd</sup> Floor, 8 G.T. Road, Asansol, Paschim Burdwan- 713304, W B,** as per following scheduled.

1	Name of work	<b>Electrical Works, Light &amp; Fan Fitting and Data Cabling Works etc.</b> at new premises of <b>RAMPC, Asansol at Udrej Bhawan, 2 (8) G. T. Road, Upper Chelidanga, Asansol 713304</b>
2	Estimated Cost	Rs. 3,39,840.00
3	Publication of "Tender" inviting offers	13.09.2021
4	Submission of Tender	13.09.2021 to 27.09.2021 upto 3:00 P.M.
5	Opening of Tender	28.09.2021 at 3:00 P.M.
6	Date of Commencement	7 days from date of issue of letter awarding the job.
7	Time of completion of job	20 Days from the date of issue of work order
8	Defect liability period	12 Months from virtual completion of work as certified by the architect, provided to the satisfaction to the Bank.
9	Tender Fee	Rs. 500/- in the form of DD/IOI in favour of Indian Bank payable at Asansol (non-refundable).
10	Earnest Money	Rs. 5000/- in the form of DD/IOI in favour of Indian Bank payable at Asansol. (The EMD of the unsuccessful bidders will be returned within 45 days from the date of opening the tender. No interest will be paid on the Earnest Money deposit.)
11	Liquidated Damages for delay	<b>Rs.2000/-</b> per day subject to max. of 10% of total accepted contract amount. (If the work is not completed to the satisfaction of the Bank within the stipulated period, the contractor shall be bound to pay to the Bank a sum equivalent to Rs.2000/- per day subject to ceiling of 10% of the accepted contract amount by way of liquidated damages and not as penalty during which the work remains un-commenced or unfinished after expiry of the completion date.)
12	Payment Terms	Neither any advance nor any Interim payment will be made. Payment will be made on satisfactory completion of the job on the basis of actual measurements. Income tax will be deducted as per the rules. Retention money 10% will be deducted from the bill and to be released after 12 months from the date of virtual completion provided no defects is observed during this period.
13	Documents to be attached with the Bill	Work Completion Certificate from Branch/Office Head, Manufacture Certification, Bills & 4-5 Photographs showing completion status of work.
14	Retention Money	10% (Including Earnest Money)
15	Terms and Conditions	As per Technical Bid – Part B (enclosed)
<p align="center"><b>Tenders Documents: - Technical Bid and Financial Bid.</b>  <b>A) Technical bid: Part-A &amp; Part B</b>  <b>B) Financial bid: Schedule of Quantity</b></p>		

The duly filled in offer completed in all respect in a separate sealed covers marked "Technical Bid" & "Financial Bid" and superscribing "Electrical Works, Light & Fan Fitting and Data Cabling Works etc. At new premises of RAMPC, Asansol" on top and name, address & contact no. of the vendor at bottom left corner should be addressed to

**The Zonal Manager  
Indian Bank, Zonal Office: Asansol, Udrej Bhavan,  
2<sup>nd</sup> Floor, 8 G.T. Road (West), Asansol – 713304,  
Dist- Paschim Burdwan, WB**

The Bank will not be bound to accept the lowest tender and reserves the right to accept or reject any or all the tender without assigning any reason whatsoever. Late / delayed tender shall not be accepted after due date and time of submission of tender.

**Date: 09.09.2021  
Place: Asansol**

**(Zonal Manager)**



**FORM OF TENDER**

The Deputy General Manager  
Indian Bank,  
Zonal Office Asansol,  
Udrej Bhavan, 2<sup>nd</sup> Floor, 8 G.T. Road,  
Asansol, Paschim Burdwan- 713304,  
West Bengal

Dear Sir,

**Electrical Works, Light & Fan Fitting and Data Cabling Works etc. at new premises of RAMPC, Asansol at Udrej Bhavan, 2<sup>nd</sup> Floor, 8 G.T. Road, Asansol, Paschim Burdwan- 713304,**

We, the undersigned having carefully gone through and clearly understood the plans, specifications, terms and conditions for the above mentioned work, do hereby tender to execute and complete the whole of the work strictly in accordance with the said plans, specifications etc. at the rates set out in the priced bill of quantities.

I/We agree to complete the whole of the work within the time limit specified by the Bank.

The Bank will not be bound to accept the lowest tender and reserves the right to accept or reject any or all the tenders without assigning any reason whatsoever.

I/we agree to keep our offer open for a period of 3 months from the date of opening of tenders.

Thanking you,

Yours faithfully,

(Signature, and Seal of Tenderer)

Date

Address

Mobile No.

E-mail:

**Electrical Works, Light & Fan Fitting and Data Cabling Works etc. at new premises of RAMPC, Asansol at Udrej Bhavan, 2<sup>nd</sup> Floor, 8 G.T. Road, Asansol, Paschim Burdwan- 713304**

**TERMS AND CONDITIONS**

1. The Contractor is advised to inspect and examine the sites and satisfy himself as to the condition prevailing at sites and its surrounding extent of work, scope and conditions under which the work is to be executed. The contractor shall also satisfy himself about the accessibility to the premises.
2. The rate quoted in the tenders shall be inclusive of all materials as required.
3. Work will be completed within the period of 20 days from the date of work order. If the work be not completed to the satisfaction of employer within the stipulated period, the contractor will be bound to pay to Indian Bank a sum equivalent to Rs. 2000/- per day subject to ceiling of 10% of the accepted contract amount by way of liquidated damages and not as penalty during which the work remains uncommenced or unfinished after expiry of the completion date.
4. Contractors are required to submit time schedule of work. After completion of work, cleaning of floors, walls and the site shall be cleared of all rubbish in all respect. All holes shall be filled up and finished as per existing finishes.
5. The tenderer must obtain for himself on his own responsibility and at his own expenses all the information which may be necessary for the purpose of filling this tender and for entering into a contract for the execution of the same and must examine the drawings and inspect the site of the work and acquaint himself with local conditions and matters pertaining thereto, nature and requirements of the work facilities of transport condition, access and storage of material. The tenderer shall provide in their tender the cost of carriage, freight and other charges as also for any special difficulties and including police restriction for transport etc. for proper execution of the work as indicated in the drawings. The successful tenderer will not be entitled to any claim of compensation for difficulties faced or losses incurred on account of any site condition which existed before the commencement of the work or which in the opinion of the architects might have deemed to have reasonably been inferred to be so existing before commencement of work.
6. Each of the tender documents is required to be signed by the person or persons submitting the tender in token of his having acquainted himself with all the conditions/ specifications as may be laid down. Any tender with any such document / paper not signed or with details marked as applied for shall be out rightly rejected. It will be obligatory on the part of tenderers to sign on all the pages of the tender. Conditional tenders shall be rejected. If any of the documents are missing or unsigned the tender shall be considered as invalid also rates not filled up in any item or marked as actual plus percentages shall make the tender as invalid and shall be rejected.
7. The tender form must be typed / written in ink and not by the pencil. The tenderer shall not make any correction/alteration on these documents. Over writing of figures is not permitted. Failure to comply with either of these conditions will render the tender void. No advice or any change in rates or conditions after submission of the tender will be entertained.
8. Security deposit equivalent to 10% from each bill shall be deducted and shall be returned after expiry of defect liability period of 12 months from the date of virtual completion as certified by the architect, provided to the satisfaction to the Bank.
9. All compensation or other sums of money payable by the contractor to Indian Bank under the terms of this contract may be deducted from the security deposit or from any other sum that may be or may become due to the contractor on any account whatsoever and in the event of the security deposit being reduced by reason of such deductions the contractor shall within 7 days of being asked to do so make good in cash or cheque any sum or sums which may have been deducted from his security deposit.
10. In case where the same item of work is mentioned at more than one place in the schedule of quantities the lowest of the rates quoted by the contractor shall be taken into account for payment of the item.
11. The rates quoted shall be firm and shall include all costs, charges, freight, allowances, taxes, levies, taxes, royalties etc. as applicable. **GST should be mentioned separately. Taxes like TDS etc. shall be deducted from the bill(s) of the**



contractor as per prevailing rates. In case of any exemption claimed in this regard the contractor shall submit requisite certificates from the respective departments to Indian Bank in advance.

12. Any damage done to the property of Indian Bank during execution of work shall be the responsibility of the contractor and it shall be made good by him at his cost to the entire satisfaction of consulting architect/ Indian Bank. The architect & engineer shall have full powers to get the material or workmanship etc. inspected and tested by an independent agency for its soundness and adequacy at the cost of contractor. Prior approval of brand and material of ISI make as per the general material specifications is sole discretion of engineer in-charge binding upon the contractor.
13. **The quantities contained in the schedule are approximate only.**
14. No advance shall be released to the contractors at the start of work. Only one running payment shall be made to the contractor as per the work progress after verification of running bill by the architect/ Bank. Tender shall be valid for a period of 3 months from the due date of its submission. **However, Indian Bank is not bound to accept the lowest or any tender and reserves the right to accept or reject any or all tenders either in whole or in part, without assigning any reason for the same. Conditional tenders are not acceptable and shall be summarily rejected. Further, no communication in this regard will be entertained.**
15. All items of work mentioned in the schedule of quantities are to be deemed and paid as completed works in all respects and details including preparatory and finishing works involved directly, related to and reasonably detectable from the drawings, specifications and schedule of quantities and no further extra charge will be allowed in this connection. In the case of lump sum charges in the tender in respect of any item of works, the payment of such items of work will be made for actual work done on the basis of lump sum charges as will be assessed to be payable by Indian Bank/ Architect.
16. The tenderer should note that the tender is strictly on item rate basis and their attention is drawn on the fact that the rates for each and every item should be correct, workable and self-supporting and based on the specification schedule submitted herewith. Financial bids marked as percentages above or below the PWD BSR / CPWD BSR or any such other instrument would be summarily rejected. If called upon by Bank/ Architects detailed analysis of any or all the rates will have to be submitted. The Architects / Bank is not bound to recognize the contractor's analysis.
17. All designated material samples will be tested and inspected at contractor's expense if desired by the Bank at designated laboratories.
18. The contractor shall conform to the provision of all local byelaws and acts relating to the work and to the regulations etc. of the government and local authorities and of any company with whose system the building is supposed to be constructed. The contractor shall give all the notices required by the said act, rules and regulation and byelaws etc. and pay all charges/ fees payable to such authorities for execution of the work involved. The cost if any shall be deemed to have been included in his quoted rates, taking into account all liabilities for licenses, fees for footpath encroachment, restoration etc. and shall indemnify the employer against such liabilities and shall defend all actions arising from such claims of liabilities.
19. For any further drawings/ details/ clarifications please have an advice through the Bank.
20. **Bank reserves the right to cancel all or any of the tenders and can change / drop/ reduce the quantities/ items mentioned in the schedule at any time, before placing of the order or even during execution. The decision of the Zonal Manager in all matters pertaining to the work execution shall be final and binding.**
21. Prior approval to be obtained in writing from project architect/ bank if any change made in the design/ execution of works.
22. Final bill will not be processed until rectification of defects pointed out by the project architect/ bank is carried out by the contractor.
23. All taxes and duties including sales Tax, E.S.I. charges etc. as applicable, Central or Octroi, Royalties, Interstate transportation etc. on works and materials required for use in this project shall be entirely borne & payable by the contractor. The Employer will not entertain any claim whatsoever in this respect. The rates shall be firm and shall not be subject to cost escalation of labour and material and exchange variations, labour conditions and other conditions whatsoever.



24. **Certified photocopies of – GSTIN, PAN Card, (exemption if any) shall need to be submitted along with all bills for issue of payment.**
25. After opening the envelope containing the offer on the standardized conditions and opening of the priced tender, no correspondence will be entertained.
26. **Incomplete tenders shall be rejected and no further communication in this regard will be entertained.**
27. **Indian Bank has the right to accept / reject any or all tenders without assigning any reasons whatsoever.**
28. The tenders shall remain open for acceptance by the bank for a period of 90 days from the date of opening of the second cover containing the priced tender.
29. The tenderer must use only the Tender forms / documents issued by the bank. If given space falls short for furnishing the information's, separate sheets may be added duly signed by the contractors.
30. **Each page of the tender document must be signed by the contractor.**
31. The Tender submitted on behalf of a Firm shall be signed by all the Partners of the Firm or by a Partner who has the necessary authority on behalf of the Firm to enter into the proposed contract otherwise the Tender may be rejected by the Owners.
32. The Contractor shall not assign the contract. He shall not sublet any portion of the Contract except with the written consent of the bank. In case of breach of these conditions, the bank may cause the Architect to serve a notice in writing on the Contractor rescinding the Contract where upon the Security Deposit shall stand forfeited to the bank, without prejudice to his other remedies against the Contractor.
33. The Contractor shall carry out all the work strictly in accordance with Drawings, details and instructions of the Architect/Bank. If changes have to be made in the design. The same will be done with the prior approval in writing of the bank/ Architect. Contractor shall carry out the same without any extra charge. The Bank's decision in such cases shall be final and shall not be open to arbitration.
34. A Schedule of Probable Quantities in respect of each work and specifications accompany these special conditions. The schedule of Probable Quantities is liable to alteration by omissions, deductions of additions at the discretion of the Architect. Each Tender should contain not only the rates but also the value of each item of work entered in a separate column and all the items should be totalled in order to show the aggregate value of the entire Tender.
35. The Tenderer must obtain for himself on his own and at his own expenses all the information which may be necessary for the purpose of making a Tender and for entering into a Contract and must inspect the site of the work and acquaint himself with all local conditions, means of access to the work, nature of the work and all matters appertaining there to.
36. The successful tenderer should make their own arrangements to store all the materials required for the work. No advance against materials purchased and brought at site will be made. The contractor will have to keep the materials at site under their safe custody and at their risk and cost. The Bank/ Owners of premises are not responsible for damages and losses of such materials brought at site.
37. Contractors are requested to note that no extra item of deviated item of work to be executed without taking prior permission from Bank/Architects, if the extra item of deviated item of work is executed without taking prior permission, Bank shall not be held responsible for the payment of such works executed.
38. Work should be executed only at the site under the supervision of a competent supervisor with strict quality control & workmanship Bank/ Architects may inspect the work during its execution at site.
39. No deviation in the specification and make would be acceptable.
40. All furniture such as counters, tables, etc. shall be computer compatible and shall have key board tray, CPU stand, etc.
41. The names of partners of the contractor's firm to be mentioned below :

- (i)
- (ii)
- (iii)

Name of the partner of the firm authorized to sign Or Name of person having Power of Attorney to sign the Contract.  
(Certified true copy of the Power of attorney should be attached)

- 42. The contractors are advised to inspect the drawings available with the Bank before submitting the Tender.
- 43. I/We are the empanelled Bank's contractors / firms. (letter enclosed)
- 44. There must be submission of "Single Line Diagram" for electric works and "As built" drawings in original (3 sets) should be a mandatory criteria before releasing final payments to contractor.

I / We hereby declare that I / We have read and understood the above instructions for the guidance of Tenderers.

Date:  
Place:

Signature, Seal and address of Contractor



PRODUCED BY AN AUTODESK EDUCATIONAL PRODUCT

PROPOSED INTERNAL LAYOUT PLAN OF RMPC, ASANSOL, FOR  
INDIAN BANK, AT FIRST FLOOR, IN ASANSOL

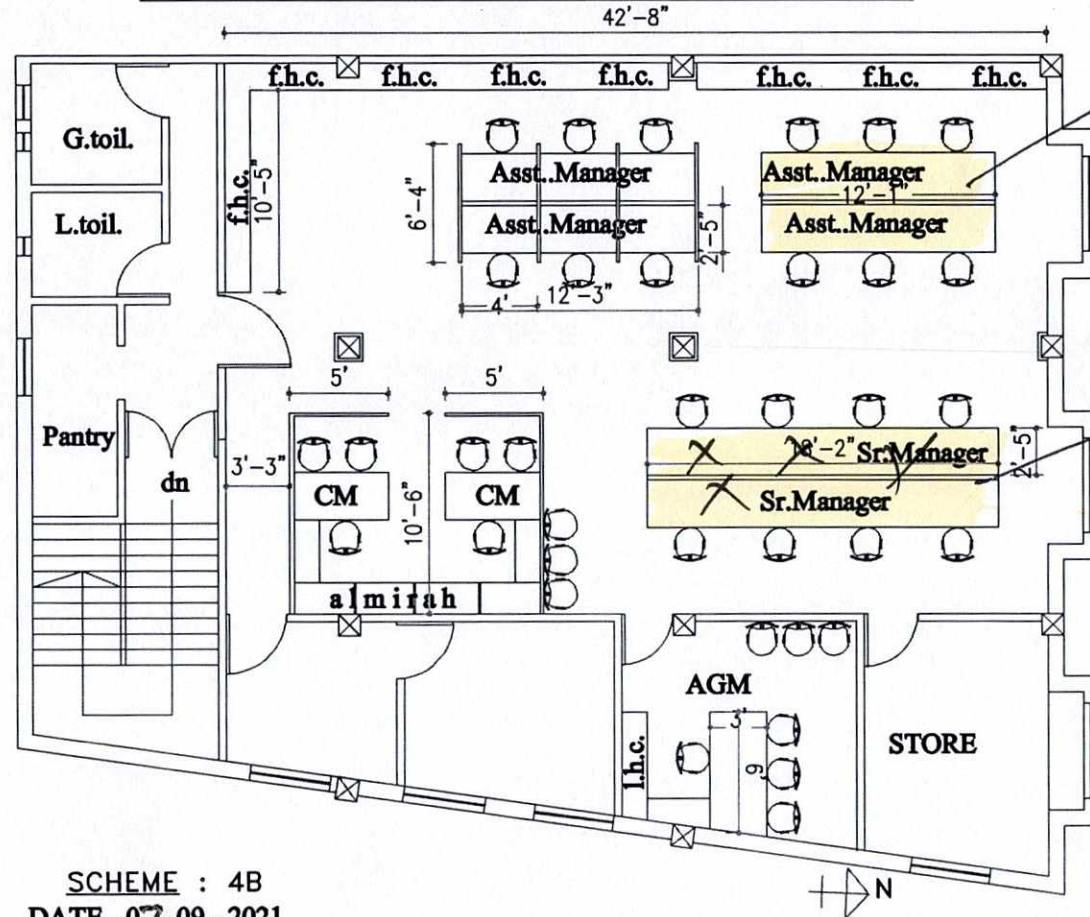

old Furniture of RMPC to be used.

Not in estimate

SCHEME : 4B  
DATE - 07-09-2021

FIRST FLOOR PLAN

ARCHITECT :

**SANJOY PAUL AND ASSOCIATES**  
157/4/1A BAKULBAGAN ROAD, KOLKATA - 25  
HOUSE NO-40, 1st AVENUE, SEPCO TOWNSHIP,  
DURGAPUR-713205

Mob: 9333921690





**SCHEDULE OF SPECIFICATIONS WITH QUANTITIES FOR ELECTRICAL WORKS OF RAMPC,  
ASANSOL FOR INDIAN BANK**

**CONTRACTOR'S RATE**

SL.NO	DESCRIPTION OF ITEMS	UNIT	QTY	RATE	AMOUNT
<b>1</b>	<b>POINT WIRING i/c CIRCUIT WIRING</b>				
a	Wiring for the following light / wall / fan/ exhaust fan, call bell points with 1.5 sqmm PVC insulated stranded Cu conductor wire in concealed / exposed medium grade ISI marked PVC conduits as called for in specification including providing 1 sqmm insulated Cu earth wire including cost of circuit wiring from DB to the point with 2x2.5 sqmm + 1x1.5 sqmm complete with providing and fixing of accessories like saddles, clamps, flexible pipes, dash fasteners etc. modular switches with face plates , switch boxes, grid plates are included in the above rate . The rate shall include the cost of circuit wiring .				
	1. Primary points	nos	14		
	2. Loop points	nos	10		
	3. Primary point (wall and exhaust fan controlled by 1 switch and one 5 Amp. socket )	nos	12		
	The above work includes extensions of points with flexible conduits as reqd. to table bottoms etc. as reqd				
b	Wiring for 5Amp light plug point with 2 x 2.5 sq mm + 1 x 1.5 sqmm PVC single core copper wire in PVC polythene pipe with galvanized iron junction & switch boxes & clip in type, 6 Amp modular type switches, 5Amp socket with all accessories, T&P & as directed by the Engineer-in-charge at counter/table. maximum 6 points per circuit , circuit shall not be paid extra.	nos	8		
c	Wiring of 15 Amp power sockets with switch on separate board with 2x4 sq mm + 1x1.5 sqmm) PVC single core copper wire in PVC/ Super polythene pipe with galvanized iron junction & switch boxes & clip in type 6 Amp modular type switches with all accessories, T&P & as directed by the Engineer-in-charge at counter/table. maximum 6 points per circuit , circuit shall not be paid extra.	nos	8		
d	Wiring of AC points with 20 Amp plug socket with switch on separate board with 2 x 6 sq mm + 1 x 2.5 sqmm PVC single core copper wire in PVC polythene pipe with galvanized iron junction & switch boxes & clip in type 20 Amp modular type switches with all accessories, including providing metal clad socket with SPMCB in sheet steel enclosure T&P & as directed by the Engineer-in-charge . 1 point per circuit ,circuit shall not be paid extra	nos	6		
e	Wiring for UPS power socket with 2 x 2.5sq mm + 1x1.5 sqmm PVC single core copper wire in PVC polythene pipe with galvanized iron junction & switch boxes & clip in type including 3 nos. 5 amp . sockets 1 no. 16 amp. switch. One indicator modular type with grid and face plates modular type.(maximum three stations per circuit .Circuit shall not be paid extra )	nos	24		
e	Concealed conduit wiring to call bell point with one gong bell of 6" dia placed at strategic point with 6 Amp switch bell push clip in type modular type fixed on G.I. boxes placed at skirting level for emergency use, the wiring details are as per Sr .no. 01. The places as located in drawing & as per direction of Engineer-in-charge.	set	1		
<b>2</b>	<b>DISTRIBUTION BOARDS</b>				
	Distribution boards: Design, manufacture, supply, of 1.6 mm th. Sheet steel fabricated surface / recessed mounted, vertical configuration , double door type, distribution boards ( factory made with powder coating )				
<b>A</b>	<b>DB for normal Lighting and Power</b>				
	4 way TPN DB with				
	Incoming :				
	40A 4 Pole MCB				
	Outgoing :	nos	1		
	12 nos SPMCB				



<b>B</b>	<b>DB for Airconditioning</b>				
	4 way TPN DB for AC with				
	Incoming :				
	63A 4 Pole MCB				
	Outgoing :	<b>nos</b>	<b>1</b>		
	12 nos SPMCB				
<b>C</b>	<b>DB for UPS Input</b>				
	4 way TPN DB for AC with				
	Incoming :				
	40 A 4 Pole MCB ---1 no				
	Outgoing :	<b>nos</b>	<b>1</b>		
	60 A DP MCBs ----- 2 nos				
<b>3</b>	<b>UPS Output</b>				
	40A DP MCB in MS box ( for UPS OUT PUT in UPS room )	<b>Set</b>	<b>1</b>		
<b>4</b>	<b>UPS DB</b>				
	Distribution boards 1 No. 60A 2 pole MCB isolator				
	Out going 10 No. 6/10 SP MCB s ( for UPS distribution boards)	<b>set</b>	<b>1</b>		
<b>5</b>	<b>SUB MAINS WIRING</b>				
	Supply of all required materials and wiring to submains with following number and sizes of PVC insulated 1100 volt grade standard copper wire run inside pre-laid PVC conduit pipe of ISI mark as required and copper wire as earth continuity conductor and complete in all respect including making good to all damages caused and as per the direction of Consultant and Engineer-in-charge.				
a	4 x 6 sqmm + 1 x 2.5 sqmm Cu wire general ( for Light and Power DB )	<b>mts</b>	<b>95</b>		
b	4 x 16 sqmm + 1 x 2.5 sqmm Cu wire general ( for AC DB )	<b>mts</b>	<b>75</b>		
c	4 x 10 sqmm + 1 x 4 sqmm Cu wire general ( for UPS supply )	<b>mts</b>	<b>75</b>		
d	2 x 6 sqmm + 1 x 2.5 sqmm Cu wire general ( from UPS room to DB )	<b>mts</b>	<b>50</b>		
e	Supplying and laying 2 x 2.5 sqmm Cu. Wire in PVC conduit from panel to Sign board	<b>mts</b>	<b>30</b>		
<b>6</b>	<b>EARTHING</b>				
a	Providing and fixing of chemical earth electrode made out of 50mm dia class-B Asaha lock or equivalent 2m length with copper plate made out of 600 x 600 x 3.15 mm tinned copper plate along electrode with one number 40x5mm tinned copper strip grazed with the plate buried vertically with top edge of the plate at a depth of 1500 mm with arrangements for termination of copper strip of earth continuity conductor including cost of charcol, saltoreign soil, water pouring arrangements brick massionry encloser on top with R.C.C cover complete with labour and material as per direction of Engineer-in-charge as per IS:3043 1987 ( for UPS )	<b>set</b>	<b>1</b>		
b	do as above with 600 mm x 600 mm x 6mm th. G.I plate ) for MAIN PANEL )	<b>set</b>	<b>1</b>		



<b>7</b>	<b>EARTH STRIPS / WIRES</b>				
	Supply, installation, effecting proper connection , testing, and commisioning of the following size CU. / G.I earth strip / wire or in recess as reqd.				
a	25 mm x 3 mm copper earth strip	rmt	15		
b	10 sqmm insulated Cu. Earth wire in PVC conduit pipe (for UPS)	rmt	15		
c	25 mm x 3 mm G.I earth strip	rmt	15		
d	8 mm dia G.I earth wire	rmt	15		
<b>8</b>	Supply of all required materials and wiring to AC plug point with 2 x 6 sqmm+ 1x 2.5sqmm PVC insulated copper wire run inside screw type PVC conduit pipe with ISI market laid on surfaced / recessed of wall / ceiling with PVC insulated copper wire as earth continuity conductor complete in all respect including with use of 2.0 TR AC starter, concealed metal boxes with cover, wire, 25A SPN metal clad plug socket, metallic switch box for plug, junction box etc complete with making good the damages caused as required and as per direction of Engineer in charge. ( for Branch )	nos	6		
<b>9</b>	<b>FITTINGS AND FIXTURES</b>				
a	Supply,installation and testing of recess LED lights fittings ( 40 Watt) of square type - 2' x 2' . with all accessories complete of Philips / Havells make as required as per direction of Engineer in charge.	nos	14		
b	Supply,installation and testing of recess LED light fittings Nos. (10 watt) of round type -6" dia with all accessories complete of Philips /Crompton/ Wipro make as required as per direction of Engineer in charge.	nos	8		
c	Supply,installation and testing of single tube lights T5 patty Nos fittings (36 watt ) -LED type of surface mounting with all accessories complete of Philips/Crompton / Wipro make as required as per direction of Engineer in charge.	nos	6		
d	Providing and fitting of 450 mm sweep Wall mounted fan of approved make .	nos	8		
e	Providing and fitting of 1200 mm sweep celing fan of approved make .	nos	1		
f	Providing and fitting of 400 mm sweep cabin fan of approved make .	nos	2		
g	Providing and fitting of 400 mm sweep Exhaust fan of approved make .	nos	3		
h	Providing and fitting of call bell of approved make .	nos	1		
i	Providing and fitting LED Batten Light -2' length for cash Toilet --8W	nos	3		
j	Providing and fitting of modular fan regulator of approved make .	nos	1		
<b>10</b>	<b>PHONE WIRING .</b>				
a	Wiring for telephone points with 2 pair 4/5 pair 51mm dia ATC (annealed tinned Cu wire ) with pvc insulated PVC sheathed telephone cable from tag block to the point including providing ferrules at both ends and termination at both ends including providing RJ 11 outlet , faceplate and mounting box, complete of modular type (where 2 such points are shown , 2 such wires to be provided ).This work includes providing PVC conduits in chases from the raceway to the point .	nos	2		
b	Supplying, laying, effecting ,terminations, testing and commissioning of 0.51mm dia Cu conductor, twisted, colour coded with polythene capor barrier, telephone cables in the existing tray as reqd. from building tag block to the floor as reqd.				
b i	1x10 paired armoured cable for P&T connections	rmt	45		
b ii.	Supply and fixing 20 pair krone tag block with enclosure	nos	2		



<b>11</b>	<b>MAIN PANEL BOARD</b>				
<b>a</b>	Supply, delivery, installation , testing , commissioning , of L&T indoor wall floor mounted type distribution boards made out of 2 mm thk. CR sheet metal duely acid treated premised & painted with 2 coats of enamel paint compartment arrangement for each equipment & bus bar chamber on the top of the panel running horizontal through out its length duly lamp , vermin proof having provision cable by conduit entry , earthing stud as per specification mentioned below duly factory wired confirming to the relevant ISS & as per special condition of contract , making good the damages M.S. Cubical type Panel board should have hinged door at the front. The panel shall be provided with all accessories & following arrangements complete in all respect & direction of EIC (before fabrication of panel board drawing is to be approved by Engineer-in-charge).	<b>set</b>	<b>1</b>		
	<b>Incoming-</b>				
	160Amp TP MCCB --1 no				
	0-500V CTs --3 nos				
	3 nos. indication lamps with 3 fuses --1 set				
	200A 4P copper bus bar ---1 set				
	100A 4P copper bus bar ---1 set				
	125A - 4P MCCB for ATM --- 1 SET				
	125A -4P MCCB for AC --- 1 SET				
	1No 125A- HRC FSU.with rewirable fuse links for generator				
	<b>Outgoing -</b>				
	100A 4P COS --2nos				
	63A 4P MCB ---6 nos				
	63A DP MCB ---6 nos				
	<b>Outgoing- 4 Nos 32A DP MCB for A.C</b>				
	2Nos 63 A TPN MCB for A.T.M				
	2Nos 63 A DP MCB for U.P.S incomer and outgoing				
	2 Nos 40 A DP MCB for LDB/PDB 40A DP MCB Spare				
	2Nos 32 A DP MCB for Glow sign board( <b>Branch + ATM</b> )				
	1No. VAF Digital meter with CT.				
<b>b</b>	<b>SWITCH NEAR METER</b>				
	Providing and fixing 200Amp MCCB in 16 gauge sheet cubicle box. of L/T DH - 200 25KA (near meter ) completev with incoming and outgoing connections.	<b>set</b>	<b>1</b>		
<b>12</b>	<b>TIMER</b>				
	Supply & installation of Timer Box for Glow sign Supply comprising of the following :	<b>set</b>	<b>1</b>		
	2 no SP MCB				
	2 Nos 25A rated Contactor				
	2 no 24 Hours Timer				
<b>13</b>	Supply and erection of earth bus on wall ( min. length 0.3 mtr.) on insulator with drilled holes on the bus with GI bolt , nut , washer etc for the following:-				
	With (25x3) mm CU flat	<b>each</b>	<b>2</b>		
<b>14</b>	Supply & installation of 2 nos. 32A DP Changeover switch to be fixed and complete with one no.60A rated copper Bus bar for changing supply from one UPS to another with all accessories.	<b>set</b>	<b>2</b>		
<b>15</b>	Marking of all DB's & Main switches' Change over and power outlet points	<b>job</b>	<b>1</b>		



16	<b>DISTRIBUTION CABLE</b>					
A	Supply & lay 1.1 KV grade PVCA AL cable on wall having MS /HDP pipe protection near floor level and clamping as required for the following:-					
a	35 Sq mm 4 core Al with 2 nos 10 SWG GI wire-MAIN CABLE	35	Mtr			
b	16 Sq mm 4 core Al with 2 nos 10 SWG GI wire ---CABLE for generator	25	Mtr			
d	2.5 sq mm 2 core CU for UPS Plate Earthing	25	Mtr			
e	2 nos. 35 sq. mm. CU flexible wire through GI flexible pipe complete with end termination with CU sockets. ( Meter loop connection with Main SFU & Busbar)	10	Mtr			
B	Making end termination of 1.1 KV grade PVCA Al cable with supply of cable end box , brass Gland, CU crimping socket & jointing materials as required for the following:-					
a	35 Sq mm 4 core Al	2	Each			
b	16 Sq mm 4 core Al	2	Each			
17	At the end of the work to submit circuit diagram with with Electrical Audit report to be signed by an by an electrical engineer having valid registration no.	L.S	L.S			
18	<b>COMPUTER LAN</b>					
a	Supply,installaation of rigid PVC conduit accessories bent flexible conduit etc and fixing by PVC bar saddle on wall or wooden surface	135	mt			
b	Supply ,installation of UTP cable in prelaidd PVC conduit	135	mt			
c	Supply,installation of UTP cable patch chord 2 mts. Long including termination and socketing	24	Each			
d	Supply and fixing of RJ-45 UTP formation outlet -Cat-6e (1 module ) with front cover plastic /flush metal box on surface of wall	24	Each			
e	Supply and installation of Cat-6-24 port patch panel	1	each			
f	Supply and installation of UTP cable patch chord 1 mt including terminating and socketing Digi Link	24	Each			
			TOTAL			
( Rupees						
GST EXTRA AS PER GOVT. NORMS ----- 18%						



**LIST OF MATERIAL OF APPROVED BRAND/MANUFACTURER  
FOR ELECTRICAL WORKS FOR INDIAN BANK BRANCHES**

SWITCH FUSE	HPL / HAVELLS
CHANGE OVER SWITCH	HPL / HAVELLS
MCCB / MCB / MCI	LEGRAND (LEXIC) / HPL (MOELLER)
RCCB / RCBO	LEGRAND (LEXIC) / HPL (MOELLER)
MCB DB BOX	LEGRAND (LEXIC) / HPL (MOELLER)
CABLE	POLYCAB / FINOLEX
CABLE SOCKET	DOWELL'S / 3D
PVC PIPE & ACESSORIES (MEDIUM)	POLYCAB / HARSH
WIRE (FRLS)	RR / POLYCAB / HAVELLS
MODULAR ACESSORIES	CRABTREE (AHTENA) / LEGRAND (MOSAIC)
MINI STARTER	GETRON / ELECTRON
FAN	CROMPTON / HAVELLS
LIGHT FITTING	PHILIPS / THORN
TELEPHONE WIRE	RR / POLYCAB
NETWORKING SWITCH	IBALL / DELINK
JACK PANEL	IBALL / DELINK
RACK	VALRACK / EPI
CABLE MANAGER	IBALL / DELINK
LAN CABLE	IBALL / DELINK
INFO. OUTLET	IBALL / DELINK
PATCH CORD	IBALL / DELINK
<b>Note: First make should be used. If first make not available then second make may be used with prior approval of Architect / Consultant</b>	